

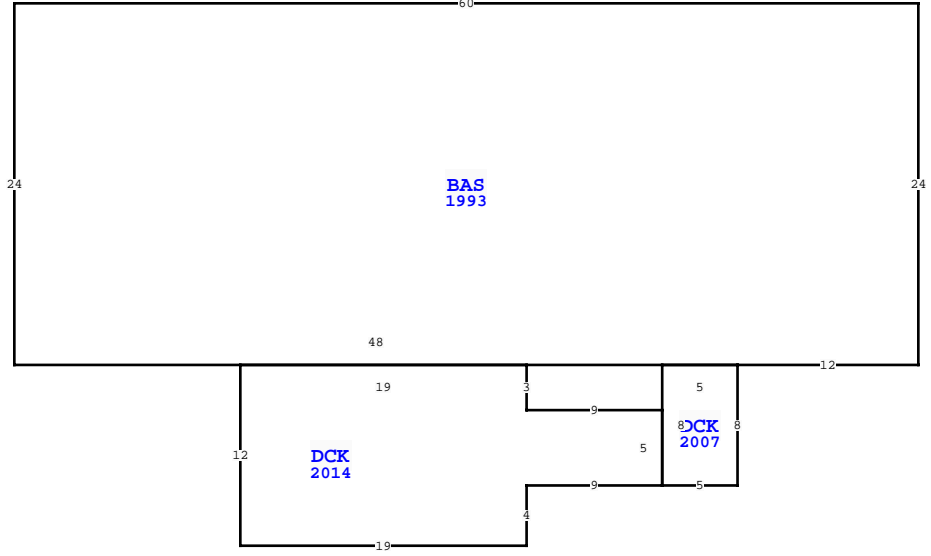

BUILDING CHARACTERISTICS					
ELEMENT	CD	CONSTRUCTION			
Foundation	01	WOOD FRAME 100			
Frame	30	WOOD FRAME 100			
Exterior Wall	02	VINYL 100			
Roof Structur	03	GABLE/HIP 100			
Roof Cover	03	COMP SHNGL 100			
Interior Wall	04	PLYWOOD 50			
Interior Wall	05	DRYWALL 50			
Interior Floo	08	SHT VINYL 50			
Interior Floo	14	CARPET 50			
Heating Type	04	AIR DUCTED 100			
Air Condition	03	CENTRAL 100			
Bedrooms		4 100			
Bathrooms		2 100			
Stories	1.	1. 100			
Class	00	N/A 100			
Units		0 100			
Quality	03	AVERAGE			
DOR CODE	0200	MOBILE HOME			
MAP NUM	5	MKT AREA	08		
NEIGHBORHOOD/LOC	000	1.00/			
AREA TYPE	TOTAL GROSS AREA	PCT OF BASE	YEAR	TOT ADJ AREA	SUBAREA MARKET VALUE
BAS	1,440	100	1993	1,440	47,678
DCK	40	10	2007	4	132
DCK	273	10	2014	27	894
TOTALS	1,753			1,471	48,705

MARKET ADJUSTMENTS											
TYPE	MDL	EFF. AREA	TOT ADJ PTS	EFF. BASE RATE	REPL. COST NEW	AYB	EYB	ECON	FNCT	NORM	% COND
1	MOBILE HOM	100% - 0		75.25	110,693	1985	1987	0	0	56.00	44.00
			Heated Area: 1440			HX Base Yr					



WAKULLA COUNTY PROPERTY			
VALUATION SUMMARY			PAGE 1 of 2
VALUATION BY		STANDARD	
Tax Group: 3		Tax Dist:	
BUILDING MARKET VALUE		48,705	
TOTAL MARKET OB/XF VALUE		15,197	
TOTAL LAND VALUE - MARKET		50,250	
TOTAL MARKET VALUE		114,152	
SOH/AGL Deduction		54,278	
ASSESSED VALUE		59,874	
TOTAL EXEMPTION VALUE		HX HB 34,874	
BASE TAXABLE VALUE		25,000	
TOTAL JUST VALUE		114,152	
NCON VALUE		0	
INCOME VALUE		0	
PREVIOUS YEAR MKT VALUE		103,517	
PU XFOBS.			
MM 5 YR CK, ADJ EYB 1985-1987 NEW HVAC,			
5 YR PRCL CH, PU XFOB LN 12-13			
DEL XFOB LN 12			
PERMIT NUM	DESCRIPTION	AMT	ISSUED
17000694	CARPORT-CO	0	05/31/2017
16000830	STORAGE SHED-CO	0	08/23/2016
201026	LAWN STORAGE	0	01/14/2010
200864	REROOF	0	01/25/2008
028161	SWMH	0	08/31/2001
026630	SIDING	0	06/06/2000

SALES DATA						
OFF RECORD Number	DATE	TYPE INST	Q U	V I	RSN CD	SALE PRICE
0133/0046	8/06/1987	WD	U	V		100

EXTRA FEATURES																
L N	OB/XF CODE	DESCRIPTION	BLD CAP	L	W	UNITS	UT	Adj R	ADJ UNIT PRICE	ORIG COND	YEAR ON	YEAR ACTUAL	Q	% COND	OB/XF MKT VALUE	NOTES
1	0130	FIRE PLACE	0	100	0	1.00	UT	1,300.00	1,300.00	100	1985	1985	3	35	455	
2	0900	MH SITE	0	100	0	1.00	UT	5,000.00	5,000.00	100	2002	2002	3	100	5,000	
3	0620	WOOD UTL B	0	100	25	250.00	SF	6.00	6.00	100	2002	2002	3	20	300	
4	0810	UNFINISH S	0	100	16	192.00	SF	19.00	19.00	100	2002	2002	3	59	2,152	
5	0210	CONCRETE D	0	100	0	588.00	SF	6.00	6.00	100	2002	2002	3	20	706	
6	0210	CONCRETE D	0	100	28	672.00	SF	6.00	6.00	100	2004	2004	3	23	927	
7	0211	CONCRETE W	0	100	20	80.00	SF	6.00	6.00	100	2004	2004	3	23	110	
8	0955	PRIVACY FE	0	100	0	42.00	LF	15.00	15.00	100	2004	2004	3	10	63	
9	0700	PORT BLDG	0	100	10	100.00	SF	8.00	8.00	100	1987	1987	3	44	352	
10	0700	PORT BLDG	0	100	30	360.00	SF	8.00	8.00	100	2010	2010	3	74	2,131	

TOTAL OB/XF											
12,196											
BLD DATE	08/15/2017	MMSR	LGL DATE	08/15/2017	MMSR						
XF DATE	08/15/2017	MMSR	LAND DATE	08/15/2017	MMSR						
INC DATE			AG DATE								

BUILDING NOTES											

BUILDING DIMENSIONS											
BAS=[YR=1993] W60 S24 E48 DCK=[YR=2007] W5 S8 DCK=[YR=2014] N5 W9 N3 W19 S12 E19 N4 E9\$ E5 N8\$ E12 N24\$.											

LAND DESCRIPTION												TOTAL OB/XF												
L N	USE CODE	CLS	LAND USE DESCRIPTION	CAP	R D	LOC ZONE	FRONT	DEPTH	TOT LND UTS	UNIT TYPE	D T	DPH FACT	% COND	TOT ADJ	UNIT PRICE	ADJ UNIT PRICE	LAND VALUE	OTHER ADJUSTMENTS AND NOTES	YEAR	DENSITY	DECL	FRZ	YR	CONSRV
1	000201	C	MH	100			0.00	0.00	6.70	AC		1.00	1.00	1.00	7,500.00	7,500.00	50,250							

