

| BUILDING CHARACTERISTICS | | |
|--------------------------|------------------|----------------|
| ELEMENT | CD | CONSTRUCTION |
| Foundation | 02 | CONCR SLAB 100 |
| Frame | 03 | MASONRY 100 |
| Exterior Wall | 15 | CONC BLOCK 100 |
| Roof Structur | 03 | GABLE/HIP 100 |
| Roof Cover | 03 | COMP SHNGL 100 |
| Interior Wall | 05 | DRYWALL 100 |
| Interior Floo | 14 | CARPET 100 |
| Heating Type | 02 | CONVECTION 100 |
| Air Condition | 02 | WINDOW 100 |
| Bedrooms | | 3 100 |
| Bathrooms | | 1 100 |
| Story Height | | 0 100 |
| Stories | 1. | 1. 100 |
| Units | | 0 100 |
| Quality | 03 | AVERAGE |
| DOR CODE | 0100 | SINGLE FAMILY |
| MAP NUM | 1 | MKT AREA 10 |
| NEIGHBORHOOD/LOC | 000 | 1.00/ |
| AREA TYPE | TOTAL GROSS AREA | PCT OF BASE |
| BAS | 1,160 | 100 |
| FCP | 252 | 25 |
| FOP | 72 | 30 |
| FST | 84 | 55 |
| PTO | 180 | 5 |
| TOTALS | 1,748 | |

| MARKET ADJUSTMENTS | | | | | | | | | | | |
|--|-----|-----------|-------------|----------------|----------------|------|------|------|------|-------|--------|
| TYPE | MDL | EFF. AREA | TOT ADJ PTS | EFF. BASE RATE | REPL. COST NEW | AYB | EYB | ECON | FNCT | NORM | % COND |
| 0100 | 01 | 1,300 | 102.0500 | 96.95 | 126,035 | 1979 | 1983 | 0 | 0 | 40.00 | 60.00 |
| 1 SINGLE FAM 100% - 0 Heated Area: 1160 HX Base Yr | | | | | | | | | | | |

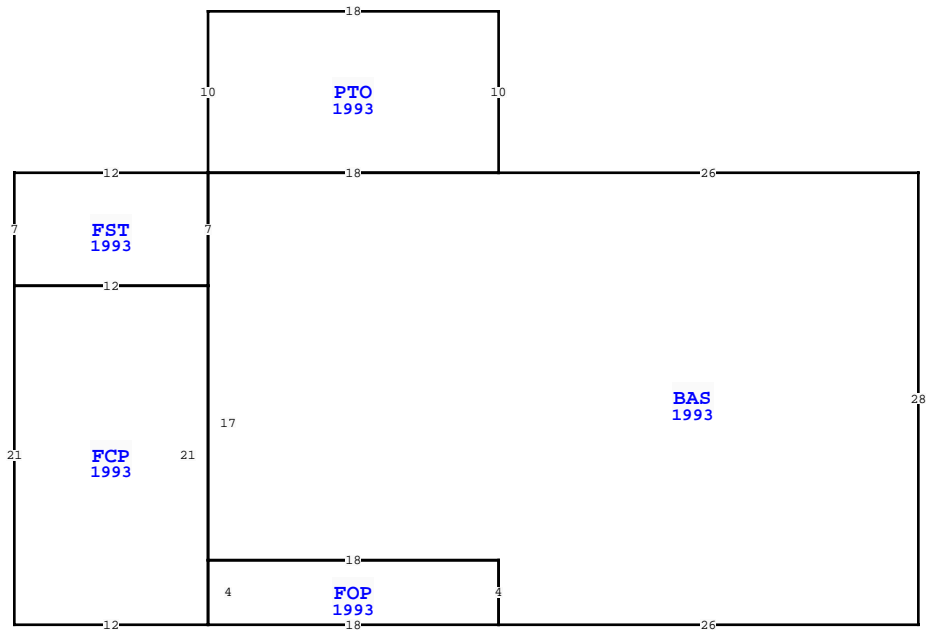

| WAKULLA COUNTY PROPERTY | | | |
|---|-------------|-----------|---------------------------|
| VALUATION SUMMARY | | | PAGE 1 of 1 |
| VALUATION BY | | | STANDARD |
| Tax Group: 3 | Tax Dist: | | |
| BUILDING MARKET VALUE | | | 75,621 |
| TOTAL MARKET OB/XF VALUE | | | 610 |
| TOTAL LAND VALUE - MARKET | | | 7,500 |
| TOTAL MARKET VALUE | | | 83,731 |
| SOH/AGL Deduction | | | 33,326 |
| ASSESSED VALUE | | | 50,405 |
| TOTAL EXEMPTION VALUE | HX HB | | 25,405 |
| BASE TAXABLE VALUE | | | 25,000 |
| TOTAL JUST VALUE | | | 83,731 |
| NCON VALUE | | | 0 |
| INCOME VALUE | | | |
| PREVIOUS YEAR MKT VALUE | | | 84,878 |
| 5YR CK NC FR | | | |
| INCR EYB 1979-1983 PRMT OB21-000223 | | | |
| 5 YR PRCL CK, PU XFOB LN 4. | | | |
| TRAV | | | |
| PERMIT NUM | DESCRIPTION | AMT | ISSUED |
| 21000223 | RE-ROOF-CO | 0 | 04/29/2021 |
| SALES DATA | | | |
| OFF RECORD Number | DATE | TYPE INST | Q / V / RSN CD SALE PRICE |
| BUILDING NOTES | | | |
| BUILDING DIMENSIONS | | | |
| BAS=[YR=1993] W26 PTO=[YR=1993] N10 W18 S10 E18\$ W18 FST=[YR=1993] W12 S7 E12 N7\$ S7 FCP=[YR=1993] W12 S21 E12 N21\$ S17 FOP=[YR=1993] S4 E18 N4 W18 \$ E18 S4 E26 N28\$. | | | |

| EXTRA FEATURES | | | | | | | | | | | | | | | | |
|----------------|------------|-------------|---------|-----|----|-------|----|-------|----------------|-----------|---------|-------------|---|--------|-----------------|-------|
| L N | OB/XF CODE | DESCRIPTION | BLD CAP | L | W | UNITS | UT | Adj R | ADJ UNIT PRICE | ORIG COND | YEAR ON | YEAR ACTUAL | Q | % COND | OB/XF MKT VALUE | NOTES |
| 1 | 0700 | PORT BLDG | 0 | 100 | 8 | 12 | | | 8.00 | 100 | 1979 | 1979 | 3 | 20 | 154 | |
| 2 | 0210 | CONCRETE D | 0 | 100 | 10 | 15 | | | 6.00 | 100 | 1993 | 1993 | 3 | 20 | 180 | |
| 3 | 0700 | PORT BLDG | 0 | 100 | 6 | 8 | | | 8.00 | 100 | 2009 | 2009 | 3 | 72 | 276 | |
| 4 | 0580 | FRTBLE GRN | 0 | 100 | 10 | 10 | | | 0.00 | 100 | 2014 | 2014 | 3 | 62 | 0 | |

| LAND DESCRIPTION | | | | | | | | | | | | | | | TOTAL OB/XF | | | | | | | | | |
|------------------|----------|-----|----------------------|-----|-----|----------|-------|-------|-------------|-----------|-----|----------|--------|---------|-------------|----------------|------------|-----------------------------|------|---------|------|-----|----|--------|
| L N | USE CODE | CLS | LAND USE DESCRIPTION | CAP | R D | LOC ZONE | FRONT | DEPTH | TOT LND UTS | UNIT TYPE | D T | DPH FACT | % COND | TOT ADJ | UNIT PRICE | ADJ UNIT PRICE | LAND VALUE | OTHER ADJUSTMENTS AND NOTES | YEAR | DENSITY | DECL | FRZ | YR | CONSRV |
| 1 | 000100 | C | SFR | 100 | | | 0.00 | 0.00 | 1.00 | AC | | 1.00 | 1.00 | 1.00 | 7,500.00 | 7,500.00 | 7,500 | | | | | | | |