

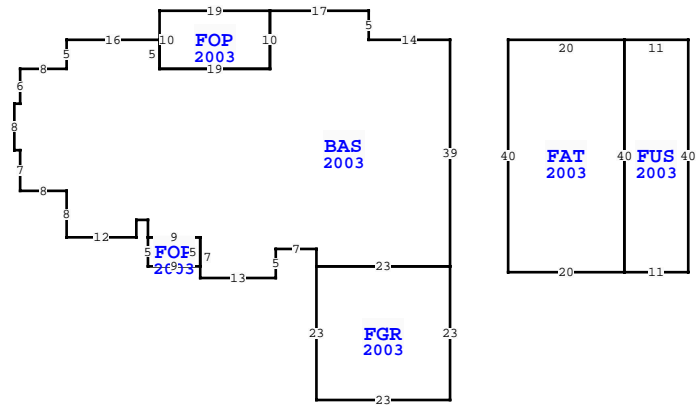

| ELEMENT | | CD | CONSTRUCTION | | |
|------------------|------------------|---------------|--------------|--------------|----------------------|
| Foundation | 02 | CONCR | SLAB | 100 | |
| Frame | 02 | WOOD | FRAME | 100 | |
| Exterior Wall | 19 | COMMON | BRK | 100 | |
| Roof Structur | 03 | GABLE/HIP | | 100 | |
| Roof Cover | 03 | COMP | SHNGL | 100 | |
| Interior Wall | 05 | DRYWALL | | 100 | |
| Interior Floo | 11 | CLAY | TILE | 50 | |
| Interior Floo | 12 | HARDWOOD | | 50 | |
| Heating Type | 04 | AIR | DUCTED | 100 | |
| Air Condition | 03 | CENTRAL | | 100 | |
| Bedrooms | 4 100 | | | | |
| Bathrooms | 3 100 | | | | |
| Story Height | 0 100 | | | | |
| Stories | 2. 100 | | | | |
| Units | 0 100 | | | | |
| Quality | 04 | ABOVE AVERAGE | | | |
| DOR CODE | 0100 | SINGLE FAMILY | | | |
| MAP NUM | 2 | MKT AREA | 10 | | |
| NEIGHBORHOOD/LOC | 202.00 | 1.00/ | | | |
| AREA TYPE | TOTAL GROSS AREA | PCT OF BASE | YEAR | TOT ADJ AREA | SUBAREA MARKET VALUE |
| BAS | 2,624 | 100 | 2003 | 2,624 | 318,869 |
| FAT | 800 | 20 | 2003 | 160 | 19,443 |
| FGR | 529 | 50 | 2003 | 264 | 32,082 |
| FOP | 45 | 30 | 2003 | 14 | 1,702 |
| FOP | 190 | 30 | 2003 | 57 | 6,926 |
| FUS | 440 | 100 | 2003 | 440 | 53,469 |
| UDS | 100 | 60 | 2003 | 60 | 7,291 |
| TOTALS | 4,728 | | | 3,619 | 439,781 |

| MARKET ADJUSTMENTS | | | | | | | | | | | | |
|--------------------|------------|-----------|-------------|----------------|----------------|------|------|------|------|-------|--------|--|
| TYPE | MDL | EFF. AREA | TOT ADJ PTS | EFF. BASE RATE | REPL. COST NEW | AYB | EYB | ECON | FNCT | NORM | % COND | |
| 1 | SINGLE FAM | 100% | - 2004 | | 549,726 | 2003 | 2003 | 0 | 0 | 20.00 | 80.00 | |
| Heated Area: 3064 | | | | | | | | | | | | |
| HX Base Yr 2004 | | | | | | | | | | | | |



| WAKULLA COUNTY PROPERTY | | | | |
|--|-------------------|-----------|----------------|------------|
| VALUATION SUMMARY | | | PAGE 1 of 1 | |
| VALUATION BY | | STANDARD | | |
| Tax Group: 3 | | Tax Dist: | | |
| BUILDING MARKET VALUE | | 439,781 | | |
| TOTAL MARKET OB/XF VALUE | | 29,278 | | |
| TOTAL LAND VALUE - MARKET | | 70,000 | | |
| TOTAL MARKET VALUE | | 539,059 | | |
| SOH/AGL Deduction | | 192,992 | | |
| ASSESSED VALUE | | 346,067 | | |
| TOTAL EXEMPTION VALUE | | 50,000 | | |
| BASE TAXABLE VALUE | | 296,067 | | |
| TOTAL JUST VALUE | | 539,059 | | |
| NCON VALUE | | 8,900 | | |
| INCOME VALUE | | | | |
| PREVIOUS YEAR MKT VALUE | | 536,491 | | |
| PRMT GENERATOR | | | | |
| 5 YR PRCL CK NC JS | | | | |
| 5 YR PRCL CK, PU XFOB LN 6. | | | | |
| 5 YR PRCL CH, PU FNDN & FRME, PU XFOB LN 5 | | | | |
| PERMIT NUM | DESCRIPTION | AMT | ISSUED | |
| OB24-000447 | RE-ROOF/SHINGLES- | | 06/20/2024 | |
| 23000294 | GENERATOR PRMT CC | 0 | 04/06/2023 | |
| 17000198 | ELECTRIC | 0 | 02/13/2017 | |
| 29332 | SFD | 0 | 08/09/2002 | |
| 29332 | SFD | 0 | 08/09/2002 | |
| 027849 | ELEC | 0 | 06/01/2001 | |
| SALES DATA | | | | |
| OFF RECORD Number | DATE | TYPE INST | Q / V / RSN CD | SALE PRICE |
| 0360/0541 | 8/18/1999 | WD Q | V | 34,900 |
| GRANTOR: CAMP BRYAN L & SUZANN | | | | |
| GRANTEE: | | | | |
| BUILDING NOTES | | | | |
| BUILDING DIMENSIONS | | | | |
| BAS=[YR=2003] W14 N5 W17 FOP=[YR=2003] W19 S10 E19 N10 \$ S10 W19 N5 W16 S5 W8 S6 W1 S8 E1 S7 E8 S8 E12 N3 E2 S3 FOP=[YR=2003] S5 E9 N5 W9 \$ E9 S7 E13 N5 E7 S3 FGR=[YR=2003] S23 E23 N23 W23 \$ E23 N39 \$ PTR=[YR=2003] E10 FAT=[YR=2003] S40 E20 FUS=[YR=2003] E11 N40 W11 S40 \$ N40 W20 \$ W10 \$ PTR=[YR=2003] E40 N40 UDS=[YR=2003] E10 N10 W10 S10 \$ S40 W40 \$. | | | | |

| EXTRA FEATURES | | | | | | | | | | | | | | | | |
|----------------|------------|-------------|---------|-----|----|-------|----|----------|----------------|-----------|---------|-------------|---|--------|-----------------|-------|
| L N | OB/XF CODE | DESCRIPTION | BLD CAP | L | W | UNITS | UT | Adj R | ADJ UNIT PRICE | ORIG COND | YEAR ON | YEAR ACTUAL | Q | % COND | OB/XF MKT VALUE | NOTES |
| 1 | 0250 | ASPHALT AV | 0 | 100 | 11 | 230 | | 2.00 | 2.00 | 100 | 2003 | 2003 | 3 | 21 | 1,063 | |
| 2 | 0700 | PORT BLDG | 0 | 100 | 12 | 12 | SF | 8.00 | 8.00 | 100 | 2003 | 2003 | 3 | 60 | 691 | |
| 3 | 0211 | CONCRETE W | 0 | 100 | 60 | 3 | SF | 6.00 | 6.00 | 100 | 2004 | 2004 | 3 | 23 | 248 | |
| 4 | 0955 | PRIVACY FE | 0 | 100 | 0 | 0 | LF | 15.00 | 15.00 | 100 | 2004 | 2004 | 3 | 10 | 48 | |
| 5 | 0620 | WOOD UTL B | 0 | 100 | 8 | 8 | SF | 6.00 | 6.00 | 100 | 2004 | 2004 | 3 | 23 | 88 | |
| 6 | 0025 | BARN, POLE | 0 | 100 | 60 | 32 | SF | 12.50 | 12.50 | 100 | 2017 | 2017 | 3 | 76 | 18,240 | |
| 7 | 0157 | GENERATOR | 0 | 100 | 0 | 0 | UT | 8,900.00 | 8,900.00 | 100 | 2024 | 2023 | | 100 | 8,900 | |

| LAND DESCRIPTION | | | | | | | | | | | | | TOTAL OB/XF | | | | | | | | | | | | |
|------------------|----------|-----|----------------------|-----|-----|----------|-------|-------|-------------|-----------|-----|-----------|-------------|---------|------------|----------------|------------|-----------------------------|------|---------|------|-----|----|--------|--|
| L N | USE CODE | CLS | LAND USE DESCRIPTION | CAP | R D | LOC ZONE | FRONT | DEPTH | TOT LND UTS | UNIT TYPE | D T | DPTH FACT | % COND | TOT ADJ | UNIT PRICE | ADJ UNIT PRICE | LAND VALUE | OTHER ADJUSTMENTS AND NOTES | YEAR | DENSITY | DECL | FRZ | YR | CONSRV | |
| 1 | 000100 | C | SFR | 100 | | | 0.00 | 0.00 | 1.00 | LT | | 1.00 | 1.00 | 1.00 | 70,000.00 | 70,000.00 | 70,000 | | | | | | | | |