

| ELEMENT | | CD | CONSTRUCTION |
|------------------|------------------|---------------|--------------|
| Foundation | 02 | CONCR | SLAB 100 |
| Frame | 02 | WOOD | FRAME 100 |
| Exterior Wall | 05 | HARDIE BRD | 75 |
| Exterior Wall | 11 | AVERAGE | 25 |
| Roof Structur | 03 | GABLE/HIP | 100 |
| Roof Cover | 03 | COMP SHNGL | 100 |
| Interior Wall | 05 | DRYWALL | 100 |
| Interior Floo | 07 | VYL PLANK | 70 |
| Interior Floo | 14 | CARPET | 30 |
| Ceiling | 08 | 8 FT | 100 |
| Heating Type | 13 | HEAT PUMP | 100 |
| Air Condition | 13 | HEAT PUMP | 100 |
| Bedrooms | | 4 | 100 |
| Bathrooms | | 2 | 100 |
| Stories | 1. | 1. | 100 |
| Units | | 0 | 100 |
| Quality | 03 | AVERAGE | |
| DOR CODE | 0100 | SINGLE FAMILY | |
| MAP NUM | 2 | MKT AREA | 10 |
| NEIGHBORHOOD/LOC | 426.00 | 1.00/ | |
| AREA TYPE | TOTAL GROSS AREA | PCT OF BASE | YEAR |
| BAS | 1,768 | 100 | 2023 |
| FGR | 420 | 50 | 2023 |
| FOP | 88 | 30 | 2023 |
| FOP | 127 | 30 | 2023 |
| TOTALS | 2,403 | | |

| MARKET ADJUSTMENTS | | | | | | | | | | | |
|--------------------|------------|-----------|-------------|----------------|-----------------|-----|-----|------|------|------|--------|
| TYPE | MDL | EFF. AREA | TOT ADJ PTS | EFF. BASE RATE | REPL. COST NEW | AYB | EYB | ECON | FNCT | NORM | % COND |
| 1 | SINGLE FAM | 100% | - 2024 | | | | | | | | |
| Heated Area: 1768 | | | | | HX Base Yr 2024 | | | | | | |

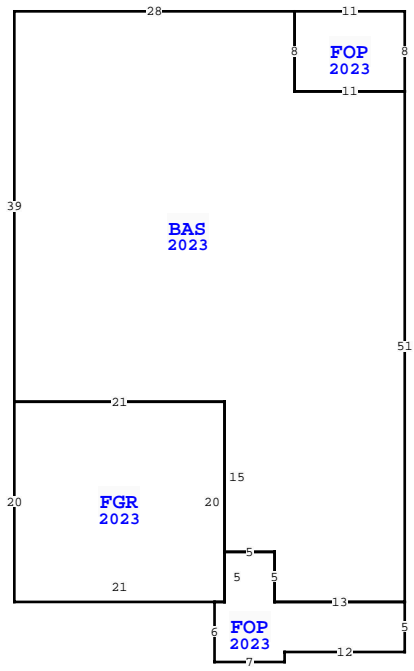

| WAKULLA COUNTY PROPERTY | | | | PAGE 1 of 1 | 3 | |
|---|-------------|-----------|------------|-------------|--------|------------|
| VALUATION BY | | STANDARD | | | | |
| Tax Group: 3 | | Tax Dist: | | | | |
| BUILDING MARKET VALUE | | 220,475 | | | | |
| TOTAL MARKET OB/XF VALUE | | 4,782 | | | | |
| TOTAL LAND VALUE - MARKET | | 57,000 | | | | |
| TOTAL MARKET VALUE | | 282,257 | | | | |
| SOH/AGL Deduction | | 0 | | | | |
| ASSESSED VALUE | | 282,257 | | | | |
| TOTAL EXEMPTION VALUE | | 50,000 | | HX HB | | |
| BASE TAXABLE VALUE | | 232,257 | | | | |
| TOTAL JUST VALUE | | 282,257 | | | | |
| NCON VALUE | | 225,257 | | | | |
| INCOME VALUE | | | | | | |
| PREVIOUS YEAR MKT VALUE | | 57,000 | | | | |
| PRMT CK P/U NEW SFD AND XFOBS | | | | | | |
| 5YR PRCL CK NC | | | | | | |
| PERMIT NUM | DESCRIPTION | AMT | ISSUED | | | |
| 22000987 | SFD-CO | 0 | 11/08/2022 | | | |
| SALES DATA | | | | | | |
| OFF RECORD Number | DATE | TYPE INST | Q U | V I | RSN CD | SALE PRICE |
| 1305/0718 | 3/15/2023 | WD Q | Q | I | 01 | 314,900 |
| GRANTOR: DR HORTON INC | | | | | | |
| GRANTEE: CASELL JASON SCOTT | | | | | | |
| 1268/0658 | 5/31/2022 | WD Q | Q | V | 05 | 5,382,000 |
| GRANTOR: PAFFORD PROPERTIES & | | | | | | |
| GRANTEE: DR HORTON INC | | | | | | |
| BUILDING NOTES | | | | | | |
| BUILDING DIMENSIONS | | | | | | |
| FOP=[YR=2023;ORIG=150,10] W11 S8 E11 N8 \$ | | | | | | |
| BAS=[YR=2023;ORIG=150,18] W11 N8 W28 S39 E21 S15 E5 S5 E13 N51 \$ | | | | | | |
| FGR=[YR=2023;ORIG=132,49] W21 S20 E21 N20 \$ | | | | | | |
| FOP=[YR=2023;ORIG=132,64] S5 W1 S6 E7 N1 E12 N5 W13 N5 W5 \$ | | | | | | |

| EXTRA FEATURES | | | | | | | | | | | | | | | | |
|----------------|------------|-------------|---------|-----|----|-------|----|-------|----------------|-----------|---------|-------------|---|--------|-----------------|-------|
| L N | OB/XF CODE | DESCRIPTION | BLD CAP | L | W | UNITS | UT | Adj R | ADJ UNIT PRICE | ORIG COND | YEAR ON | YEAR ACTUAL | Q | % COND | OB/XF MKT VALUE | NOTES |
| 1 | 0210 | CONCRETE D | 0 | 100 | 48 | 16 | | | 768.00 | 100 | 2024 | 2023 | | 100 | 4,608 | |
| 2 | 0210 | CONCRETE D | 0 | 100 | 9 | 1 | SF | 6.00 | 6.00 | 100 | 2024 | 2023 | | 100 | 54 | |
| 3 | 0211 | CONCRETE W | 0 | 100 | 5 | 4 | SF | 6.00 | 6.00 | 100 | 2024 | 2023 | | 100 | 120 | |

| LAND DESCRIPTION | | | | | | | | | | | | | | | TOTAL OB/XF | | | | | | | | | |
|------------------|----------|-----|----------------------|-----|-----|----------|-------|-------|-------------|-----------|-----|----------|--------|---------|-------------|----------------|------------|-----------------------------|------|---------|------|-----|----|--------|
| L N | USE CODE | CLS | LAND USE DESCRIPTION | CAP | R D | LOC ZONE | FRONT | DEPTH | TOT LND UTS | UNIT TYPE | D T | DPH FACT | % COND | TOT ADJ | UNIT PRICE | ADJ UNIT PRICE | LAND VALUE | OTHER ADJUSTMENTS AND NOTES | YEAR | DENSITY | DECL | FRZ | YR | CONSRV |
| 1 | 000100 | C | SFR | 100 | | | 0.00 | 0.00 | 1.00 | LT | | 1.00 | 1.00 | 1.00 | 57,000.00 | 57,000.00 | 57,000 | | | | | | | |