

RAINBOW ACRES LOT 16
 OR 28 P 102 OR 37 P 129
 OR 131 P 471 OR 198 P 336

ANDERSON ADRON T/WELCH ERICA SKYE
 43 MAYFAIR DR
 CRAWFORDVILLE, FL 32327

2024

18-3S-01W-084-01548-002



| ELEMENT | | BUILDING CHARACTERISTICS | |
|------------------|------------------|--------------------------|------|
| CD | CONSTRUCTION | | |
| 02 | CONCR SLAB 100 | | |
| 30 | WOOD FRAME 100 | | |
| 02 | VINYL 100 | | |
| 03 | GABLE/HIP 100 | | |
| 03 | COMP SHNGL 100 | | |
| 05 | DRYWALL 100 | | |
| 08 | SHT VINYL 50 | | |
| 14 | CARPET 50 | | |
| 04 | AIR DUCTED 100 | | |
| 03 | CENTRAL 100 | | |
| Bedrooms | | 3 100 | |
| Bathrooms | | 2 100 | |
| Story Height | | 0 100 | |
| Stories | | 1. 1. 100 | |
| Units | | 0 100 | |
| Quality | | 03 AVERAGE | |
| DOR CODE | | 0100 SINGLE FAMILY | |
| MAP NUM | | 5 MKT AREA 10 | |
| NEIGHBORHOOD/LOC | | 000 1.00/ | |
| AREA TYPE | TOTAL GROSS AREA | PCT OF BASE | YEAR |
| BAS | 1,314 | 100 | 2007 |
| FOP | 36 | 30 | 2007 |
| FOP | 120 | 30 | 2007 |
| TOTALS | 1,470 | | |

| MARKET ADJUSTMENTS | | | | | | | | | | | |
|--|-----|-----------|-------------|----------------|----------------|------|------|------|------|-------|--------|
| TYPE | MDL | EFF. AREA | TOT ADJ PTS | EFF. BASE RATE | REPL. COST NEW | AYB | EYB | ECON | FNCT | NORM | % COND |
| 0100 | 01 | 1,361 | 109.0000 | 103.55 | 140,932 | 2007 | 2009 | 0 | 0 | 14.00 | 86.00 |
| 2 SINGLE FAM 100% - 2004 Heated Area: 1314 HX Base Yr 2004 | | | | | | | | | | | |

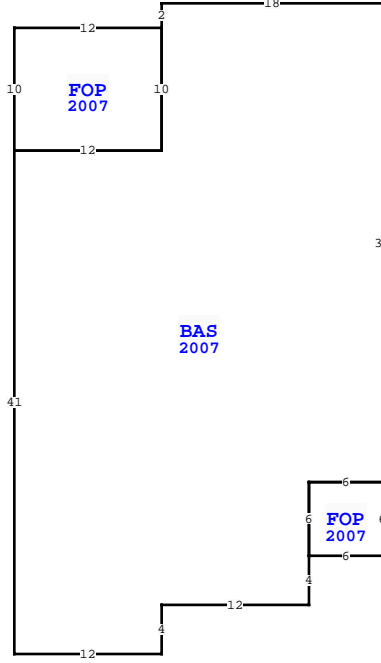

| WAKULLA COUNTY PROPERTY | | | |
|--|-------------------|-------------------|--------------------|
| VALUATION SUMMARY | | | |
| VALUATION BY | | STANDARD | |
| Tax Group: 3 | | Tax Dist: | |
| BUILDING MARKET VALUE | | 121,202 | |
| TOTAL MARKET OB/XF VALUE | | 1,268 | |
| TOTAL LAND VALUE - MARKET | | 30,000 | |
| TOTAL MARKET VALUE | | 152,470 | |
| SOH/AGL Deduction | | 47,655 | |
| ASSESSED VALUE | | 104,815 | |
| TOTAL EXEMPTION VALUE | | HX HB 50,000 | |
| BASE TAXABLE VALUE | | 54,815 | |
| TOTAL JUST VALUE | | 152,470 | |
| NCON VALUE | | 0 | |
| INCOME VALUE | | | |
| PREVIOUS YEAR MKT VALUE | | 141,181 | |
| INCR EYB 2007-2009 HVAC OB23-423 CC 9/20/2023 | | | |
| MM 5YR CK - PU XFOBS | | | |
| 5 YR PRCL CK. DEL XFOB LN 6. PU XFOB LN 4. | | | |
| 5 YR PRCL CH, PU FNDN & FRME, PU XFOB LN 4 | | | |
| PERMIT NUM | DESCRIPTION | AMT | ISSUED |
| OB23-000423 | HVAC CHANGE OUT-C | | 08/23/2023 |
| 2007439 | GAS LINE | 0 | 03/29/2007 |
| 2007234 | SFD-CO | 0 | 02/16/2007 |
| SALES DATA | | | |
| OFF RECORD Number | DATE | TYPE INST | Q U / V I / RSN CD |
| 0435/0788 | 3/01/2002 | WD Q | I |
| GRANTOR: NAZWORTH | | SALE PRICE 35,000 | |
| GRANTEE: ANDERSON | | | |
| BUILDING NOTES | | | |
| BUILDING DIMENSIONS | | | |
| BAS=[YR=2007] W18 S2 FOP=[YR=2007] S10 W12 N10 E12\$ S10 W12 S41 E12 N4 E12 N4 FOP=[YR=2007] E6 N6 W6 S6 \$ N6 E6 N39\$. | | | |

| EXTRA FEATURES | | | | | | | | | | | | | | |
|----------------|------------|-------------|---------|----|----|--------|----|-------|----------------|-----------|---------|-------------|---|--------|
| L N | OB/XF CODE | DESCRIPTION | BLD CAP | L | W | UNITS | UT | Adj R | ADJ UNIT PRICE | ORIG COND | YEAR ON | YEAR ACTUAL | Q | % COND |
| 1 | 0940 | OPEN SHED | 0 100 | 20 | 10 | 200.00 | SF | 4.00 | 4.00 | 100 | 2007 | 2007 | 3 | 30 |
| 2 | 0625 | PORT WD UT | 0 100 | 12 | 10 | 120.00 | SF | 6.00 | 6.00 | 100 | 2005 | 2005 | 3 | 24 |
| 3 | 0940 | OPEN SHED | 0 100 | 12 | 10 | 120.00 | SF | 4.00 | 4.00 | 100 | 2010 | 2010 | 3 | 43 |
| 4 | 0940 | OPEN SHED | 0 100 | 22 | 11 | 242.00 | SF | 4.00 | 4.00 | 100 | 2015 | 2015 | 3 | 67 |
| 5 | 0055 | PORTABLE C | 0 100 | 20 | 18 | 360.00 | SF | 0.00 | 0.00 | 100 | 2020 | 2020 | 3 | 89 |
| 6 | 0055 | PORTABLE C | 0 100 | 20 | 18 | 360.00 | SF | 0.00 | 0.00 | 100 | 2021 | 2021 | 3 | 93 |
| 7 | 0580 | PRTBLE GRN | 0 100 | 6 | 4 | 24.00 | SF | 0.00 | 0.00 | 100 | 2021 | 2021 | 3 | 93 |
| TOTALS | | | | | | | | | | | | | | |

| LAND DESCRIPTION | | | | | | | | | | | | | | |
|-------------------|----------|-----|----------------------|-----|-----|----------|--------|--------|-------------|-----------|-----|----------|--------|---------|
| L N | USE CODE | CLS | LAND USE DESCRIPTION | CAP | R D | LOC ZONE | FRONT | DEPTH | TOT LND UTS | UNIT TYPE | D T | DPH FACT | % COND | TOT ADJ |
| 1 | 000100 | C | SFR | 100 | | | 165.00 | 653.00 | 1.00 | LT | | 1.00 | 1.00 | 1.00 |
| TOTAL OB/XF 1,268 | | | | | | | | | | | | | | |