

RAINBOW ACRES
OR 112 P 347
OR 239 P 708

LOTS 29 & 30
OR 186 P 254
OR 239 P 709

HOUCK TIMOTHY ELLIS/HOUCK REBECCA COTTONGIM
49 OAKLAND DRIVE
CRAWFORDVILLE, FL 32327

2024

18-3S-01W-084-01558-030

| ELEMENT | | CD | | CONSTRUCTION | |
|------------------|------------------|-------------|-------|--------------|----------------------|
| Foundation | 01 | WOOD | FRAME | 100 | |
| Frame | 02 | WOOD | FRAME | 100 | |
| Exterior Wall | 30 | VINYL | | 100 | |
| Roof Structur | 03 | GABLE/HIP | | 100 | |
| Roof Cover | 13 | GALVALUM | | 100 | |
| Interior Wall | 04 | PLYWOOD | | 100 | |
| Interior Floo | 08 | SHT VINYL | | 50 | |
| Interior Floo | 14 | CARPET | | 50 | |
| Heating Type | 04 | AIR DUCTED | | 100 | |
| Air Condition | 03 | CENTRAL | | 100 | |
| Bedrooms | | | | 3 | 100 |
| Bathrooms | | | | 2 | 100 |
| Stories | 1. | | | 1. | 100 |
| Class | 00 | N/A | | 100 | |
| Units | | | | 0 | 100 |
| Quality | 03 | AVERAGE | | | |
| DOR CODE | 0200 | MOBILE HOME | | | |
| MAP NUM | 5 | MKT AREA | | 10 | |
| NEIGHBORHOOD/LOC | 000 | 1.00/ | | | |
| AREA TYPE | TOTAL GROSS AREA | PCT OF BASE | YEAR | TOT ADJ AREA | SUBAREA MARKET VALUE |
| BAS | 1,056 | 100 | 1993 | 1,056 | 32,968 |
| DCK | 140 | 10 | 2003 | 14 | 437 |
| DCK | 40 | 10 | 2016 | 4 | 125 |
| USP | 120 | 50 | 1993 | 60 | 1,873 |
| UST | 60 | 55 | 2016 | 33 | 1,030 |
| TOTALS | 1,416 | | | 1,167 | 36,434 |

| MARKET ADJUSTMENTS | | | | | | | | | | | | |
|-----------------------------------|------------|-----------|-------------|----------------|----------------|--------|------|------|------|------|--------|-------|
| TYPE | MDL | EFF. AREA | TOT ADJ PTS | EFF. BASE RATE | REPL. COST NEW | AYB | EYB | ECON | FNCT | NORM | % COND | |
| 1 | MOBILE HOM | 100% | - 2018 | | 78.05 | 91,084 | 1986 | 1986 | 0 | 0 | 60.00 | 40.00 |
| Heated Area: 1056 HX Base Yr 2018 | | | | | | | | | | | | |

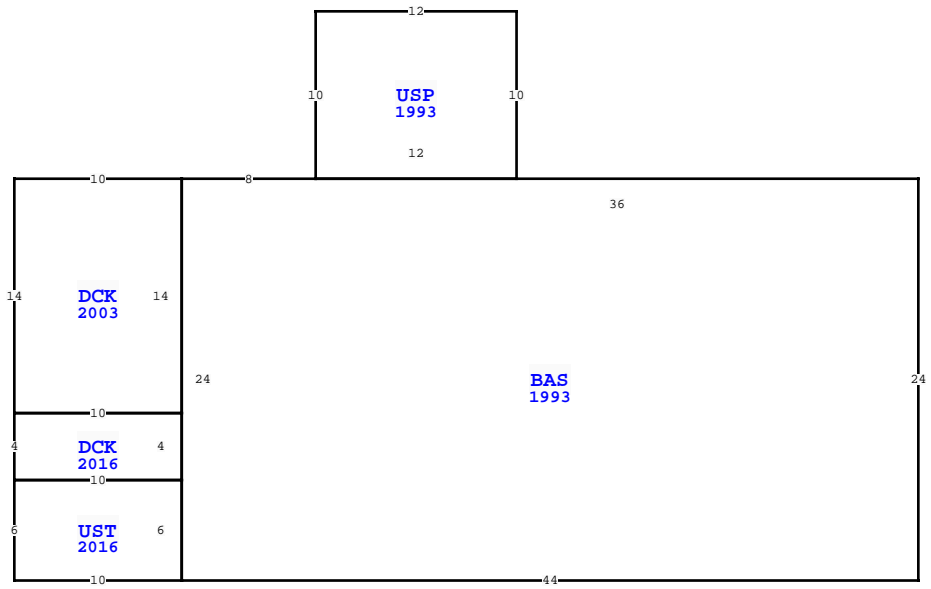

| WAKULLA COUNTY PROPERTY | | | |
|--|-----------------|-----------------|-------------|
| VALUATION SUMMARY | | | PAGE 1 of 1 |
| VALUATION BY | | STANDARD | |
| Tax Group: 3 | | Tax Dist: | |
| BUILDING MARKET VALUE | | 36,434 | |
| TOTAL MARKET OB/XF VALUE | | 4,440 | |
| TOTAL LAND VALUE - MARKET | | 60,000 | |
| TOTAL MARKET VALUE | | 100,874 | |
| SOH/AGL Deduction | | 66,076 | |
| ASSESSED VALUE | | 34,798 | |
| TOTAL EXEMPTION VALUE | | HX HB VX 30,000 | |
| BASE TAXABLE VALUE | | 4,798 | |
| TOTAL JUST VALUE | | 100,874 | |
| NCON VALUE | | 0 | |
| INCOME VALUE | | | |
| PREVIOUS YEAR MKT VALUE | | 76,324 | |
| 5YR CK MM PU XFOB 0940 0950 0625 0060 | | | |
| PU CORR TRAV, CORR RCVR | | | |
| 5 YR PRCL CH, PU XFOB LN 3, DEL XFOB LN 4, | | | |
| 5 YR PRCL CK. PU XFOB LN 3. DEL XFOB LN 5,6. | | | |
| PERMIT NUM | DESCRIPTION | AMT | ISSUED |
| 2008379 | UPGDE ELEC | 0 | 04/29/2008 |
| 2008375 | REPLACE A/C | 0 | 04/28/2008 |
| 20071726 | REROOF-SHINGLES | 0 | 12/12/2007 |
| 31328 | SIDING | 0 | 02/05/2004 |
| 018704 | N/A | 0 | 07/12/1994 |

| SALES DATA | | | | | | |
|--------------------------------|-----------|-----------|-----|-----|--------|------------|
| OFF RECORD Number | DATE | TYPE INST | Q U | V I | RSN CD | SALE PRICE |
| 1160/0246 | 7/17/2020 | QC | U | I | 30 | 100 |
| GRANTOR: HOUCK TIMOTHY ELLIS | | | | | | |
| GRANTEE: HOUCK TIMOTHY ELLIS | | | | | | |
| 1002/0329 | 5/10/2016 | WD | Q | I | 01 | 75,000 |
| GRANTOR: LANE SUSAN HELEN & ST | | | | | | |
| GRANTEE: HOUCK TIM | | | | | | |

| EXTRA FEATURES | | | | | | | | | | | | | | | | |
|----------------|------------|-------------|---------|-----|----|-------|----|-------|----------------|-----------|---------|-------------|---|--------|-----------------|-------|
| L N | OB/XF CODE | DESCRIPTION | BLD CAP | L | W | UNITS | UT | Adj R | ADJ UNIT PRICE | ORIG COND | YEAR ON | YEAR ACTUAL | Q | % COND | OB/XF MKT VALUE | NOTES |
| 1 | 0700 | PORT BLDG | 0 | 100 | 12 | 10 | | | 8.00 | 100 | 2010 | 2010 | 3 | 74 | 710 | |
| 2 | 0030 | BARN, POLE | 0 | 100 | 40 | 36 | | | 9.00 | 100 | 1985 | 1985 | 3 | 20 | 2,592 | |
| 3 | 0940 | OPEN SHED | 0 | 100 | 18 | 8 | | | 4.00 | 100 | 2015 | 2015 | 3 | 67 | 386 | |
| 4 | 0950 | METAL SHED | 0 | 100 | 15 | 8 | | | 8.00 | 100 | 2015 | 2015 | 3 | 67 | 643 | |
| 5 | 0625 | PORT WD UT | 0 | 100 | 16 | 10 | | | 0.00 | 100 | 2017 | 2017 | 3 | 76 | 0 | |
| 6 | 0060 | DECK WOOD | 0 | 100 | 8 | 3 | | | 5.00 | 100 | 2017 | 2017 | 3 | 91 | 109 | |
| TOTALS | | | | | | | | | | | | | | | 4,440 | |

| LAND DESCRIPTION | | | | | | | | | | | | | | | | | | | | | | | | |
|------------------|----------|-----|----------------------|-----|-----|----------|--------|--------|-------------|-----------|-----|----------|--------|---------|------------|----------------|------------|-----------------------------|------|---------|------|-----|----|--------|
| L N | USE CODE | CLS | LAND USE DESCRIPTION | CAP | R D | LOC ZONE | FRONT | DEPTH | TOT LND UTS | UNIT TYPE | D T | DPH FACT | % COND | TOT ADJ | UNIT PRICE | ADJ UNIT PRICE | LAND VALUE | OTHER ADJUSTMENTS AND NOTES | YEAR | DENSITY | DECL | FRZ | YR | CONSRV |
| 1 | 000201 | C | MH | 100 | | | 165.00 | 634.00 | 2.00 | LT | | 1.00 | 1.00 | 1.00 | 30,000.00 | 30,000.00 | 60,000 | | | | | | | |