

BUILDING CHARACTERISTICS		CONSTRUCTION	
ELEMENT	CD		
Foundation	01	WOOD FRAME	100
Frame	02	WOOD FRAME	100
Exterior Wall	30	VINYL	100
Roof Structure	03	GABLE/HIP	100
Roof Cover	03	COMP SHNGL	100
Interior Wall	05	DRYWALL	100
Interior Floor	08	SHT VINYL	50
Interior Floor	14	CARPET	50
Heating Type	04	AIR DUCTED	100
Air Condition	03	CENTRAL	100
Bedrooms		3	100
Bathrooms		2	100
Stories	1.	1.	100
Class	00	N/A	100
Units		0	100
Quality	03	AVERAGE	
DOR CODE	0200	MOBILE HOME	
MAP NUM	2	MKT AREA	11
NEIGHBORHOOD/LOC	000	1.00/	
AREA TYPE	TOTAL GROSS AREA	PCT OF BASE	YEAR
BAS	1,728	100	1998
DCK	36	10	2011
FSP	160	60	1999
UOP	70	25	2011
USP	96	50	1999
TOTALS	2,090		

MARKET ADJUSTMENTS													
TYPE	MDL	EFF. AREA	TOT ADJ PTS	EFF. BASE RATE	REPL. COST NEW	AYB	EYB	ECON	FNCT	NORM	% COND		
0200	02	1,894	107.5000	75.25	142,524	1998	1998	0	0	45.00	55.00		
1 MOBILE HOM 100% - 0 Heated Area: 1728 HX Base Yr													

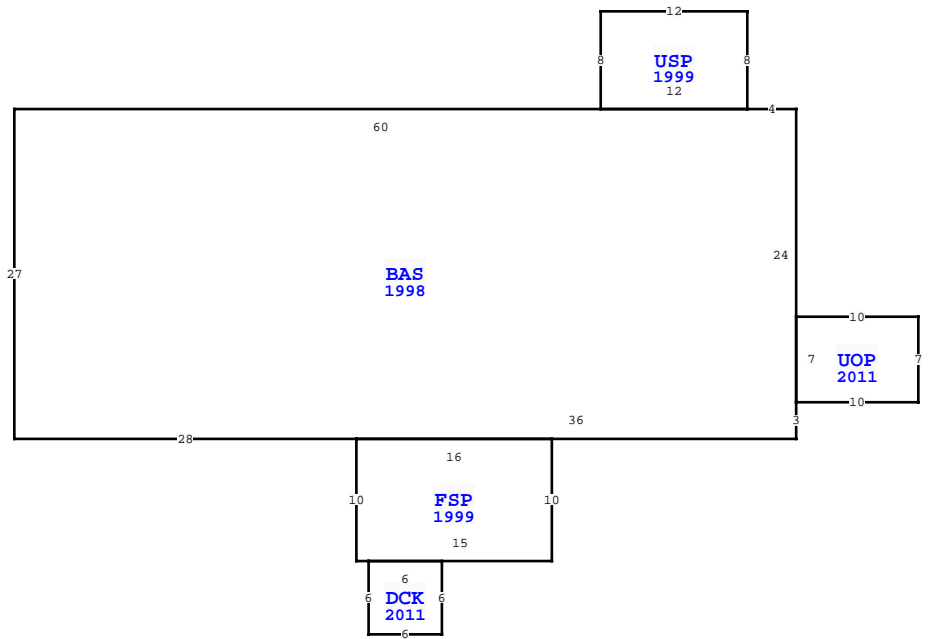

WAKULLA COUNTY PROPERTY				PAGE 1 of 1	3	
VALUATION SUMMARY						
VALUATION BY				STANDARD		
Tax Group: 3				Tax Dist:		
BUILDING MARKET VALUE				78,388		
TOTAL MARKET OB/XF VALUE				2,054		
TOTAL LAND VALUE - MARKET				45,000		
TOTAL MARKET VALUE				125,442		
SOH/AGL Deduction				49,724		
ASSESSED VALUE				75,718		
TOTAL EXEMPTION VALUE				HX HB SX WX 75,718		
BASE TAXABLE VALUE				0		
TOTAL JUST VALUE				125,442		
NCON VALUE				0		
INCOME VALUE				0		
PREVIOUS YEAR MKT VALUE				106,656		
JS 5YR CK PU XFOB 2/7/2023						
DC OR 1293 P 365 RICHARD HARNAGE						
XFOB LN 6-7, DEL XFOB LN 8						
LN 1,3 & 4 CORR CODE & DIMENS XFOB LN 2, PU						
PERMIT NUM	DESCRIPTION	AMT	ISSUED			
17001353	SEAWALL	0	11/02/2017			
2010529	MECH	0	06/28/2010			
2008716	REROOF	0	08/19/2008			
023823	N/A	0	07/14/1998			
023780	N/A	0	07/02/1998			
023692	N/A	0	06/10/1998			
SALES DATA						
OFF RECORD Number	DATE	TYPE INST	Q / U	V / I	RSN CD	SALE PRICE
0734/0688	11/02/2007	WD	Q	I	01	100
GRANTOR: HARNAGE RICHARD D & L						
GRANTEE: HARNAGE RICHARD D &						
BUILDING NOTES						
BUILDING DIMENSIONS						
BAS=[YR=1998] W4 USP=[YR=1999] N8 W12 S8 E12\$ W60 S27 E28						
FSP=[YR=1999] S10 E1 DCK=[YR=2011] S6 E6 N6 W6\$ E15 N10 W16\$						
E36 N3 UOP=[YR=2011] E10 N7 W10 S7\$ N24\$.						

EXTRA FEATURES																
L N	OB/XF CODE	DESCRIPTION	BLD CAP	L	W	UNITS	UT	Adj R	ADJ UNIT PRICE	ORIG COND	YEAR ON	YEAR ACTUAL	Q	% COND	OB/XF MKT VALUE	NOTES
1	0940	OPEN SHED	0	100	16	30			4.00	100	1995	1995	3	20	384	
2	0700	PORT BLDG	0	100	10	14			8.00	100	1991	1991	3	48	538	
3	0940	OPEN SHED	0	100	20	12			4.00	100	2002	2002	3	20	192	
4	0940	OPEN SHED	0	100	12	14			4.00	100	2002	2002	3	20	134	
5	0625	PORT WD UT	0	100	16	10			6.00	100	2004	2004	3	23	221	
6	0940	OPEN SHED	0	100	10	16			4.00	100	2004	2004	3	23	147	
7	0625	PORT WD UT	0	100	8	12			6.00	100	2017	2017	3	76	438	
10	0055	PORTABLE C	0	100	25	18			0.00	100	2024	2020	AV	89	0	

LAND DESCRIPTION														TOTAL OB/XF										
L N	USE CODE	CLS	LAND USE DESCRIPTION	CAP	R D	LOC ZONE	FRONT	DEPTH	TOT LND UTS	UNIT TYPE	D T	DPH FACT	% COND	TOT ADJ	UNIT PRICE	ADJ UNIT PRICE	LAND VALUE	OTHER ADJUSTMENTS AND NOTES	YEAR	DENSITY	DECL	FRZ	YR	CONSRV
1	000201	C	MH	100			0.00	0.00	6.00	AC		1.00	1.00	1.00	7,500.00	7,500.00	45,000							