

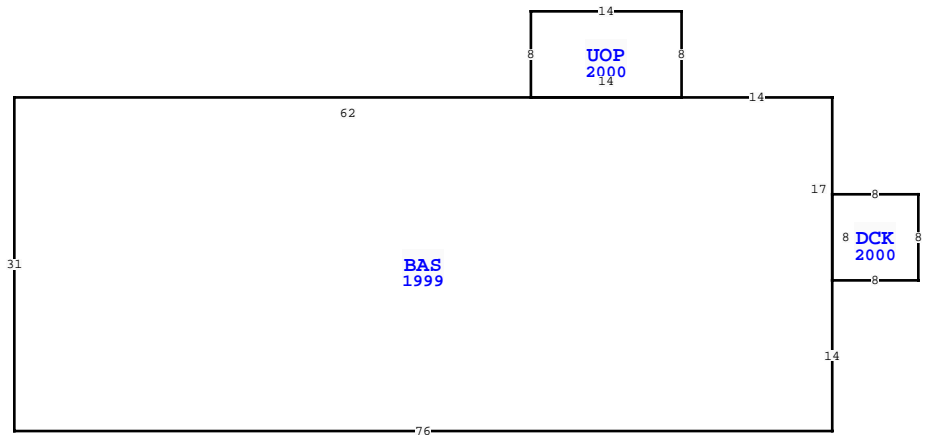

BUILDING CHARACTERISTICS		CONSTRUCTION	
ELEMENT	CD		
Foundation	01	WOOD FRAME	100
Frame	02	WOOD FRAME	100
Exterior Wall	30	VINYL	100
Roof Structur	03	GABLE/HIP	100
Roof Cover	03	COMP SHNGL	100
Interior Wall	05	DRYWALL	100
Interior Floo	08	SHT VINYL	50
Interior Floo	14	CARPET	50
Heating Type	04	AIR DUCTED	100
Air Condition	03	CENTRAL	100
Bedrooms		3	100
Bathrooms		2	100
Stories	1.	1.	100
Class	00	N/A	100
Units		0	100
Quality	03	AVERAGE	
DOR CODE	0200	MOBILE HOME	
MAP NUM	1	MKT AREA	09
NEIGHBORHOOD/LOC	000	1.00/	
AREA TYPE	TOTAL GROSS AREA	PCT OF BASE	YEAR
BAS	2,356	100	1999
DCK	64	10	2000
UOP	112	25	2000
TOTALS	2,532		

MARKET ADJUSTMENTS											
TYPE	MDL	EFF. AREA	TOT ADJ PTS	EFF. BASE RATE	REPL. COST NEW	AYB	EYB	ECON	FNCT	NORM	% COND
1	MOBILE HOM	100% - 0		75.25	179,848	1999	1999	0	0	44.00	56.00
Heated Area: 2356 HX Base Yr											



WAKULLA COUNTY PROPERTY			
VALUATION SUMMARY			PAGE 1 of 1
VALUATION BY			STANDARD
Tax Group: 3	Tax Dist:		
BUILDING MARKET VALUE			100,715
TOTAL MARKET OB/XF VALUE			1,285
TOTAL LAND VALUE - MARKET			32,500
TOTAL MARKET VALUE			134,500
SOH/AGL Deduction			45,153
ASSESSED VALUE			89,347
TOTAL EXEMPTION VALUE	HX HB		50,000
BASE TAXABLE VALUE			39,347
TOTAL JUST VALUE			134,500
NCON VALUE			0
INCOME VALUE			
PREVIOUS YEAR MKT VALUE			110,363
5 YR PRCL CK, N/C			
5 YR PRCL CH, PU FNDN & FRME, PU XFOB LN 4			
PU NEW TRAV,FRM;XFOB#1-3;5 YR PRCL CK			
NC REMOVE RV CHK HX			
PERMIT NUM	DESCRIPTION	AMT	ISSUED
025268	DW MH	0	06/08/1999

SALES DATA						
OFF RECORD Number	DATE	TYPE INST	Q U	V I	RSN CD	SALE PRICE
0222/0812	11/01/1993	WD	Q	V		15,000

BLD DATE		RTSS		LGL DATE	
XF DATE	INC DATE	LAND DATE	AG DATE	04/17/2019 RTSS	
04/17/2019	04/17/2019	04/17/2019			

BUILDING NOTES	
BUILDING DIMENSIONS	
BAS=[YR=1999] W14 UOP=[YR=2000] N8 W14 S8 E14\$ W62 S31 E76 N14 DCK=[YR=2000] E8 N8 W8 S8\$ N17\$.	

EXTRA FEATURES																
L N	OB/XF CODE	DESCRIPTION	BLD CAP	L	W	UNITS	UT	Adj R	ADJ UNIT PRICE	ORIG COND	YEAR ON	YEAR ACTUAL	Q	% COND	OB/XF MKT VALUE	NOTES
1	0700	PORT BLDG	0	100	6	8			8.00	100	2000	2000	3	57	219	
2	0700	PORT BLDG	0	100	6	10			8.00	100	2000	2000	3	57	274	
3	0600	GRN HSE FA	0	100	8	10			4.00	100	2000	2000	3	20	64	
4	0130	FIRE PLACE	0	100	0	0			1,300.00	100	1999	1999	3	56	728	

LAND DESCRIPTION															TOTAL OB/XF									
L N	USE CODE	CLS	LAND USE DESCRIPTION	CAP	R D	LOC ZONE	FRONT	DEPTH	TOT LND UTS	UNIT TYPE	D T	DPHT FACT	% COND	TOT ADJ	UNIT PRICE	ADJ UNIT PRICE	LAND VALUE	OTHER ADJUSTMENTS AND NOTES	YEAR	DENSITY	DECL	FRZ	YR	CONSRV
1	000201	C	MH	100			0.00	0.00	5.00	AC		1.00	1.00	1.00	6,500.00	6,500.00	32,500							