

| BUILDING CHARACTERISTICS | | CONSTRUCTION | |
|--------------------------|------------------|---------------|------|
| ELEMENT | CD | | |
| Foundation | 02 | CONCR SLAB | 100 |
| Frame | 02 | WOOD FRAME | 100 |
| Exterior Wall | 05 | HARDIE BRD | 90 |
| Exterior Wall | 19 | COMMON BRK | 10 |
| Roof Structure | 03 | GABLE/HIP | 100 |
| Roof Cover | 03 | COMP SHNGL | 100 |
| Interior Wall | 05 | DRYWALL | 100 |
| Interior Floor | 11 | CLAY TILE | 50 |
| Interior Floor | 12 | HARDWOOD | 50 |
| Heating Type | 04 | AIR DUCTED | 100 |
| Air Condition | 03 | CENTRAL | 100 |
| Bedrooms | | 3 | 100 |
| Bathrooms | | 2.5 | 100 |
| Story Height | | 0 | 100 |
| Stories | 1. | 1. | 100 |
| Units | | 0 | 100 |
| Quality | 07 | GOOD | |
| DOR CODE | 0100 | SINGLE FAMILY | |
| MAP NUM | 1 | MKT AREA | 12 |
| NEIGHBORHOOD/LOC | 166.00 | 1.45/ | |
| AREA TYPE | TOTAL GROSS AREA | PCT OF BASE | YEAR |
| BAS | 2,483 | 100 | 2007 |
| DCK | 16 | 10 | 2007 |
| DCK | 16 | 10 | 2007 |
| FGR | 599 | 50 | 2007 |
| FOP | 237 | 30 | 2007 |
| FSP | 372 | 55 | 2007 |
| TOTALS | 3,723 | | |

| MARKET ADJUSTMENTS | | | | | | | | | | | |
|-----------------------------------|------------|-------------|-------------|----------------|----------------|------|------|------|------|-------|--------|
| TYPE | MDL | EFF. AREA | TOT ADJ PTS | EFF. BASE RATE | REPL. COST NEW | AYB | EYB | ECON | FNCT | NORM | % COND |
| 1 | SINGLE FAM | 100% - 2008 | | | 597,775 | 2007 | 2011 | 0 | 0 | 12.00 | 88.00 |
| Heated Area: 2483 HX Base Yr 2008 | | | | | | | | | | | |

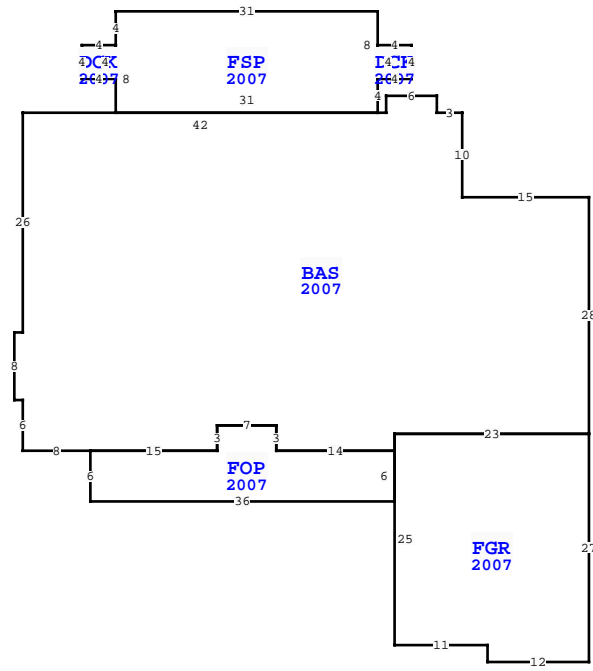

| WAKULLA COUNTY PROPERTY | | | | PAGE 1 of 1 | 3 | |
|--|--------------|-----------|------------|--------------|--------|------------|
| VALUATION SUMMARY | | | | | | |
| VALUATION BY | | | | STANDARD | | |
| Tax Group: 3 | | | | Tax Dist: | | |
| BUILDING MARKET VALUE | | | | 526,042 | | |
| TOTAL MARKET OB/XF VALUE | | | | 10,426 | | |
| TOTAL LAND VALUE - MARKET | | | | 45,000 | | |
| TOTAL MARKET VALUE | | | | 581,468 | | |
| SOH/AGL Deduction | | | | 338,687 | | |
| ASSESSED VALUE | | | | 242,781 | | |
| TOTAL EXEMPTION VALUE | | | | HX HB 50,000 | | |
| BASE TAXABLE VALUE | | | | 192,781 | | |
| TOTAL JUST VALUE | | | | 581,468 | | |
| NCON VALUE | | | | 0 | | |
| INCOME VALUE | | | | 0 | | |
| PREVIOUS YEAR MKT VALUE | | | | 403,263 | | |
| INCR EYB 2007-2011 RE-ROOF B23-223 CC 3/29/2023 | | | | | | |
| 5 YEAR PRCL CH, N/C | | | | | | |
| 5 YR PRCL CK. CHG QUALITY. | | | | | | |
| CORR. SPELLING OF RD NAME | | | | | | |
| PERMIT NUM | DESCRIPTION | AMT | ISSUED | | | |
| B23-000223 | RE-ROOF-CC | 0 | 03/20/2023 | | | |
| 20000453 | HVAC | 0 | 09/30/2020 | | | |
| 2011281 | LAWN STORAGE | 0 | 05/04/2011 | | | |
| 2007612 | SFD-CO | 0 | 04/27/2007 | | | |
| SALES DATA | | | | | | |
| OFF RECORD Number | DATE | TYPE INST | Q / U | V / I | RSN CD | SALE PRICE |
| 0348/0013 | 3/11/1999 | WD Q | Q | V | | 30,000 |
| GRANTOR: CARD NORMAN P & DONNA | | | | | | |
| GRANTEE: | | | | | | |
| 0118/0167 | 1/01/1986 | WD U | V | | | 385,000 |
| GRANTOR: | | | | | | |
| GRANTEE: | | | | | | |
| BUILDING NOTES | | | | | | |
| BUILDING DIMENSIONS | | | | | | |
| BAS=[YR=2007] W15 N10 W3 N2 W6 S2 W1 FSP=[YR=2007] N4 DCK=[YR=2007] E4 N4 W4 S4\$ N8 W31 S4 DCK=[YR=2007] W4 S4 E4 N4\$ S8 E31\$ W42 S26 W1 S8 E1 S6 E8 FOP=[YR=2007] S6 E36 N6 W14 N3 W7 S3 W15\$ E15 N3 E7 S3 E14 N2 FGR=[YR=2007] S25 E11 S2 E12 N27 W23\$ E23 N28\$. | | | | | | |

| EXTRA FEATURES | | | | | | | | | | | | | | | | | | | | | | | | |
|----------------|------------|-------------|---------|-----|----|----------|----|----------|----------------|-----------|---------|-------------|---|--------|-----------------|-------|-------|---------|--|--|--|--|--|--|
| L N | OB/XF CODE | DESCRIPTION | BLD CAP | L | W | UNITS | UT | Adj R | ADJ UNIT PRICE | ORIG COND | YEAR ON | YEAR ACTUAL | Q | % COND | OB/XF MKT VALUE | NOTES | | | | | | | | |
| 1 | 0130 | FIRE PLACE | 0 | 100 | 0 | 1.00 | UT | 1,885.00 | 1,885.00 | 100 | 2007 | 2007 | 3 | 68 | 1,282 | | | | | | | | | |
| 2 | 0211 | CONCRETE W | 0 | 100 | 64 | 4 | SF | 8.70 | 8.70 | 100 | 2007 | 2007 | 3 | 30 | 668 | | | | | | | | | |
| 3 | 0210 | CONCRETE D | 0 | 100 | 0 | 2,656.00 | SF | 8.70 | 8.70 | 100 | 2007 | 2007 | 3 | 30 | 6,932 | | | | | | | | | |
| 4 | 0213 | CONCRETE P | 0 | 100 | 11 | 11 | SF | 8.70 | 8.70 | 100 | 2011 | 2011 | 3 | 100 | 1,053 | | | | | | | | | |
| 5 | 0620 | WOOD UTL B | 0 | 100 | 10 | 12 | SF | 8.70 | 8.70 | 100 | 2011 | 2011 | 3 | 47 | 491 | | | | | | | | | |
| TOTALS | | | | | | | | | | | | | | | 3,723 | | 3,063 | 526,042 | | | | | | |

| LAND DESCRIPTION | | | | | | | | | | | | | | | TOTAL OB/XF | | | | | | | | | |
|------------------|----------|-----|----------------------|-----|-----|----------|-------|-------|-------------|-----------|-----|----------|--------|---------|-------------|----------------|------------|-----------------------------|------|---------|------|-----|----|--------|
| L N | USE CODE | CLS | LAND USE DESCRIPTION | CAP | R D | LOC ZONE | FRONT | DEPTH | TOT LND UTS | UNIT TYPE | D T | DPH FACT | % COND | TOT ADJ | UNIT PRICE | ADJ UNIT PRICE | LAND VALUE | OTHER ADJUSTMENTS AND NOTES | YEAR | DENSITY | DECL | FRZ | YR | CONSRV |
| 1 | 000130 | C | SFR WATER | 100 | | | 0.00 | 0.00 | 1.00 | LT | | 1.00 | 1.00 | 1.00 | 45,000.00 | 45,000.00 | 45,000 | | | | | | | |