

ELEMENT		CD		CONSTRUCTION	
Foundation	01	WOOD	FRAME	100	
Frame	02	WOOD	FRAME	100	
Exterior Wall	27	PREFIN	MTL	100	
Roof Structur	03	GABLE/HIP		100	
Roof Cover	03	COMP	SHNGL	100	
Interior Wall	05	DRYWALL		100	
Interior Floo	08	SHT	VINYL	50	
Interior Floo	14	CARPET		50	
Heating Type	04	AIR	DUCTED	100	
Air Condition	03	CENTRAL		100	
Bedrooms				3	100
Bathrooms				2	100
Stories	1.			1.	100
Class	00	N/A			100
Units				0	100
Quality	03	AVERAGE			
DOR CODE	0200	MOBILE HOME			
MAP NUM	2				11
NEIGHBORHOOD/LOC	212.00			1.00/	
AREA TYPE	TOTAL GROSS AREA	PCT OF BASE	YEAR	TOT ADJ AREA	SUBAREA MARKET VALUE
BAS	1,776	100	1993	1,776	62,228
DCK	816	10	1993	82	2,873
USP	289	50	2011	144	5,045
TOTALS	2,881			2,002	70,147

MARKET ADJUSTMENTS											
TYPE	MDL	EFF. AREA	TOT ADJ PTS	EFF. BASE RATE	REPL. COST NEW	AYB	EYB	ECON	FNCT	NORM	% COND
0200	02	2,002	106.5000	74.55	149,249	1990	1990	0	0	53.00	47.00
1 MOBILE HOM 100% - 2008 Heated Area: 1776 HX Base Yr 2008											

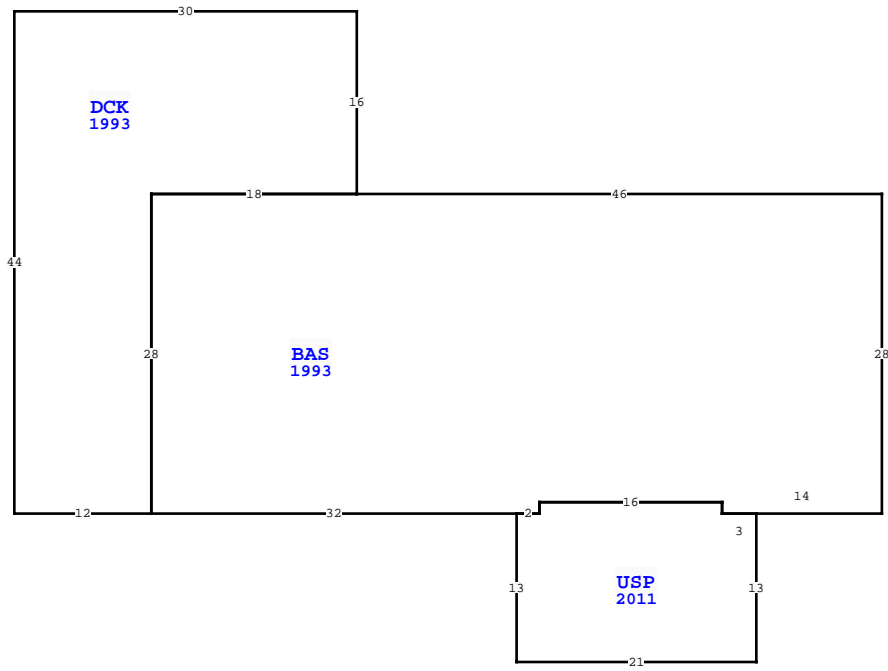

WAKULLA COUNTY PROPERTY			
VALUATION SUMMARY			PAGE 1 of 1
VALUATION BY			STANDARD
Tax Group: 3	Tax Dist:		
BUILDING MARKET VALUE			70,147
TOTAL MARKET OB/XF VALUE			14,288
TOTAL LAND VALUE - MARKET			75,000
TOTAL MARKET VALUE			159,435
SOH/AGL Deduction			102,554
ASSESSED VALUE			56,881
TOTAL EXEMPTION VALUE	HX HB		31,881
BASE TAXABLE VALUE			25,000
TOTAL JUST VALUE			159,435
NCON VALUE			0
INCOME VALUE			
PREVIOUS YEAR MKT VALUE			117,695
5 YR CHK NO CHANGE			
LN1. PU FNDN &FRME, CORR TRAV			
5 YR CHK, DEL XFBO LN 8-9, PU 6-7 CHG DIMEN			
ADD HX AND PORTABILITY FOR 2008 PH#926-9959			
PERMIT NUM	DESCRIPTION	AMT	ISSUED
17000948	REROOF	0	07/14/2017

SALES DATA						
OFF RECORD Number	DATE	TYPE INST	Q U	V I	RSN CD	SALE PRICE
0723/0324	8/07/2007	WD Q		I	03	140,000
GRANTOR: FULFORD THOMAS F & EV						
GRANTEE: MCLEMORE DANNY F &						

EXTRA FEATURES																	
L N	OB/XF CODE	DESCRIPTION	BLD	CAP	L	W	UNITS	UT	Adj R	ADJ UNIT PRICE	ORIG COND	YEAR ON	YEAR ACTUAL	Q	% COND	OB/XF MKT VALUE	NOTES
1	0940	OPEN SHED	0	100	16	12	384.00	SF	4.00	4.00	100	1990	1990	3	20	307	
2	0080	4' CHAINLI	0	100	0	0	2,800.00	LF	13.00	13.00	100	1991	1991	3	20	7,280	
3	0130	FIRE PLACE	0	100	0	0	1.00	UT	1,300.00	1,300.00	100	1993	1993	3	50	650	
4	0940	OPEN SHED	0	100	32	16	512.00	SF	4.00	4.00	100	2002	2002	3	20	410	
5	0940	OPEN SHED	0	100	20	9	180.00	SF	4.00	4.00	100	2002	2002	3	20	144	
6	0700	PORT BLDG	0	100	24	12	288.00	SF	8.00	8.00	100	2012	2012	3	78	1,797	
7	0050	CARPORT UN	0	100	31	17	527.00	SF	9.00	9.00	100	2012	2012	3	78	3,700	
TOTALS															14,288		

LAND DESCRIPTION																								
L N	USE CODE	CLS	LAND USE DESCRIPTION	CAP	R D	LOC ZONE	FRONT	DEPTH	TOT LND UTS	UNIT TYPE	D T	DPH FACT	% COND	TOT ADJ	UNIT PRICE	ADJ UNIT PRICE	LAND VALUE	OTHER ADJUSTMENTS AND NOTES	YEAR	DENSITY	DECL	FRZ	YR	CONSRV
1	000201	C	MH	100			0.00	0.00	1.00	LT		1.00	1.00	1.00	75,000.00	75,000.00	75,000							