

| BUILDING CHARACTERISTICS | | CONSTRUCTION | |
|--------------------------|------------------|---------------|------------|
| ELEMENT | CD | | |
| Foundation | 02 | CONCR | SLAB 100 |
| Frame | 20 | WOOD | FRAME 100 |
| Exterior Wall | 02 | FACE | BRICK 100 |
| Roof Structure | 03 | GABLE/HIP | 100 |
| Roof Cover | 03 | COMP | SHNGL 100 |
| Interior Wall | 05 | DRYWALL | 100 |
| Interior Floor | 08 | SHT | VINYL 50 |
| Interior Floor | 14 | CARPET | 50 |
| Heating Type | 04 | AIR | DUCTED 100 |
| Air Condition | 03 | CENTRAL | 100 |
| Bedrooms | | | 3 100 |
| Bathrooms | | | 2 100 |
| Story Height | | | 0 100 |
| Stories | 1. | | 1. 100 |
| Units | | | 0 100 |
| Quality | 03 | AVERAGE | |
| DOR CODE | 0100 | SINGLE FAMILY | |
| MAP NUM | 2 | MKT AREA | 10 |
| NEIGHBORHOOD/LOC | 000 | 1.00/ | |
| AREA TYPE | TOTAL GROSS AREA | PCT OF BASE | YEAR |
| BAS | 1,705 | 100 | 1993 |
| FGR | 480 | 50 | 1993 |
| FOP | 84 | 30 | 1993 |
| FSP | 180 | 55 | 1995 |
| TOTALS | 2,449 | | |

| MARKET ADJUSTMENTS | | | | | | | | | | | |
|------------------------------|------------|-----------|-------------|----------------|----------------|-----|-----|------|------|------|--------|
| TYPE | MDL | EFF. AREA | TOT ADJ PTS | EFF. BASE RATE | REPL. COST NEW | AYB | EYB | ECON | FNCT | NORM | % COND |
| 1 | SINGLE FAM | 100% | - 0 | | | | | | | | |
| Heated Area: 1705 HX Base Yr | | | | | | | | | | | |

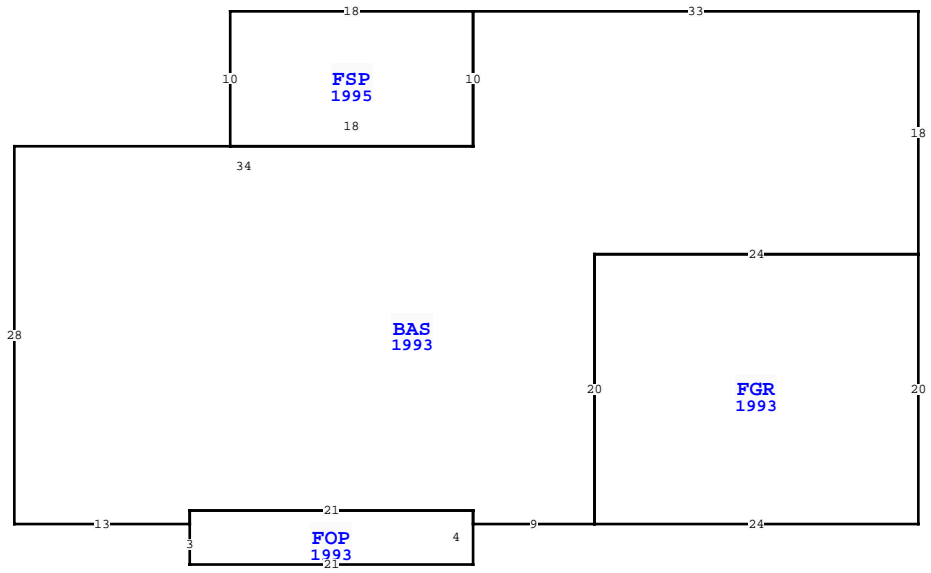

| WAKULLA COUNTY PROPERTY | | PAGE 1 of 2 | 3 |
|---------------------------|-------|-------------|----------|
| VALUATION SUMMARY | | | |
| VALUATION BY | | | STANDARD |
| Tax Group: 3 | | Tax Dist: | |
| BUILDING MARKET VALUE | | | 142,404 |
| TOTAL MARKET OB/XF VALUE | | | 23,598 |
| TOTAL LAND VALUE - MARKET | | | 31,500 |
| TOTAL MARKET VALUE | | | 197,502 |
| SOH/AGL Deduction | | | 72,542 |
| ASSESSED VALUE | | | 124,960 |
| TOTAL EXEMPTION VALUE | HX HB | | 50,000 |
| BASE TAXABLE VALUE | | | 74,960 |
| TOTAL JUST VALUE | | | 197,502 |
| NCON VALUE | | | 0 |
| INCOME VALUE | | | |
| PREVIOUS YEAR MKT VALUE | | | 192,886 |

| SALES DATA | | | |
|-------------------|------|------------|--------------------|
| OFF RECORD Number | DATE | TYPE INST | Q / V / I / RSN CD |
| 15000820 | | RE-ROOF-CO | 0 09/02/2015 |

| BUILDING NOTES | | | |
|----------------|--|--|--|
| | | | |

| BUILDING DIMENSIONS | | | |
|--|--|--|--|
| BAS=[YR=1993] W33 FSP=[YR=1995] W18 S10 E18 N10 S10 W34 S28 E13 FOP=[YR=1993] S3 E21 N4 W21 S1 S1 E21 S1 E9 FGR=[YR=1993] E24 N20 W24 S20 S N20 E24 N18 S. | | | |

| EXTRA FEATURES | | | | | | | | | | | | | | | | |
|----------------|------------|-------------|---------|----|----|----------|----|-------|----------------|-----------|---------|-------------|---|--------|-----------------|-------|
| L N | OB/XF CODE | DESCRIPTION | BLD CAP | L | W | UNITS | UT | Adj R | ADJ UNIT PRICE | ORIG COND | YEAR ON | YEAR ACTUAL | Q | % COND | OB/XF MKT VALUE | NOTES |
| 1 | 0210 | CONCRETE D | 0 100 | 0 | 0 | 1,098.00 | SF | 6.00 | 6.00 | 100 | 1986 | 1986 | 3 | 20 | 1,318 | |
| 2 | 0700 | PORT BLDG | 0 100 | 20 | 10 | 200.00 | SF | 8.00 | 8.00 | 100 | 1987 | 1987 | 3 | 44 | 704 | |
| 3 | 0940 | OPEN SHED | 0 100 | 24 | 10 | 240.00 | SF | 4.00 | 4.00 | 100 | 1987 | 1987 | 3 | 20 | 192 | |
| 4 | 0220 | POOL VINYL | 0 100 | 16 | 32 | 512.00 | SF | 60.00 | 60.00 | 100 | 1994 | 1994 | 3 | 40 | 12,288 | |
| 5 | 0211 | CONCRETE W | 0 100 | 0 | 0 | 408.00 | SF | 6.00 | 6.00 | 100 | 1995 | 1995 | 3 | 20 | 490 | |
| 6 | 0210 | CONCRETE D | 0 100 | 88 | 11 | 968.00 | SF | 6.00 | 6.00 | 100 | 1995 | 1995 | 3 | 20 | 1,162 | |
| 7 | 0955 | PRIVACY FE | 0 100 | 0 | 0 | 334.00 | LF | 15.00 | 15.00 | 100 | 1995 | 1995 | 3 | 0 | 0 | |
| 8 | 0211 | CONCRETE W | 0 100 | 46 | 3 | 138.00 | SF | 6.00 | 6.00 | 100 | 1995 | 1995 | 3 | 20 | 166 | |
| 9 | 0030 | BARN, POLE | 0 100 | 40 | 21 | 840.00 | SF | 9.00 | 9.00 | 100 | 2009 | 2009 | 3 | 39 | 2,948 | |
| 10 | 0060 | DECK WOOD | 0 100 | 24 | 8 | 192.00 | SF | 5.00 | 5.00 | 100 | 2009 | 2009 | 3 | 55 | 528 | |

| LAND DESCRIPTION | | | | | | | | | | | | | | | TOTAL OB/XF | | | | | | | | | |
|------------------|----------|-----|----------------------|-----|-----|----------|-------|-------|-------------|-----------|-----|----------|--------|---------|-------------|----------------|------------|-----------------------------|------|---------|------|-----|----|--------|
| L N | USE CODE | CLS | LAND USE DESCRIPTION | CAP | R D | LOC ZONE | FRONT | DEPTH | TOT LND UTS | UNIT TYPE | D T | DPH FACT | % COND | TOT ADJ | UNIT PRICE | ADJ UNIT PRICE | LAND VALUE | OTHER ADJUSTMENTS AND NOTES | YEAR | DENSITY | DECL | FRZ | YR | CONSRV |
| 1 | 000100 | C | SFR | 100 | | | 0.00 | 0.00 | 4.20 | AC | | 1.00 | 1.00 | 1.00 | 7,500.00 | 7,500.00 | 31,500 | | | | | | | |

