

| BUILDING CHARACTERISTICS | |
|--------------------------|--------------------|
| ELEMENT | CD |
| Foundation | 01 WOOD FRAME 100 |
| Frame | 02 WOOD FRAME 100 |
| Exterior Wall | 04 SINGLE SID 100 |
| Roof Structur | 03 GABLE/HIP 100 |
| Roof Cover | 01 MINIMUM 100 |
| Interior Wall | 02 WALL BD/WD 50 |
| Interior Wall | 04 PLYWOOD 50 |
| Interior Floo | 09 PINE WOOD 100 |
| Heating Type | 14 MINI SPLIT 100 |
| Air Condition | 14 MINI SPLIT 100 |
| Bedrooms | 1 100 |
| Bathrooms | 1 100 |
| Story Height | 0 100 |
| Stories | 1. 1. 100 |
| Units | 0 100 |
| Condition Adj | 12 AVERAGE 100 |
| Quality | 02 BELOW AVERAGE |
| DOR CODE | 5000 IMPRVD AG RES |
| MAP NUM | 5 MKT AREA 13 |
| NEIGHBORHOOD/LOC | 000 1.00/ |
| AREA TYPE | TOTAL GROSS AREA |
| BAS | 724 |
| UOP | 108 |
| USP | 320 |
| TOTALS | 1,152 |

| MARKET ADJUSTMENTS | | | | | | | | | | | | | |
|--------------------|------------|-----------|-------------|----------------|----------------|------|------|------|------|-------|--------|-----------------------------|--|
| TYPE | MDL | EFF. AREA | TOT ADJ PTS | EFF. BASE RATE | REPL. COST NEW | AYB | EYB | ECON | FNCT | NORM | % COND | | |
| 1 | SINGLE FAM | 0% | - 0 | | 66,337 | 1912 | 1912 | 0 | 0 | 60.00 | 40.00 | Heated Area: 724 HX Base Yr | |

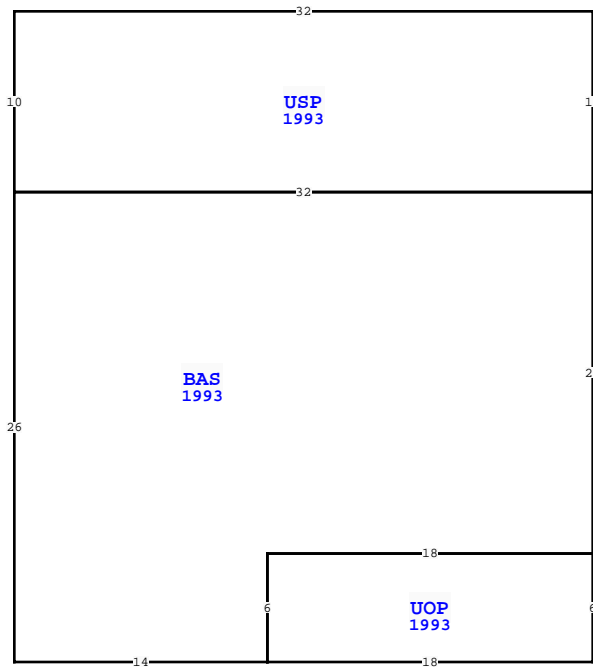

| WAKULLA COUNTY PROPERTY | | | | |
|--|-------------|-----------|--------------------|------------|
| VALUATION SUMMARY | | | | |
| Tax Group: 3 | Tax Dist: | STANDARD | | |
| BUILDING MARKET VALUE | 26,535 | | | |
| TOTAL MARKET OB/XF VALUE | 410 | | | |
| TOTAL LAND VALUE - MARKET | 335,100 | | | |
| TOTAL MARKET VALUE | 59,251 | | | |
| SOH/AGL Deduction | 10,111 | | | |
| ASSESSED VALUE | 49,140 | | | |
| TOTAL EXEMPTION VALUE | 0 | | | |
| BASE TAXABLE VALUE | 49,140 | | | |
| TOTAL JUST VALUE | 362,045 | | | |
| NCON VALUE | 0 | | | |
| INCOME VALUE | 0 | | | |
| PREVIOUS YEAR MKT VALUE | 38,844 | | | |
| MM 5YRCHK 08/15/2022 ADD MINISPLIT | | | | |
| MM LEFT DOOR HANGER | | | | |
| 2022 AG RENEWAL RECD | | | | |
| 2021 AG RENEWAL RECD | | | | |
| PERMIT NUM | DESCRIPTION | AMT | ISSUED | |
| 201497 | ELECT | 0 | 02/07/2014 | |
| 201497 | ELECT | 0 | 02/07/2014 | |
| 2012130 | ELECT | 0 | 03/13/2012 | |
| 30204 | SFD | 0 | 03/18/1997 | |
| SALES DATA | | | | |
| OFF RECORD Number | DATE | TYPE INST | Q U / V I / RSN CD | SALE PRICE |
| 0873/0321 | 2/28/2012 | QC U | I 11 | 100 |
| GRANTOR: FOLDES LANCE J | | | | |
| GRANTEE: DOZIER CONNIE F | | | | |
| 0852/0440 | 4/22/2011 | PR U | I 19 | 100 |
| GRANTOR: DOZIER CONNIE F | | | | |
| GRANTEE: DOZIER CONNIE F & L | | | | |
| BUILDING NOTES | | | | |
| BUILDING DIMENSIONS | | | | |
| USP=[YR=1993] W32 S10 E32 BAS=[YR=1993] W32 S26 E14 N6 E18 | | | | |
| UOP=[YR=1993] W18 S6 E18 N6\$ N20\$ N10\$. | | | | |

| EXTRA FEATURES | | | | | | | | | | | | | | | | |
|----------------|------------|-------------|---------|---|---|-------|----|----------|----------------|-----------|---------|-------------|---|-------------|-----------------|-------|
| L N | OB/XF CODE | DESCRIPTION | BLD CAP | L | W | UNITS | UT | Adj R | ADJ UNIT PRICE | ORIG COND | YEAR ON | YEAR ACTUAL | Q | % COND | OB/XF MKT VALUE | NOTES |
| 1 | 0130 | FIRE PLACE | 0 | 0 | 0 | 1.00 | UT | 1,300.00 | 1,300.00 | 100 | 1912 | 1912 | 3 | 20 | 260 | |
| 2 | 0630 | METAL UTL | 0 | 0 | 5 | 40.00 | SF | 8.00 | 8.00 | 100 | 2002 | 2002 | 3 | 20 | 64 | |
| 3 | 0630 | METAL UTL | 0 | 0 | 6 | 54.00 | SF | 8.00 | 8.00 | 100 | 1985 | 1985 | 3 | 20 | 86 | |
| | | | | | | | | | | | | | | TOTAL OB/XF | | 410 |

| LAND DESCRIPTION | | | | | | | | | | | | | | TOTAL OB/XF | | | | | | | | | | |
|------------------|----------|-----|----------------------|-----|-----|----------|-------|-------|-------------|-----------|-----|----------|--------|-------------|------------|----------------|------------|-----------------------------|------|---------|------|-----|----|--------|
| L N | USE CODE | CLS | LAND USE DESCRIPTION | CAP | R D | LOC ZONE | FRONT | DEPTH | TOT LND UTS | UNIT TYPE | D T | DPH FACT | % COND | TOT ADJ | UNIT PRICE | ADJ UNIT PRICE | LAND VALUE | OTHER ADJUSTMENTS AND NOTES | YEAR | DENSITY | DECL | FRZ | YR | CONSRV |
| 1 | 000110 | C | SFR RURAL | 0 | | | 0.00 | 0.00 | 1.00 | AC | | 1.00 | 1.00 | 1.00 | 15,000.00 | 15,000.00 | 15,000 | | | | | | | |
| 2 | 005500 | A | TIMBER 2 PLA | 0 | | | 0.00 | 0.00 | 28.00 | AC | | 1.00 | 1.00 | 1.00 | 200.00 | 200.00 | 5,600 | | | | | | | |
| 3 | 005970 | A | TIMBER MIX 1 | 0 | | | 0.00 | 0.00 | 36.02 | AC | | 1.00 | 1.00 | 1.00 | 325.00 | 325.00 | 11,706 | | | | | | | |