

ELEMENT		CD		CONSTRUCTION	
Foundation	01	WOOD	FRAME	100	
Frame	02	WOOD	FRAME	100	
Exterior Wall	30	VINYL	100		
Roof Structur	03	GABLE/HIP	100		
Roof Cover	13	GALVALUM	100		
Interior Wall	05	DRYWALL	100		
Interior Floo	14	CARPET	80		
Interior Floo	08	SHT VINYL	20		
Heating Type	04	AIR DUCTED	100		
Air Condition	03	CENTRAL	100		
Bedrooms				3	100
Bathrooms				1	100
Story Height				0	100
Stories	1.			1.	100
Units				0	100
Quality	08	FAIR			
DOR CODE	0100	SINGLE	FAMILY		
MAP NUM	2	MKT AREA		11	
NEIGHBORHOOD/LOC	000			1.00/	
AREA TYPE	TOTAL GROSS AREA	PCT OF BASE	YEAR	TOT ADJ AREA	SUBAREA MARKET VALUE
BAS	1,248	100	1993	1,248	44,903
BAS	192	100	1994	192	6,908
DCK	25	10	1994	2	72
UOP	288	20	1993	58	2,087
TOTALS	1,753			1,500	53,970

MARKET ADJUSTMENTS											
TYPE	MDL	EFF. AREA	TOT ADJ PTS	EFF. BASE RATE	REPL. COST NEW	AYB	EYB	ECON	FNCT	NORM	% COND
1	SINGLE FAM	100%	- 2013								
				Heated Area: 1440							
					HX Base Yr 2013						

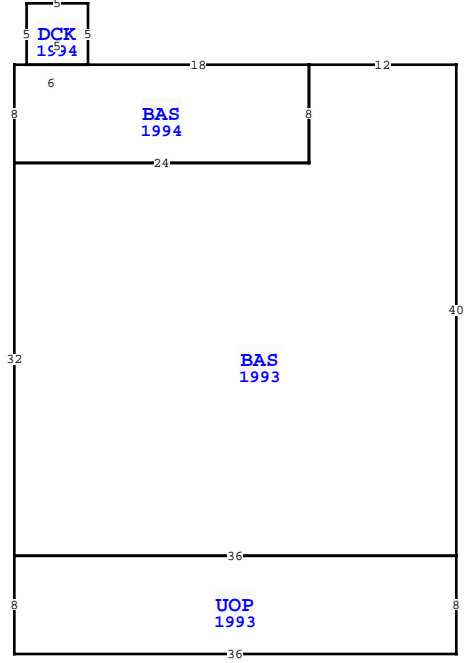

WAKULLA COUNTY PROPERTY		PAGE 1 of 1	3
VALUATION SUMMARY			
VALUATION BY		STANDARD	
Tax Group: 3		Tax Dist:	
BUILDING MARKET VALUE			53,970
TOTAL MARKET OB/XF VALUE			3,170
TOTAL LAND VALUE - MARKET			17,000
TOTAL MARKET VALUE			74,140
SOH/AGL Deduction			19,023
ASSESSED VALUE			55,117
TOTAL EXEMPTION VALUE	HX HB SX WX		55,117
BASE TAXABLE VALUE			0
TOTAL JUST VALUE			74,140
NCON VALUE			0
INCOME VALUE			
PREVIOUS YEAR MKT VALUE			74,253

JS 5YR CK; CHG XFOB FROM 0940 TO 0620			
2021 SX RENEWAL COMPLETED			
BE JTWS PER CORRECTIVE DEED OR 1165 P265			
PERMIT NUM	DESCRIPTION	AMT	ISSUED

SALES DATA						
OFF RECORD Number	DATE	TYPE INST	Q U	V I	RSN CD	SALE PRICE
1165/0265	8/19/2020	CR	U	I	30	100
GRANTOR: HUDSON SHERRY						
GRANTEE: HUDSON SHERRY & REA						
1126/0228	10/02/2019	QC	U	I	11	100
GRANTOR: HUDSON SHERRY						
GRANTEE: REASON MICHAEL T SR						

EXTRA FEATURES																
L N	OB/XF CODE	DESCRIPTION	BLD CAP	L	W	UNITS	UT	Adj R	ADJ UNIT PRICE	ORIG COND	YEAR ON	YEAR ACTUAL	Q	% COND	OB/XF MKT VALUE	NOTES
1	0620	WOOD UTL B	0 100	20	19	380.00	SF	6.00	6.00	100	2014	2014	3	62	1,414	
2	0055	PORTABLE C	0 100	20	18	360.00	SF	3.00	3.00	100	2002	2002	3	20	216	
3	0210	CONCRETE D	0 100	18	20	360.00	SF	6.00	6.00	100	2003	2003	3	21	454	
4	0210	CONCRETE D	0 100	20	8	160.00	SF	6.00	6.00	100	1990	1990	3	20	192	
5	0211	CONCRETE W	0 100	8	3	24.00	SF	6.00	6.00	100	1980	1980	3	20	29	
6	0950	METAL SHED	0 100	20	11	220.00	SF	8.00	8.00	100	1976	1976	3	20	352	
7	0950	METAL SHED	0 100	10	9	90.00	SF	8.00	8.00	100	1976	1976	3	20	144	
8	0940	OPEN SHED	0 100	8	8	64.00	SF	4.00	4.00	100	1986	1986	3	20	51	
9	0620	WOOD UTL B	0 100	8	8	64.00	SF	6.00	6.00	100	2004	2004	3	23	88	
10	0700	PORT BLDG	0 100	8	5	40.00	SF	8.00	8.00	100	2009	2009	3	72	230	

TOTAL OB/XF												3,170												
L N	USE CODE	CLS	LAND USE DESCRIPTION	CAP	R D	LOC ZONE	FRONT	DEPTH	TOT LND UTS	UNIT TYPE	D T	DPH FACT	% COND	TOT ADJ	UNIT PRICE	ADJ UNIT PRICE	LAND VALUE	OTHER ADJUSTMENTS AND NOTES	YEAR	DENSITY	DECL	FRZ	YR	CONSRV
1	000100	C	SFR	100			0.00	0.00	2.00	AC		1.00	1.00	1.00	8,500.00	8,500.00	17,000							

REVIEW DATE 03/22/2022 BY JSLH																													
Total Acres: 2.00						Total Land Value: 17,000						Market: 0						Agricultural: 0						Common: 17,000					