

| BUILDING CHARACTERISTICS | | | | | |
|--------------------------|------------------|----------------|------|--------------|----------------------|
| ELEMENT | CD | CONSTRUCTION | | | |
| Foundation | 02 | CONCR SLAB 100 | | | |
| Frame | 02 | WOOD FRAME 100 | | | |
| Exterior Wall | 05 | HARDIE BRD 100 | | | |
| Roof Structur | 03 | GABLE/HIP 100 | | | |
| Roof Cover | 03 | COMP SHNGL 100 | | | |
| Interior Wall | 05 | DRYWALL 100 | | | |
| Interior Floor | 11 | CLAY TILE 70 | | | |
| Interior Floor | 14 | CARPET 30 | | | |
| Heating Type | 04 | AIR DUCTED 100 | | | |
| Air Condition | 03 | CENTRAL 100 | | | |
| Bedrooms | | 3 100 | | | |
| Bathrooms | | 2 100 | | | |
| Story Height | | 0 100 | | | |
| Stories | 1. | 1. 100 | | | |
| Units | | 0 100 | | | |
| Quality | 03 | AVERAGE | | | |
| DOR CODE | 0100 | SINGLE FAMILY | | | |
| MAP NUM | 5 | MKT AREA 08 | | | |
| NEIGHBORHOOD/LOC | 000 | 1.00/ | | | |
| AREA TYPE | TOTAL GROSS AREA | PCT OF BASE | YEAR | TOT ADJ AREA | SUBAREA MARKET VALUE |
| BAS | 214 | 100 | 2017 | 214 | 23,793 |
| BAS | 464 | 100 | 2017 | 464 | 51,589 |
| FGR | 466 | 50 | 2017 | 233 | 25,905 |
| FOP | 145 | 30 | 2017 | 44 | 4,892 |
| FSP | 340 | 55 | 2017 | 187 | 20,791 |
| OWH | 1,102 | 100 | 2017 | 1,102 | 122,524 |
| PTO | 260 | 5 | 2017 | 13 | 1,446 |
| TOTALS | 2,991 | | | 2,257 | 250,941 |

| MARKET ADJUSTMENTS | | | | | | | | | | | |
|--------------------|------------|-----------|-------------|----------------|-------------------|-----|-----|------|------|-----------------|--------|
| TYPE | MDL | EFF. AREA | TOT ADJ PTS | EFF. BASE RATE | REPL. COST NEW | AYB | EYB | ECON | FNCT | NORM | % COND |
| 1 | SINGLE FAM | 100% | - 2019 | | Heated Area: 1780 | | | | | HX Base Yr 2019 | |

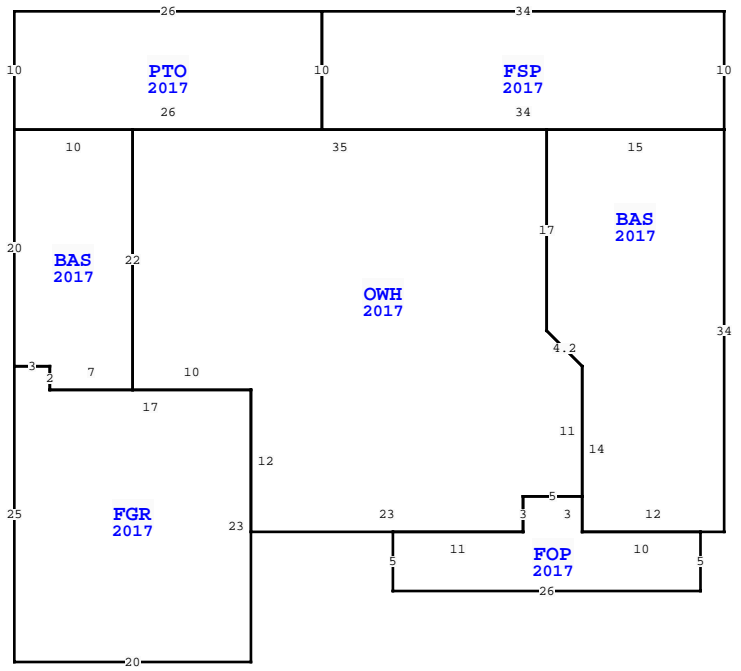

| WAKULLA COUNTY PROPERTY | | | |
|-------------------------------------|---------------|-----|-------------|
| VALUATION SUMMARY | | | PAGE 1 of 1 |
| VALUATION BY | | | STANDARD |
| Tax Group: 3 | Tax Dist: | | |
| BUILDING MARKET VALUE | | | 250,941 |
| TOTAL MARKET OB/XF VALUE | | | 14,725 |
| TOTAL LAND VALUE - MARKET | | | 20,000 |
| TOTAL MARKET VALUE | | | 285,666 |
| SOH/AGL Deduction | | | 105,505 |
| ASSESSED VALUE | | | 180,161 |
| TOTAL EXEMPTION VALUE | HX HB SX | | 100,000 |
| BASE TAXABLE VALUE | | | 80,161 |
| TOTAL JUST VALUE | | | 285,666 |
| NCON VALUE | | | 0 |
| INCOME VALUE | | | |
| PREVIOUS YEAR MKT VALUE | | | 289,065 |
| MM 5 YR CK, CORR FLR. | | | |
| 2021 SX RENEWAL COMPLETED | | | |
| 2020 SX ADDED/COMPLETED- KMETZSCH | | | |
| MAILED 2020 SX LATE APPROVAL LETTER | | | |
| PERMIT NUM | DESCRIPTION | AMT | ISSUED |
| 19001056 | ELECTRICAL-CO | 0 | 07/19/2019 |
| 16001044 | SFD-CO | 0 | 10/26/2016 |

| SALES DATA | | | | | | |
|--------------------------------|------------|-----------|-------|-------|--------|------------|
| OFF RECORD Number | DATE | TYPE INST | Q / U | V / I | RSN CD | SALE PRICE |
| 1043/0815 | 8/04/2017 | TR | U | V | 11 | 100 |
| GRANTOR: KMETZSCH MELVIN JAMES | | | | | | |
| GRANTEE: KMETZSCH MELVIN JAM | | | | | | |
| 0955/0863 | 11/21/2014 | WD | Q | V | 01 | 18,000 |
| GRANTOR: SALT MARSH PROPERTIES | | | | | | |
| GRANTEE: KMETZSCH MELVIN JAM | | | | | | |

| EXTRA FEATURES | | | | | | | | | | | | | | | | |
|----------------|------------|-------------|---------|-----|-----|----------|----|----------|----------------|-----------|---------|-------------|---|--------|-----------------|-------|
| L N | OB/XF CODE | DESCRIPTION | BLD CAP | L | W | UNITS | UT | Adj R | ADJ UNIT PRICE | ORIG COND | YEAR ON | YEAR ACTUAL | Q | % COND | OB/XF MKT VALUE | NOTES |
| 1 | 0130 | FIRE PLACE | 0 | 100 | 0 | 1.00 | UT | 1,300.00 | 1,300.00 | 100 | 2017 | 2017 | 3 | 88 | 1,144 | |
| 2 | 0210 | CONCRETE D | 0 | 100 | 81 | 972.00 | SF | 6.00 | 6.00 | 100 | 2017 | 2017 | 3 | 76 | 4,432 | |
| 3 | 0210 | CONCRETE D | 0 | 100 | 0 | 1,030.00 | SF | 6.00 | 6.00 | 100 | 2017 | 2017 | 3 | 76 | 4,697 | |
| 4 | 0211 | CONCRETE W | 0 | 100 | 100 | 400.00 | SF | 6.00 | 6.00 | 100 | 2017 | 2017 | 3 | 76 | 1,824 | |
| 5 | 0100 | 6" CHAINLI | 0 | 100 | 0 | 182.00 | LF | 19.00 | 19.00 | 100 | 2017 | 2017 | 3 | 76 | 2,628 | |
| TOTALS | | | | | | | | | | | | | | | 14,725 | |

| LAND DESCRIPTION | | | | | | | | | | | | | | | | | | | | | | | | |
|------------------|----------|-----|----------------------|-----|-----|----------|-------|-------|-------------|-----------|-----|----------|--------|---------|------------|----------------|------------|-----------------------------|------|---------|------|-----|----|--------|
| L N | USE CODE | CLS | LAND USE DESCRIPTION | CAP | R D | LOC ZONE | FRONT | DEPTH | TOT LND UTS | UNIT TYPE | D T | DPH FACT | % COND | TOT ADJ | UNIT PRICE | ADJ UNIT PRICE | LAND VALUE | OTHER ADJUSTMENTS AND NOTES | YEAR | DENSITY | DECL | FRZ | YR | CONSRV |
| 1 | 000100 | C | SFR | 100 | | | 0.00 | 0.00 | 1.00 | LT | | 1.00 | 1.00 | 1.00 | 20,000.00 | 20,000.00 | 20,000 | | | | | | | |