

BUILDING CHARACTERISTICS		CONSTRUCTION	
ELEMENT	CD		
Foundation	01	WOOD FRAME	100
Frame	02	WOOD FRAME	100
Exterior Wall	30	VINYL	100
Roof Structur	03	GABLE/HIP	100
Roof Cover	03	COMP SHNGL	100
Interior Wall	05	DRYWALL	100
Interior Floo	08	SHT VINYL	50
Interior Floo	14	CARPET	50
Heating Type	04	AIR DUCTED	100
Air Condition	03	CENTRAL	100
Bedrooms		2	100
Bathrooms		2	100
Stories	1.	1.	100
Class	00	N/A	100
Units		0	100
Quality	08	FAIR	
DOR CODE	0200	MOBILE HOME	
MAP NUM	4	MKT AREA	04
NEIGHBORHOOD/LOC	000	1.00/	
AREA TYPE	TOTAL GROSS AREA	PCT OF BASE	YEAR
BAS	1,294	100	2004
DCK	852	10	2004
TOTALS	2,146		

MARKET ADJUSTMENTS											
TYPE	MDL	EFF. AREA	TOT ADJ PTS	EFF. BASE RATE	REPL. COST NEW	AYB	EYB	ECON	FNCT	NORM	% COND
1	MOBILE HOM	100%	- 2008								
				Heated Area: 1294			HX Base Yr 2008				

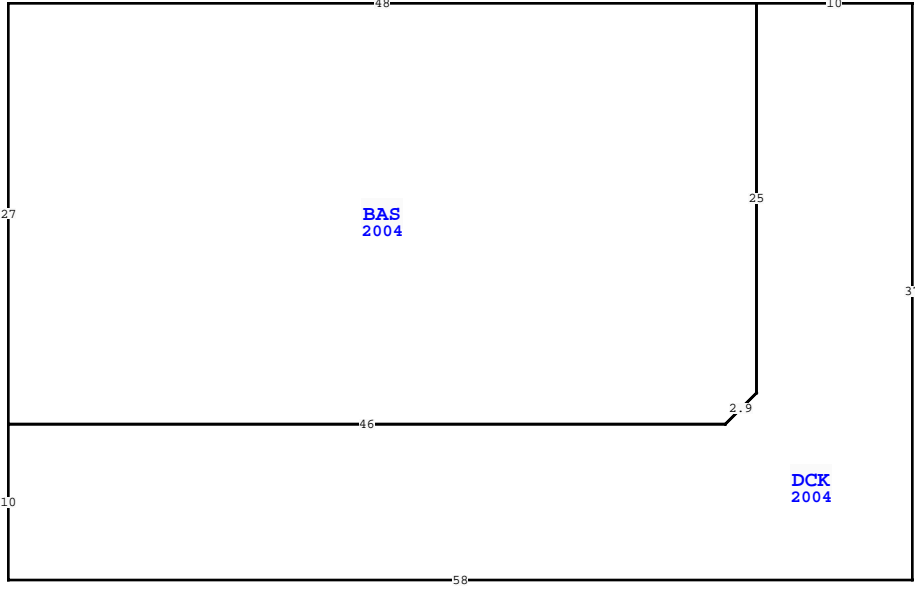

WAKULLA COUNTY PROPERTY			
VALUATION SUMMARY			PAGE 1 of 1
VALUATION BY			STANDARD
Tax Group: 3	Tax Dist:		
BUILDING MARKET VALUE			60,601
TOTAL MARKET OB/XF VALUE			1,680
TOTAL LAND VALUE - MARKET			10,000
TOTAL MARKET VALUE			72,281
SOH/AGL Deduction			23,541
ASSESSED VALUE			48,740
TOTAL EXEMPTION VALUE	HX HB SX		48,740
BASE TAXABLE VALUE			0
TOTAL JUST VALUE			72,281
NCON VALUE			0
INCOME VALUE			
PREVIOUS YEAR MKT VALUE			54,954
2021 SX RENEWAL COMPLETED			
2020 SX RENEWAL COMPLETED			
2018 SX RNWL COMPLETED			
5 YR PRCL CK, N/C			
PERMIT NUM	DESCRIPTION	AMT	ISSUED
19000138	REROOF-CO	0	03/12/2019
31418	MECH	0	02/25/2004
31324	DWMH	0	02/05/2004

SALES DATA						
OFF RECORD Number	DATE	TYPE INST	Q / U	V / I	RSN CD	SALE PRICE
0706/0551	4/16/2007	WD	U	V		115,000
GRANTOR: WILLIAMS DENZEL & DEB						
GRANTEE: ROBERTS JEAN PIERRE						
0706/0549	4/04/2007	QC	Q	V	01	100
GRANTOR: DANIELS MARY						
GRANTEE: WILLIAMS DENZEL & D						

EXTRA FEATURES																
L N	OB/XF CODE	DESCRIPTION	BLD CAP	L	W	UNITS	UT	Adj R	ADJ UNIT PRICE	ORIG COND	YEAR ON	YEAR ACTUAL	Q	% COND	OB/XF MKT VALUE	NOTES
1	0700	PORT BLDG	0	100	20	10			8.00	100	2006	2006	3	66	1,056	
2	0055	PORTABLE C	0	100	20	20			3.00	100	2012	2012	3	52	624	

BLD DATE		03/29/2019	MMSS	LGL DATE		03/29/2019	MMSS
XF DATE		03/29/2019	MMSS	LAND DATE		03/29/2019	MMSS
INC DATE				AG DATE			
20 IDA ST, PANACEA							

BUILDING NOTES									
DCK=[YR=2004] W10 BAS=[YR=2004] W48 S27 E46 R2 U2 N25\$ S25 D2 L2 W46 S10 E58 N37\$.									

LAND DESCRIPTION										TOTAL OB/XF														
L N	USE CODE	CLS	LAND USE DESCRIPTION	CAP	R D	LOC ZONE	FRONT	DEPTH	TOT LND UTS	UNIT TYPE	D T	DPH FACT	% COND	TOT ADJ	UNIT PRICE	ADJ UNIT PRICE	LAND VALUE	OTHER ADJUSTMENTS AND NOTES	YEAR	DENSITY	DECL	FRZ	YR	CONSRV
1	000201	C	MH	100		RSU1	0.00	0.00	1.00	LT		1.00	1.00	1.00	10,000.00	10,000.00	10,000							