

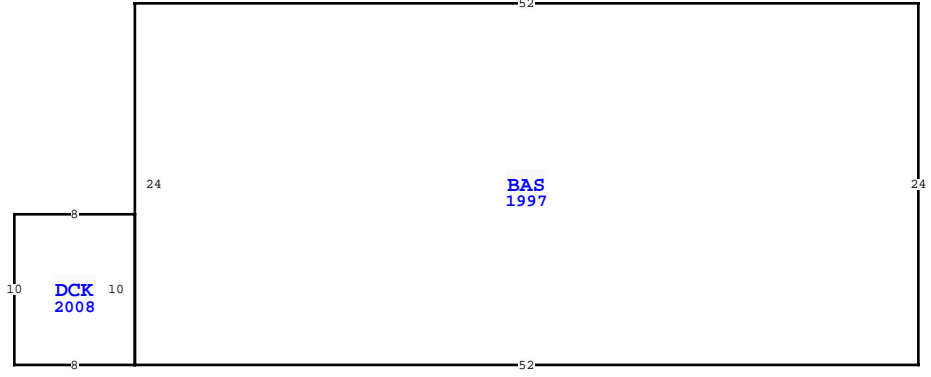

| ELEMENT | | CD | | CONSTRUCTION | |
|------------------|------------------|-------------|-------|--------------|----------------------|
| Foundation | 01 | WOOD | FRAME | 100 | |
| Frame | 02 | WOOD | FRAME | 100 | |
| Exterior Wall | 30 | VINYL | 100 | | |
| Roof Structur | 03 | GABLE/HIP | 100 | | |
| Roof Cover | 13 | GALVALUM | 100 | | |
| Interior Wall | 05 | DRYWALL | 100 | | |
| Interior Floo | 08 | SHT VINYL | 50 | | |
| Interior Floo | 14 | CARPET | 50 | | |
| Heating Type | 04 | AIR DUCTED | 100 | | |
| Air Condition | 03 | CENTRAL | 100 | | |
| Bedrooms | | | 3 | 100 | |
| Bathrooms | | | 2 | 100 | |
| Stories | 1. | | 1. | 100 | |
| Class | 00 | N/A | 100 | | |
| Units | | | 0 | 100 | |
| Quality | 03 | AVERAGE | | | |
| DOR CODE | 0200 | MOBILE HOME | | | |
| MAP NUM | 5 | MKT AREA | | 08 | |
| NEIGHBORHOOD/LOC | 000 | 1.00/ | | | |
| AREA TYPE | TOTAL GROSS AREA | PCT OF BASE | YEAR | TOT ADJ AREA | SUBAREA MARKET VALUE |
| BAS | 1,248 | 100 | 1997 | 1,248 | 52,599 |
| DCK | 80 | 10 | 2008 | 8 | 337 |
| TOTALS | 1,328 | | | 1,256 | 52,937 |

| MARKET ADJUSTMENTS | | | | | | | | | | | |
|--|-----|-----------|-------------|----------------|----------------|------|------|------|------|-------|--------|
| TYPE | MDL | EFF. AREA | TOT ADJ PTS | EFF. BASE RATE | REPL. COST NEW | AYB | EYB | ECON | FNCT | NORM | % COND |
| 0200 | 02 | 1,256 | 111.5000 | 78.05 | 98,031 | 1997 | 1997 | 0 | 0 | 46.00 | 54.00 |
| 1 MOBILE HOM 100% - 2016 Heated Area: 1248 HX Base Yr 2016 | | | | | | | | | | | |



| WAKULLA COUNTY PROPERTY | | | |
|--|------------------|--------------|-------------|
| VALUATION SUMMARY | | | PAGE 1 of 1 |
| VALUATION BY | | STANDARD | |
| Tax Group: 3 | | Tax Dist: | |
| BUILDING MARKET VALUE | | 52,937 | |
| TOTAL MARKET OB/XF VALUE | | 9,433 | |
| TOTAL LAND VALUE - MARKET | | 10,000 | |
| TOTAL MARKET VALUE | | 72,370 | |
| SOH/AGL Deduction | | 19,545 | |
| ASSESSED VALUE | | 52,825 | |
| TOTAL EXEMPTION VALUE | | HX HB 27,825 | |
| BASE TAXABLE VALUE | | 25,000 | |
| TOTAL JUST VALUE | | 72,370 | |
| NCON VALUE | | 0 | |
| INCOME VALUE | | | |
| PREVIOUS YEAR MKT VALUE | | 62,066 | |
| MM 5 YR CK, CORR XFOB DIMES, PU XFOBS. | | | |
| 5 YR PRCL CK, CHG RCVR | | | |
| 5 YR PRCL SH, PU XFOB LN 8 | | | |
| 4-7 | | | |
| PERMIT NUM | DESCRIPTION | AMT | ISSUED |
| 2009480 | UTL BLDG (22X16) | 0 | 06/08/2009 |
| 022470 | N/A | 0 | 07/08/1997 |
| 021489 | N/A | 0 | 10/17/1996 |

| SALES DATA | | | | | | |
|--------------------------------|-----------|-----------|-------|-------|--------|------------|
| OFF RECORD Number | DATE | TYPE INST | Q / U | V / I | RSN CD | SALE PRICE |
| 0972/0811 | 6/10/2015 | WD Q | I | | 01 | 50,000 |
| GRANTOR: GREEN PATRICK & CLARA | | | | | | |
| GRANTEE: PACKETT JAMES MATH | | | | | | |
| 0350/0668 | 4/15/1999 | WD U | I | | | 100 |
| GRANTOR: GREEN PATRICK | | | | | | |
| GRANTEE: | | | | | | |

| EXTRA FEATURES | | | | | | | | | | | | | | | | | |
|----------------|------------|-------------|-----|-----|----|----|----------|----|-------|----------------|-----------|---------|-------------|---|--------|-----------------|-------|
| L N | OB/XF CODE | DESCRIPTION | BLD | CAP | L | W | UNITS | UT | Adj R | ADJ UNIT PRICE | ORIG COND | YEAR ON | YEAR ACTUAL | Q | % COND | OB/XF MKT VALUE | NOTES |
| 1 | 0630 | METAL UTL | 0 | 100 | 38 | 20 | 760.00 | SF | 8.00 | 8.00 | 100 | 1996 | 1996 | 3 | 20 | 1,216 | |
| 2 | 0955 | PRIVACY FE | 0 | 100 | 0 | 0 | 100.00 | LF | 15.00 | 15.00 | 100 | 1998 | 1998 | 3 | 0 | 0 | |
| 3 | 0210 | CONCRETE D | 0 | 100 | 57 | 24 | 1,368.00 | SF | 6.00 | 6.00 | 100 | 1998 | 1998 | 3 | 20 | 1,642 | |
| 4 | 0620 | WOOD UTL B | 0 | 100 | 15 | 13 | 195.00 | SF | 6.00 | 6.00 | 100 | 1999 | 1999 | 3 | 20 | 234 | |
| 5 | 0100 | 6" CHAINLI | 0 | 100 | 0 | 0 | 125.00 | LF | 19.00 | 19.00 | 100 | 1998 | 1998 | 3 | 20 | 475 | |
| 6 | 0025 | BARN, POLE | 0 | 100 | 24 | 24 | 576.00 | SF | 12.50 | 12.50 | 100 | 2009 | 2009 | 3 | 39 | 2,808 | |
| 7 | 0100 | 6" CHAINLI | 0 | 100 | 0 | 0 | 118.00 | LF | 19.00 | 19.00 | 100 | 2008 | 2008 | 3 | 34 | 762 | |
| 8 | 0055 | PORTABLE C | 0 | 100 | 20 | 12 | 240.00 | SF | 3.00 | 3.00 | 100 | 2009 | 2009 | 3 | 39 | 281 | |
| 9 | 0210 | CONCRETE D | 0 | 100 | 24 | 18 | 432.00 | SF | 6.00 | 6.00 | 100 | 2014 | 2014 | 3 | 62 | 1,607 | |
| 10 | 0940 | OPEN SHED | 0 | 100 | 15 | 8 | 120.00 | SF | 4.00 | 4.00 | 100 | 2019 | 2019 | 3 | 85 | 408 | |

| TOTAL OB/XF | | | | | | | | | | | |
|----------------------------|------------|-------|-----------|-----------------|--|--|--|--|--|--|--|
| BLD DATE | 02/05/2018 | MMJTT | LGL DATE | | | | | | | | |
| XF DATE | 02/05/2018 | MMJTT | LAND DATE | 10/17/2012 MMSR | | | | | | | |
| INC DATE | | | AG DATE | | | | | | | | |
| 28 ATLEE LN, CRAWFORDVILLE | | | | | | | | | | | |

| BUILDING NOTES | | | |
|----------------|--|--|--|
| | | | |

| BUILDING DIMENSIONS | | | |
|--|--|--|--|
| BAS=[YR=1997] W52 S24 DCK=[YR=2008] N10 W8 S10 E8\$ E52 N24\$. | | | |

| LAND DESCRIPTION | | | | | | | | | | | | TOTAL OB/XF | | | | | | | | | | | | |
|------------------|----------|-----|----------------------|-----|-----|----------|-------|-------|-------------|-----------|-----|-------------|--------|---------|------------|----------------|------------|-----------------------------|------|---------|------|-----|----|--------|
| L N | USE CODE | CLS | LAND USE DESCRIPTION | CAP | R D | LOC ZONE | FRONT | DEPTH | TOT LND UTS | UNIT TYPE | D T | DPHT FACT | % COND | TOT ADJ | UNIT PRICE | ADJ UNIT PRICE | LAND VALUE | OTHER ADJUSTMENTS AND NOTES | YEAR | DENSITY | DECL | FRZ | YR | CONSRV |
| 1 | 000201 | C | MH | 100 | | | 0.00 | 0.00 | 2.00 | LT | | 1.00 | 1.00 | 1.00 | 5,000.00 | 5,000.00 | 10,000 | | | | | | | |