

| BUILDING CHARACTERISTICS | | CONSTRUCTION | |
|--------------------------|------------------|----------------|------|
| ELEMENT | CD | | |
| Foundation | 02 | CONCR SLAB 100 | |
| Frame | 03 | MASONRY 100 | |
| Exterior Wall | 15 | CONC BLOCK 100 | |
| Roof Structur | | N/A 100 | |
| Roof Cover | 13 | GALVALUM 100 | |
| Interior Wall | 01 | MINIMUM 50 | |
| Interior Wall | 03 | PLASTER 50 | |
| Interior Floo | 11 | CLAY TILE 50 | |
| Interior Floo | 14 | CARPET 50 | |
| Ceiling | 01 | FIN.SUSPD 100 | |
| Heating Type | 09 | ENG F AIR 100 | |
| Air Condition | 06 | ENG CENTRL 100 | |
| Fixtures | | 9 100 | |
| Story Height | | 0 100 | |
| RMS | | 1 100 | |
| Stories | 1. | 1. 100 | |
| Class | 00 | N/A 100 | |
| Units | | 0 100 | |
| Quality | 08 | FAIR | |
| DOR CODE | 8230 | COUNTY PARK | |
| MAP NUM | 4 | MKT AREA | 04 |
| NEIGHBORHOOD/LOC | 000 | 1.00/ | |
| AREA TYPE | TOTAL GROSS AREA | PCT OF BASE | YEAR |
| BAS | 2,400 | 100 | 1993 |
| CAN | 468 | 30 | 2002 |
| FST | 108 | 45 | 2002 |
| TOTALS | 2,976 | | |

| MARKET ADJUSTMENTS | | | | | | | | | | | | | |
|--|-----|-----------|-------------|----------------|----------------|------|------|------|------|------|--------|-------|--|
| TYPE | MDL | EFF. AREA | TOT ADJ PTS | EFF. BASE RATE | REPL. COST NEW | AYB | EYB | ECON | FNCT | NORM | % COND | | |
| 8602 | 04 | 2,589 | 74.4822 | 81.93 | 212,117 | 1964 | 2010 | | 0 | 0 | 16.00 | 84.00 | |
| 1 COUNTY BLD 0% - 0 Heated Area: 2400 HX Base Yr | | | | | | | | | | | | | |

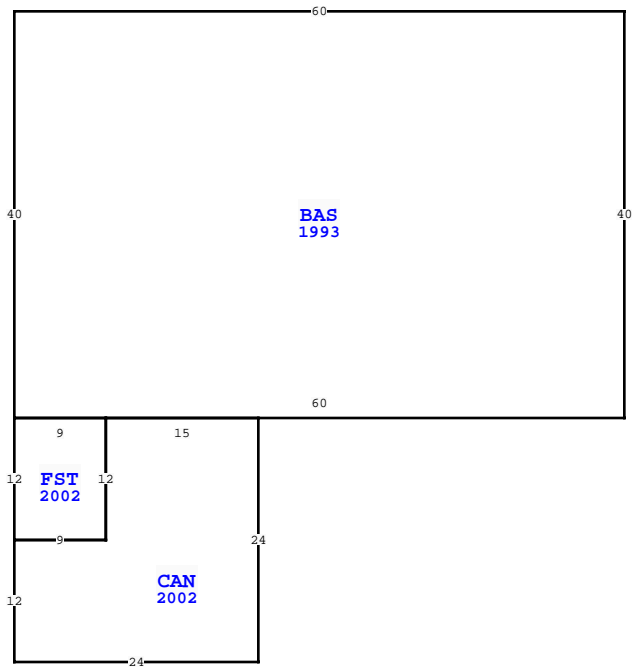

| WAKULLA COUNTY PROPERTY | | | |
|--|--------------|----------|-------------|
| VALUATION SUMMARY | | | PAGE 1 of 1 |
| VALUATION BY | | STANDARD | |
| Tax Group: 3 | Tax Dist: | | |
| BUILDING MARKET VALUE | | | 178,178 |
| TOTAL MARKET OB/XF VALUE | | | 20,196 |
| TOTAL LAND VALUE - MARKET | | | 15,000 |
| TOTAL MARKET VALUE | | | 213,374 |
| SOH/AGL Deduction | | | 87,700 |
| ASSESSED VALUE | | | 125,674 |
| TOTAL EXEMPTION VALUE | 03 | 125,674 | |
| BASE TAXABLE VALUE | | | 0 |
| TOTAL JUST VALUE | | | 213,374 |
| NCON VALUE | | | 0 |
| INCOME VALUE | | | |
| PREVIOUS YEAR MKT VALUE | | | 218,523 |
| COMPLETE INT RENO CK DOCS, PU XFOB LNS 5-8 | | | |
| 5 YR PRCL CH, CORR CODE XFOB LN 4 | | | |
| 5 YR PRCL CK, N/C | | | |
| CORR TRAV, CORR SF XFOB LN 3, PU XFOB LN 4 | | | |
| PERMIT NUM | DESCRIPTION | AMT | ISSUED |
| 21000620 | RENOVATIONS | 0 | 06/14/2021 |
| 21000411 | POLE BARN-CO | 0 | 05/19/2021 |
| 201061 | RE-ROOF | 0 | 02/05/2010 |
| 29241 | ELECT | 0 | 07/15/2002 |
| 29032 | REMO | 0 | 05/15/2002 |

| SALES DATA | | | | | | |
|-------------------------|-----------|-----------|-----|-----|--------|------------|
| OFF RECORD Number | DATE | TYPE INST | Q U | V I | RSN CD | SALE PRICE |
| 0430/0476 | 1/07/2002 | WD | U | I | | 100 |
| GRANTOR: WAKULLA COUNTY | | | | | | |
| GRANTEE: | | | | | | |

| EXTRA FEATURES | | | | | | | | | | | | | | | | | |
|----------------|------------|-------------|-----|-----|----|----|----------|----|-------|----------------|-----------|---------|-------------|--------|--------|-----------------|-------|
| L N | OB/XF CODE | DESCRIPTION | BLD | CAP | L | W | UNITS | UT | Adj R | ADJ UNIT PRICE | ORIG COND | YEAR ON | YEAR ACTUAL | Q | % COND | OB/XF MKT VALUE | NOTES |
| 1 | 0210 | CONCRETE D | 0 | 0 | 20 | 17 | 340.00 | SF | 6.00 | 6.00 | 100 | 2002 | 2002 | 3 | 20 | 408 | |
| 2 | 0080 | 4' CHAINLI | 0 | 0 | 0 | 0 | 88.00 | LF | 13.00 | 13.00 | 100 | 2002 | 2002 | 3 | 20 | 229 | |
| 3 | 0250 | ASPHALT AV | 0 | 0 | 50 | 44 | 7,694.00 | SF | 2.00 | 2.00 | 100 | 2002 | 2002 | 3 | 20 | 3,078 | |
| 4 | 0250 | ASPHALT AV | 0 | 0 | 98 | 52 | 5,096.00 | SF | 2.00 | 2.00 | 100 | 2002 | 2002 | 3 | 20 | 2,038 | |
| 5 | 0100 | 6" CHAINLI | 0 | 0 | 0 | 0 | 200.00 | LF | 19.00 | 19.00 | 100 | 2021 | 2021 | 3 | 93 | 3,534 | |
| 6 | 0211 | CONCRETE W | 0 | 0 | 83 | 5 | 415.00 | SF | 6.00 | 6.00 | 100 | 2021 | 2021 | 3 | 93 | 2,316 | |
| 7 | 0025 | BARN,POLE | 0 | 0 | 24 | 24 | 576.00 | SF | 12.50 | 12.50 | 100 | 2021 | 2021 | 3 | 93 | 6,696 | |
| 8 | 0210 | CONCRETE D | 0 | 0 | 20 | 17 | 340.00 | SF | 6.00 | 6.00 | 100 | 2021 | 2021 | 3 | 93 | 1,897 | |
| TOTALS | | | | | | | | | | | | | | 20,196 | | | |

| LAND DESCRIPTION | | | | | | | | | | | | | | TOTAL OB/XF | | | | | | | | | | |
|------------------|----------|-----|----------------------|-----|-----|----------|-------|-------|-------------|-----------|-----|----------|--------|-------------|------------|----------------|------------|-----------------------------|------|---------|------|-----|----|--------|
| L N | USE CODE | CLS | LAND USE DESCRIPTION | CAP | R D | LOC ZONE | FRONT | DEPTH | TOT LND UTS | UNIT TYPE | D T | DPH FACT | % COND | TOT ADJ | UNIT PRICE | ADJ UNIT PRICE | LAND VALUE | OTHER ADJUSTMENTS AND NOTES | YEAR | DENSITY | DECL | FRZ | YR | CONSRV |
| 1 | 008210 | C | PARK | 0 | | | 0.00 | 0.00 | 1.00 | AC | | 1.00 | 1.00 | 1.00 | 15,000.00 | 15,000.00 | 15,000 | | | | | | | |