

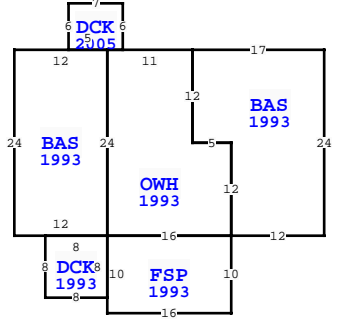

| ELEMENT        | CD | CONSTRUCTION   |
|----------------|----|----------------|
| Foundation     | 04 | PILE WOOD 100  |
| Frame          | 02 | WOOD FRAME 100 |
| Exterior Wall  | 08 | WD ON PLY 100  |
| Roof Structur  | 03 | GABLE/HIP 100  |
| Roof Cover     | 03 | COMP SHNGL 100 |
| Interior Wall  | 05 | DRYWALL 100    |
| Interior Floor | 14 | CARPET 50      |
| Interior Floor | 15 | HARDTILE 50    |
| Heating Type   | 04 | AIR DUCTED 100 |
| Air Condition  | 03 | CENTRAL 100    |
| Bedrooms       |    | 3 100          |
| Bathrooms      |    | 2 100          |
| Story Height   |    | 0 100          |
| Stories        | 1. | 1. 100         |
| Units          |    | 0 100          |

| MARKET ADJUSTMENTS |            |           |                  |                |                |      |                 |      |      |       |        |  |
|--------------------|------------|-----------|------------------|----------------|----------------|------|-----------------|------|------|-------|--------|--|
| TYPE               | MDL        | EFF. AREA | TOT ADJ PTS      | EFF. BASE RATE | REPL. COST NEW | AYB  | EYB             | ECON | FNCT | NORM  | % COND |  |
| 1                  | SINGLE FAM | 100%      | - 2018           |                | 129,969        | 1989 | 1989            | 0    | 0    | 34.00 | 66.00  |  |
|                    |            |           | Heated Area: 960 |                |                |      | HX Base Yr 2018 |      |      |       |        |  |



| Quality          | 08               | FAIR          |      |              |                      |
|------------------|------------------|---------------|------|--------------|----------------------|
| DOR CODE         | 0100             | SINGLE FAMILY |      |              |                      |
| MAP NUM          | 4                | MKT AREA 04   |      |              |                      |
| NEIGHBORHOOD/LOC | 161.00           | 1.00/         |      |              |                      |
| AREA TYPE        | TOTAL GROSS AREA | PCT OF BASE   | YEAR | TOT ADJ AREA | SUBAREA MARKET VALUE |
| BAS              | 288              | 100           | 1993 | 288          | 21,371               |
| BAS              | 348              | 100           | 1993 | 348          | 25,823               |
| DCK              | 64               | 10            | 1993 | 6            | 446                  |
| DCK              | 42               | 10            | 2005 | 4            | 297                  |
| FSP              | 160              | 55            | 1993 | 88           | 6,530                |
| OWH              | 324              | 100           | 1993 | 324          | 24,042               |
| PCP              | 984              | 10            | 2017 | 98           | 7,272                |
| TOTALS           | 2,210            |               |      | 1,156        | 85,780               |

| EXTRA FEATURES |            |             |         |     |   |       |    |       |                |           |         |             |   |        |                 |       |
|----------------|------------|-------------|---------|-----|---|-------|----|-------|----------------|-----------|---------|-------------|---|--------|-----------------|-------|
| L N            | OB/XF CODE | DESCRIPTION | BLD CAP | L   | W | UNITS | UT | Adj R | ADJ UNIT PRICE | ORIG COND | YEAR ON | YEAR ACTUAL | Q | % COND | OB/XF MKT VALUE | NOTES |
| 2              | 0700       | PORT BLDG   | 0       | 100 | 8 | 10    |    |       | 8.00           | 100       | 2003    | 2003        | 3 | 60     | 384             |       |

|          |            |      |           |            |
|----------|------------|------|-----------|------------|
| BLD DATE | 07/09/2018 | MMLC | LGL DATE  |            |
| XF DATE  | 07/09/2018 | MMLC | LAND DATE | 02/25/2013 |
| INC DATE |            |      | AG DATE   |            |

6 LUCY LN, PANACEA

| WAKULLA COUNTY PROPERTY                  |             |        |             |
|--|-------------|--------|-------------|
| VALUATION SUMMARY                        |             |        | PAGE 1 of 1 |
| VALUATION BY                             |             |        | STANDARD    |
| Tax Group: 3                             | Tax Dist:   |        |             |
| BUILDING MARKET VALUE                    |             |        | 85,780      |
| TOTAL MARKET OB/XF VALUE                 |             |        | 384         |
| TOTAL LAND VALUE - MARKET                |             |        | 5,000       |
| TOTAL MARKET VALUE                       |             |        | 91,164      |
| SOH/AGL Deduction                        |             |        | 0           |
| ASSESSED VALUE                           |             |        | 91,164      |
| TOTAL EXEMPTION VALUE                    | HX HB       | 50,000 |             |
| BASE TAXABLE VALUE                       |             |        | 41,164      |
| TOTAL JUST VALUE                         |             |        | 91,164      |
| NCON VALUE                               |             |        | 0           |
| INCOME VALUE                             |             |        |             |
| PREVIOUS YEAR MKT VALUE                  |             |        | 184,457     |
| MM 5YR CK NC                             |             |        |             |
| 5 YR PRCL CK, PU NEW TRAV                |             |        |             |
| ADDED HX FOR 2018                        |             |        |             |
| LEFT MESSAGE NEED ADDTNL INFO FOR HX APP |             |        |             |
| PERMIT NUM                               | DESCRIPTION | AMT    | ISSUED      |
| 17000206                                 | REROOF-CO   | 0      | 02/14/2017  |

| SALES DATA                     |           |           |     |     |        |            |
|--------------------------------|-----------|-----------|-----|-----|--------|------------|
| OFF RECORD Number              | DATE      | TYPE INST | Q U | V I | RSN CD | SALE PRICE |
| 1026/0079                      | 2/16/2017 | WD Q      | Q   | I   | 01     | 87,000     |
| GRANTOR: ABRAHAM, BARRY TRUSTE |           |           |     |     |        |            |
| GRANTEE: HAMILTON JUDSON HEN   |           |           |     |     |        |            |
| 0967/0714                      | 3/27/2015 | WD U      | U   | I   | 11     | 0          |
| GRANTOR: PETRANDIS THOMAS & JE |           |           |     |     |        |            |
| GRANTEE: ABRAHAM, BARRY TRUS   |           |           |     |     |        |            |

| BUILDING NOTES |
|----------------|
|                |

| BUILDING DIMENSIONS   |
|---|
| BAS=[YR=1993] W17 S12 E5 S12 OWH=[YR=1993] N12 W5 N12 W11 S24<br>FSP=[YR=1993] S10 E16 N10 W16\$ DCK=[YR=1993] W8 S8 E8 N8\$<br>BAS=[YR=1993] N24 DCK=[YR=2005] E2 N6 W7 S6 E5\$ W12 S24 E12\$<br>E16\$ E12 PTR=S20 PCP=[YR=2017] W36 S24 E12 S10 E12 N10 E12<br>N24\$ N20\$ N24\$. |

| LAND DESCRIPTION | TOTAL OB/XF |     |                      |     |     |          |       |       |             |           |     |          |        |         |            |                |            |                             |      |         |      |     |    |        |
|------------------|-------------|-----|----------------------|-----|-----|----------|-------|-------|-------------|-----------|-----|----------|--------|---------|------------|----------------|------------|-----------------------------|------|---------|------|-----|----|--------|
|                  | 384         |     |                      |     |     |          |       |       |             |           |     |          |        |         |            |                |            |                             |      |         |      |     |    |        |
| L N              | USE CODE    | CLS | LAND USE DESCRIPTION | CAP | R D | LOC ZONE | FRONT | DEPTH | TOT LND UTS | UNIT TYPE | D T | DPH FACT | % COND | TOT ADJ | UNIT PRICE | ADJ UNIT PRICE | LAND VALUE | OTHER ADJUSTMENTS AND NOTES | YEAR | DENSITY | DECL | FRZ | YR | CONSRV |
| 1                | 000100      | C   | SFR                  | 100 |     |          | 0.00  | 0.00  | 1.00        | LT        |     | 1.00     | 1.00   | 0.50    | 10,000.00  | 5,000.00       | 5,000      |                             |      |         |      |     |    |        |