

| ELEMENT | | CD | CONSTRUCTION | | |
|------------------|------------------|---------------|--------------|--------------|----------------------|
| Foundation | 02 | CONCR | SLAB | 100 | |
| Frame | 03 | MASONRY | 100 | | |
| Exterior Wall | 30 | VINYL | 100 | | |
| Roof Structur | 03 | GABLE/HIP | 100 | | |
| Roof Cover | 13 | GALVALUM | 100 | | |
| Interior Wall | 02 | WALL | BD/WD | 100 | |
| Interior Floo | 09 | PINE WOOD | 50 | | |
| Interior Floo | 14 | CARPET | 50 | | |
| Heating Type | 04 | AIR DUCTED | 100 | | |
| Air Condition | 03 | CENTRAL | 100 | | |
| Bedrooms | | | 3 | 100 | |
| Bathrooms | | | 2 | 100 | |
| Story Height | | | 0 | 100 | |
| Stories | 1. | | 1. | 100 | |
| Units | | | 0 | 100 | |
| Quality | 03 | AVERAGE | | | |
| DOR CODE | 5000 | IMPRVD AG RES | | | |
| MAP NUM | 2 | MKT AREA | | 11 | |
| NEIGHBORHOOD/LOC | 000 | 1.00/ | | | |
| AREA TYPE | TOTAL GROSS AREA | PCT OF BASE | YEAR | TOT ADJ AREA | SUBAREA MARKET VALUE |
| BAS | 1,400 | 100 | 1968 | 1,400 | 58,086 |
| BAS | 276 | 100 | 2004 | 276 | 11,451 |
| FCP | 380 | 25 | 1968 | 95 | 3,942 |
| FEP | 324 | 80 | 2007 | 259 | 10,746 |
| FOP | 80 | 30 | 1968 | 24 | 996 |
| FOP | 228 | 30 | 2004 | 68 | 2,822 |
| UST | 152 | 45 | 1968 | 68 | 2,822 |
| TOTALS | 2,840 | | | 2,190 | 90,863 |

| MARKET ADJUSTMENTS | | | | | | | | | | | |
|---|-----|-----------|-------------|----------------|----------------|------|------|------|------|-------|--------|
| TYPE | MDL | EFF. AREA | TOT ADJ PTS | EFF. BASE RATE | REPL. COST NEW | AYB | EYB | ECON | FNCT | NORM | % COND |
| 0100 | 01 | 2,190 | 97.0500 | 92.20 | 201,918 | 1968 | 1968 | 0 | 0 | 55.00 | 45.00 |
| 1 SINGLE FAM 0% - 2024 Heated Area: 1935 HX Base Yr | | | | | | | | | | | |

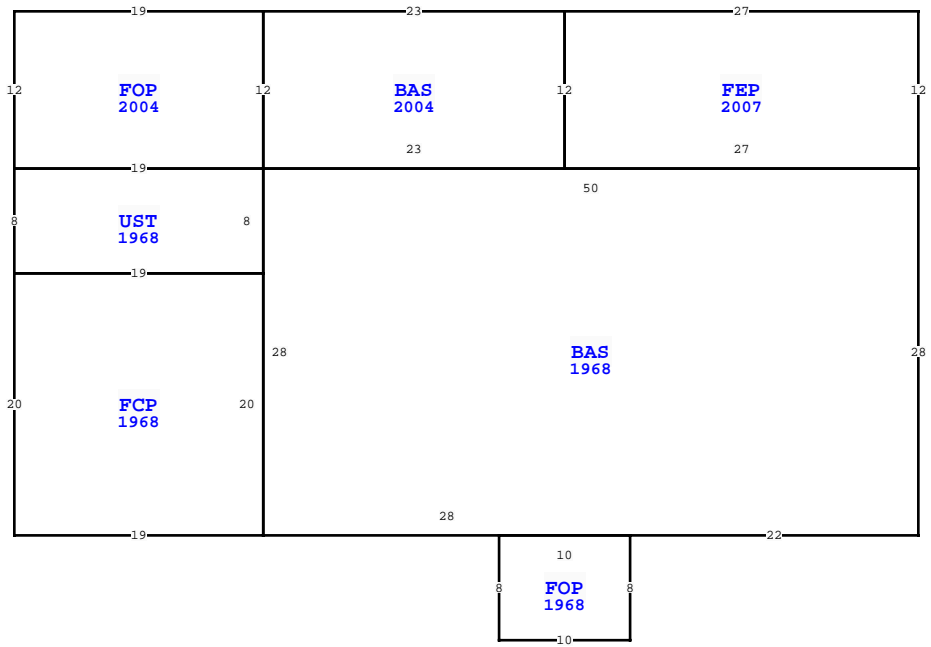

| WAKULLA COUNTY PROPERTY | | | |
|---------------------------|--|-----------|-------------|
| VALUATION SUMMARY | | | PAGE 1 of 1 |
| VALUATION BY | | STANDARD | |
| Tax Group: 3 | | Tax Dist: | |
| BUILDING MARKET VALUE | | 90,863 | |
| TOTAL MARKET OB/XF VALUE | | 14,365 | |
| TOTAL LAND VALUE - MARKET | | 82,500 | |
| TOTAL MARKET VALUE | | 123,153 | |
| SOH/AGL Deduction | | 0 | |
| ASSESSED VALUE | | 123,153 | |
| TOTAL EXEMPTION VALUE | | 0 | |
| BASE TAXABLE VALUE | | 123,153 | |
| TOTAL JUST VALUE | | 187,728 | |
| NCON VALUE | | 0 | |
| INCOME VALUE | | 0 | |
| PREVIOUS YEAR MKT VALUE | | 122,850 | |

| 2024 AG APP RECVD APPRVD | | | |
|---|-------------|-----|------------|
| 1/31/24 - AG AUTO RENEW ERROR LETTER MAILED | | | |
| PER BNDRY ADJ/LAND DIVISION | | | |
| S/O 24.31 AC TO NEW PRCL 01421-004 | | | |
| PERMIT NUM | DESCRIPTION | AMT | ISSUED |
| 2010900 | RE ROOF | 0 | 08/26/2010 |
| 30472 | CONS SHED | 0 | 07/02/2003 |

| SALES DATA | | | | | | |
|--------------------------------|-----------|-----------|-------|-------|--------|------------|
| OFF RECORD Number | DATE | TYPE INST | Q / U | V / I | RSN CD | SALE PRICE |
| 1315/0413 | 6/03/2023 | WD | U | I | 30 | 100 |
| GRANTOR: FRANKLIN KEITH LAFAYE | | | | | | |
| GRANTEE: FRANKLIN KEITH L & | | | | | | |
| 1312/0857 | 5/16/2023 | OR | U | I | 30 | 100 |
| GRANTOR: ESTATE OF JAMES FRANK | | | | | | |
| GRANTEE: FRANKLIN KEITH LAFAYE | | | | | | |

| EXTRA FEATURES | | | | | | | | | | | | | | | | |
|----------------|------------|-------------|---------|---|----|-------|----|-------|----------------|-----------|---------|-------------|---|--------|-----------------|-------|
| L N | OB/XF CODE | DESCRIPTION | BLD CAP | L | W | UNITS | UT | Adj R | ADJ UNIT PRICE | ORIG COND | YEAR ON | YEAR ACTUAL | Q | % COND | OB/XF MKT VALUE | NOTES |
| 1 | 0020 | BARN, FRAME | 0 | 0 | 35 | 20 | | | 12.00 | 100 | 1980 | 1980 | 3 | 20 | 1,680 | |
| 2 | 0940 | OPEN SHED | 0 | 0 | 39 | 21 | | | 4.00 | 100 | 1980 | 1980 | 3 | 20 | 655 | |
| 3 | 0080 | 4' CHAINLI | 0 | 0 | 0 | 0 | | | 13.00 | 100 | 2002 | 2002 | 3 | 20 | 645 | |
| 4 | 0620 | WOOD UTL B | 0 | 0 | 24 | 12 | | | 6.00 | 100 | 2003 | 2003 | 3 | 21 | 363 | |
| 5 | 0211 | CONCRETE W | 0 | 0 | 12 | 6 | | | 6.00 | 100 | 1975 | 1975 | 3 | 20 | 86 | |
| 6 | 0130 | FIRE PLACE | 0 | 0 | 0 | 0 | | | 1,300.00 | 100 | 1968 | 1968 | 3 | 20 | 260 | |
| 7 | 0770 | PUMP HOUSE | 0 | 0 | 6 | 4 | | | 5.00 | 100 | 2003 | 2003 | 3 | 0 | 0 | |
| 8 | 0630 | METAL UTL | 0 | 0 | 8 | 8 | | | 8.00 | 100 | 1980 | 1980 | 3 | 20 | 102 | |
| 9 | 0210 | CONCRETE D | 0 | 0 | 46 | 29 | | | 6.00 | 100 | 2009 | 2009 | 3 | 39 | 3,122 | |
| 10 | 0050 | CARPORT UN | 0 | 0 | 46 | 25 | | | 9.00 | 100 | 2009 | 2009 | 3 | 72 | 7,452 | |

| TOTAL OB/XF | | | | | | | | | |
|-------------|------------|------|-----------|------------|--|--|--|--|--|
| 14,365 | | | | | | | | | |
| BLD DATE | 01/31/2017 | MMSR | LGL DATE | | | | | | |
| XF DATE | 01/31/2017 | MMSR | LAND DATE | 01/31/2017 | | | | | |
| INC DATE | | | AG DATE | | | | | | |

| BUILDING NOTES | | | | | | | | | |
|----------------|--|--|--|--|--|--|--|--|--|
| | | | | | | | | | |

| BUILDING DIMENSIONS | | | | | | | | | |
|---|--|--|--|--|--|--|--|--|--|
| FEP=[YR=2007] W27 S12 E27 BAS=[YR=1968] W50 S28 | | | | | | | | | |
| FCP=[YR=1968] N20 W19 UST=[YR=1968] E19 N8 W19 FOP=[YR=2004] E19 N12 BAS=[YR=2004] S12 E23 N12 W23\$ W19 S12\$ S8\$ S20 E19\$ E28 FOP=[YR=1968] W10 S8 E10 N8\$ E22 N28 \$ N12\$. | | | | | | | | | |

| LAND DESCRIPTION | | | | | | | | | | TOTAL OB/XF | | | | | | | | | | | | | | |
|------------------|----------|-----|----------------------|-----|-----|----------|-------|-------|-------------|-------------|-----|----------|--------|---------|------------|----------------|------------|-----------------------------|------|---------|------|-----|----|--------|
| L N | USE CODE | CLS | LAND USE DESCRIPTION | CAP | R D | LOC ZONE | FRONT | DEPTH | TOT LND UTS | UNIT TYPE | D T | DPH FACT | % COND | TOT ADJ | UNIT PRICE | ADJ UNIT PRICE | LAND VALUE | OTHER ADJUSTMENTS AND NOTES | YEAR | DENSITY | DECL | FRZ | YR | CONSRV |
| 1 | 000110 | C | SFR RURAL | 0 | | | 0.00 | 0.00 | 1.00 | AC | | 1.00 | 1.00 | 1.00 | 15,000.00 | 15,000.00 | 15,000 | | | | | | | |
| 2 | 005970 | A | TIMBER MIX 1 | 0 | | | 0.00 | 0.00 | 9.00 | AC | | 1.00 | 1.00 | 1.00 | 325.00 | 325.00 | 2,925 | | | | | | | |