

BUILDING CHARACTERISTICS		CONSTRUCTION	
ELEMENT	CD		
Foundation	02	CONCR SLAB	100
Frame	02	WOOD FRAME	100
Exterior Wall	05	HARDIE BRD	80
Exterior Wall	20	FACE BRICK	20
Roof Structur	03	GABLE/HIP	100
Roof Cover	03	COMP SHNGL	100
Interior Wall	05	DRYWALL	100
Interior Floo	10	LAMINATED	50
Interior Floo	11	CLAY TILE	50
Heating Type	04	AIR DUCTED	100
Air Condition	03	CENTRAL	100
Bedrooms		3	100
Bathrooms		2	100
Story Height		0	100
Stories	1.	1.	100
Units		0	100
Quality	03	AVERAGE	
DOR CODE	0100	SINGLE FAMILY	
MAP NUM	5	MKT AREA	10
NEIGHBORHOOD/LOC	255.00	1.00/	
AREA TYPE	TOTAL GROSS AREA	PCT OF BASE	YEAR
BAS	1,515	100	2000
DCK	140	10	2000
FGR	440	50	2000
FOP	185	30	2000
TOTALS	2,280		

MARKET ADJUSTMENTS													
TYPE	MDL	EFF. AREA	TOT ADJ PTS	EFF. BASE RATE	REPL. COST NEW	AYB	EYB	ECON	FNCT	NORM	% COND		
1	SINGLE FAM	100%	- 2001									Heated Area: 1515 HX Base Yr 2001	

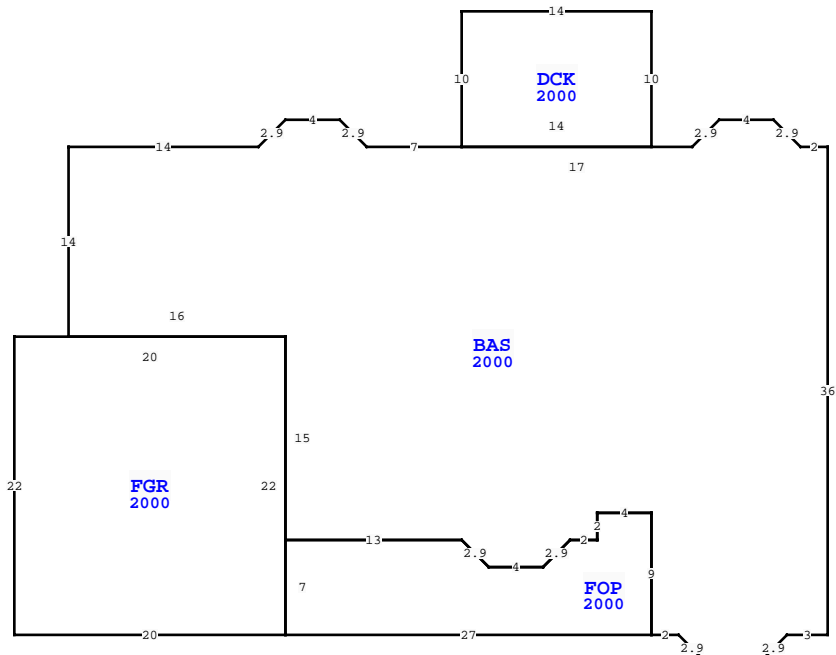

WAKULLA COUNTY PROPERTY			
VALUATION SUMMARY			PAGE 1 of 1
VALUATION BY		STANDARD	
Tax Group: 3		Tax Dist:	
BUILDING MARKET VALUE		160,556	
TOTAL MARKET OB/XF VALUE		5,332	
TOTAL LAND VALUE - MARKET		60,000	
TOTAL MARKET VALUE		225,888	
SOH/AGL Deduction		50,419	
ASSESSED VALUE		175,469	
TOTAL EXEMPTION VALUE		HX HB WX 55,000	
BASE TAXABLE VALUE		120,469	
TOTAL JUST VALUE		225,888	
NCON VALUE		0	
INCOME VALUE			
PREVIOUS YEAR MKT VALUE		228,003	
5 YR PRCL CK, N/C			
OR 1060/406			
ADD WX FOR 2018-ANTHONY HOLBROOK DOD 11/12/17			
PU XFOB LN 6			
PERMIT NUM	DESCRIPTION	AMT	ISSUED
B24-000118	RE-ROOF/SHINGLES		02/20/2024
19000018	MECH-CO	0	01/11/2019

SALES DATA						
OFF RECORD Number	DATE	TYPE INST	Q / U	V / I	RSN CD	SALE PRICE
0394/0343	11/29/2000	WD	Q	V		20,000
GRANTOR: HOLBROOK ANTHONY & JO						
GRANTEE:						
0370/0453	12/29/1999	WD	Q	V		20,000
GRANTOR: HOLBROOK ANTHONY & JO						
GRANTEE:						

EXTRA FEATURES																		
L N	OB/XF CODE	DESCRIPTION	BLD CAP	L	W	UNITS	UT	Adj R	ADJ UNIT PRICE	ORIG COND	YEAR ON	YEAR ACTUAL	Q	% COND	OB/XF MKT VALUE	NOTES		
1	0210	CONCRETE D	0	100	178	13			2,314.00	SF	6.00	100	2000	2000	3	20	2,777	
2	0625	PORT WD UT	0	100	12	10			120.00	SF	6.00	100	2001	2001	3	20	144	
3	0210	CONCRETE D	0	100	0	0			926.00	SF	6.00	100	2001	2001	3	20	1,111	
4	0211	CONCRETE W	0	100	70	4			280.00	SF	6.00	100	2000	2000	3	20	336	
5	0130	FIRE PLACE	0	100	0	0			1.00	UT	1,300.00	1,300.00	100	2000	2000	3	57	741
6	0940	OPEN SHED	0	100	10	9			90.00	SF	4.00	4.00	100	2014	2014	3	62	223

BLD DATE		06/11/2019	MMJT	LGL DATE	06/11/2019	MMJT
XF DATE		06/11/2019	MMJT	LAND DATE		06/11/2019
INC DATE				AG DATE		

BUILDING NOTES																							
BUILDING DIMENSIONS																							
BAS=[YR=2000] W2 L2 U2 W4 L2 D2 W17 DCK=[YR=2000] E14 N10 W14 S10\$ W7 L2 U2 W4 L2 D2 W14 S14 E16 S15 E13 R2 D2 E4 R2 U2 E2 N2 E4 S9 FOP=[YR=2000] N9 W4 S2 W2 L2 D2 W4 L2 U2 W13 S7 FGR=[YR=2000] N22 W20 S22 E20\$ E27\$ E2 R2 D2 E4 R2 U2 E3 N36\$.																							

LAND DESCRIPTION										TOTAL OB/XF														
L N	USE CODE	CLS	LAND USE DESCRIPTION	CAP	R D	LOC ZONE	FRONT	DEPTH	TOT LND UTS	UNIT TYPE	D T	DPH FACT	% COND	TOT ADJ	UNIT PRICE	ADJ UNIT PRICE	LAND VALUE	OTHER ADJUSTMENTS AND NOTES	YEAR	DENSITY	DECL	FRZ	YR	CONSRV
1	000100	C	SFR	100			0.00	0.00	1.00	LT		1.00	1.00	1.00	30,000.00	30,000.00	30,000							
2	000000	C	VAC RES	100			0.00	0.00	1.00	LT		1.00	1.00	1.00	30,000.00	30,000.00	30,000							