

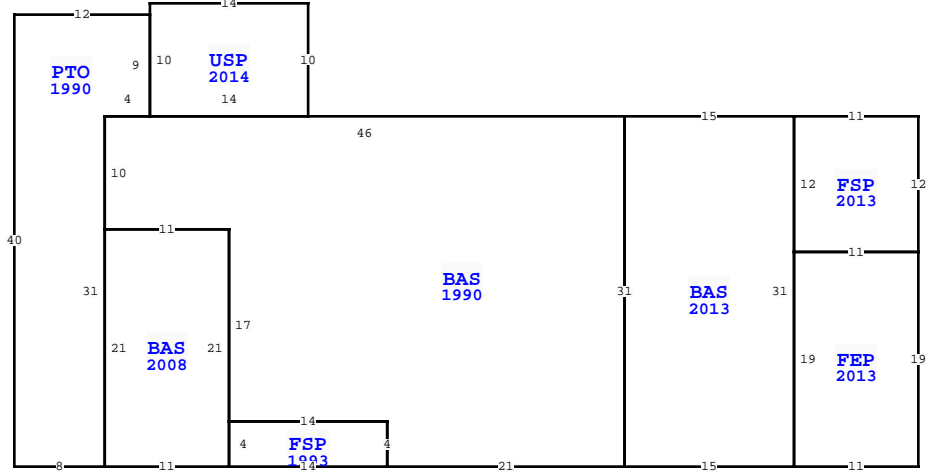

ELEMENT		CD	CONSTRUCTION
Foundation	02	CONCR	SLAB 100
Frame	08	WOOD	FRAME 100
Exterior Wall	02	WD ON PLY	100
Roof Structur	03	GABLE/HIP	100
Roof Cover	13	GALVALUM	100
Interior Wall	05	DRYWALL	100
Interior Floor	11	CLAY TILE	50
Interior Floor	14	CARPET	50
Heating Type	04	AIR DUCTED	100
Air Condition	03	CENTRAL	100
Bedrooms			2 100
Bathrooms			2 100
Story Height			0 100
Stories	1.		1. 100
Units			0 100
Quality	03	AVERAGE	
DOR CODE	5000	IMPRVD AG RES	
MAP NUM	5	MKT AREA	02
NEIGHBORHOOD/LOC	000	1.00/	
AREA TYPE	TOTAL GROSS AREA	PCT OF BASE	YEAR
BAS	1,139	100	1990
BAS	231	100	2008
BAS	465	100	2013
FEP	209	80	2013
FSP	56	55	1993
FSP	132	55	2013
PTO	356	5	1990
USP	140	40	2014
TOTALS	2,728		

MARKET ADJUSTMENTS											
TYPE	MDL	EFF. AREA	TOT ADJ PTS	EFF. BASE RATE	REPL. COST NEW	AYB	EYB	ECON	FNCT	NORM	% COND
0100	01	2,180	109.5000	104.02	226,764	1990	1990	0	0	33.00	67.00
1 SINGLE FAM 100% - 0 Heated Area: 2002 HX Base Yr											



WAKULLA COUNTY PROPERTY				PAGE 1 of 2	3	
VALUATION SUMMARY				STANDARD		
VALUATION BY				STANDARD		
Tax Group: 3		Tax Dist:				
BUILDING MARKET VALUE				151,932		
TOTAL MARKET OB/XF VALUE				17,275		
TOTAL LAND VALUE - MARKET				220,650		
TOTAL MARKET VALUE				196,336		
SOH/AGL Deduction				65,147		
ASSESSED VALUE				131,189		
TOTAL EXEMPTION VALUE				50,000		
BASE TAXABLE VALUE				81,189		
TOTAL JUST VALUE				389,857		
NCON VALUE				0		
INCOME VALUE						
PREVIOUS YEAR MKT VALUE				187,650		
FR CH MH SITE TO 2023, DEMO XFOB, CH CD 0700-0635						
CORRECT LAND LINES						
2022 AG RENEWAL RECD						
PER DEED OR 1227 P 814						
PERMIT NUM	DESCRIPTION	AMT	ISSUED			
OBN23-00058	INSTALL MH-CO		11/29/2023			
19001449	DEMO-CO	0	10/31/2019			
201387	ADDITION-CO	0	02/12/2013			
201144	RE-ROOF	0	01/21/2011			
SALES DATA						
OFF RECORD Number	DATE	TYPE INST	Q / U	V / I	RSN CD	SALE PRICE
1128/0610	10/16/2019	WD	U	I	30	100
GRANTOR: QUIGG JESSE M						
GRANTEE: QUIGG JESSE M & FRA						
BUILDING NOTES						
BUILDING DIMENSIONS						
FSP=[YR=2013] W11 S12 E11 FEP=[YR=2013] W11 S19						
BAS=[YR=2013] N31 W15 S31 BAS=[YR=1990] N31 W46 PTO=[YR=1990] E4						
USP=[YR=2014] E14 N10 W14 S10\$ N9 W12 S40 E8 N31\$ S10 E11						
S17 E14 S4 FSP=[YR=1993] N4 W14 S4 BAS=[YR=2008] N21 W11 S21						
E11\$ E14\$ E21\$ E15\$ E11 N19\$ N12\$.						

EXTRA FEATURES																
L N	OB/XF CODE	DESCRIPTION	BLD CAP	L	W	UNITS	UT	Adj R	ADJ UNIT PRICE	ORIG COND	YEAR ON	YEAR ACTUAL	Q	% COND	OB/XF MKT VALUE	NOTES
1	0900	MH SITE	0 100	0	0	1.00	UT	5,000.00	5,000.00	100	2023	2023	3	100	5,000	
2	0020	BARN, FRAME	0 100	36	24	864.00	SF	12.00	12.00	100	2005	2005	3	24	2,488	
3	0210	CONCRETE D	0 100	10	50	500.00	SF	6.00	6.00	100	1991	1991	3	20	600	
4	0080	4' CHAINLI	0 100	0	0	406.00	LF	13.00	13.00	100	2002	2002	3	20	1,056	
6	0211	CONCRETE W	0 100	14	3	42.00	SF	6.00	6.00	100	1991	1991	3	20	50	
7	0030	BARN, POLE	0 100	50	24	1,200.00	SF	9.00	9.00	100	2007	2007	3	30	3,240	
8	0055	PORTABLE C	0 100	20	18	360.00	SF	3.00	3.00	100	2008	2008	3	34	367	
9	0635	PORT MTL U	0 100	12	10	120.00	SF	8.00	8.00	100	2002	2002	3	20	192	
10	0940	OPEN SHED	0 100	16	16	256.00	SF	4.00	4.00	100	2008	2008	3	34	348	
11	0940	OPEN SHED	0 100	50	12	600.00	SF	4.00	4.00	100	2017	2017	3	76	1,824	

LAND DESCRIPTION												TOTAL OB/XF				15,165								
L N	USE CODE	CLS	LAND USE DESCRIPTION	CAP	R D	LOC ZONE	FRONT	DEPTH	TOT LND UTS	UNIT TYPE	D T	DPTH FACT	% COND	TOT ADJ	UNIT PRICE	ADJ UNIT PRICE	LAND VALUE	OTHER ADJUSTMENTS AND NOTES	YEAR	DENSITY	DECL	FRZ	YR	CONSRV
1	000110	C	SFR RURAL	100			0.00	0.00	1.00	AC		1.00	1.00	1.00	15,000.00	15,000.00	15,000							
2	005970	A	TIMBER MIX 1	0			0.00	0.00	21.13	AC		1.00	1.00	1.00	325.00	325.00	6,867							
3	005400	A	TIMBER 1 PLA	0			0.00	0.00	14.50	AC		1.00	1.00	1.00	325.00	325.00	4,712							
4	005996	A	AG WETLAND	0			0.00	0.00	5.50	AC		1.00	1.00	1.00	100.00	100.00	550							

