

| BUILDING CHARACTERISTICS | |
|--------------------------|-------------------|
| ELEMENT | CD CONSTRUCTION |
| Foundation | 02 CONCR SLAB 100 |
| Frame | 30 WOOD FRAME 100 |
| Exterior Wall | 02 VINYL 100 |
| Roof Structur | 03 GABLE/HIP 100 |
| Roof Cover | 03 COMP SHNGL 100 |
| Interior Wall | 05 DRYWALL 100 |
| Interior Floo | 09 PINE WOOD 60 |
| Interior Floo | 14 CARPET 40 |
| Heating Type | 04 AIR DUCTED 100 |
| Air Condition | 03 CENTRAL 100 |
| Bedrooms | 3 100 |
| Bathrooms | 2 100 |
| Story Height | 0 100 |
| Stories | 1.5 1.5 100 |
| Units | 0 100 |

| MARKET ADJUSTMENTS | | | | | | | | | | | | |
|--|-----|-----------|-------------|----------------|----------------|------|------|------|------|------|--------|-------|
| TYPE | MDL | EFF. AREA | TOT ADJ PTS | EFF. BASE RATE | REPL. COST NEW | AYB | EYB | ECON | FNCT | NORM | % COND | |
| 0100 | 01 | 2,649 | 107.2000 | 101.84 | 269,774 | 2008 | 2010 | 0 | 0 | 0 | 13.00 | 87.00 |
| 1 SINGLE FAM 100% - 2009 Heated Area: 2283 HX Base Yr 2009 | | | | | | | | | | | | |

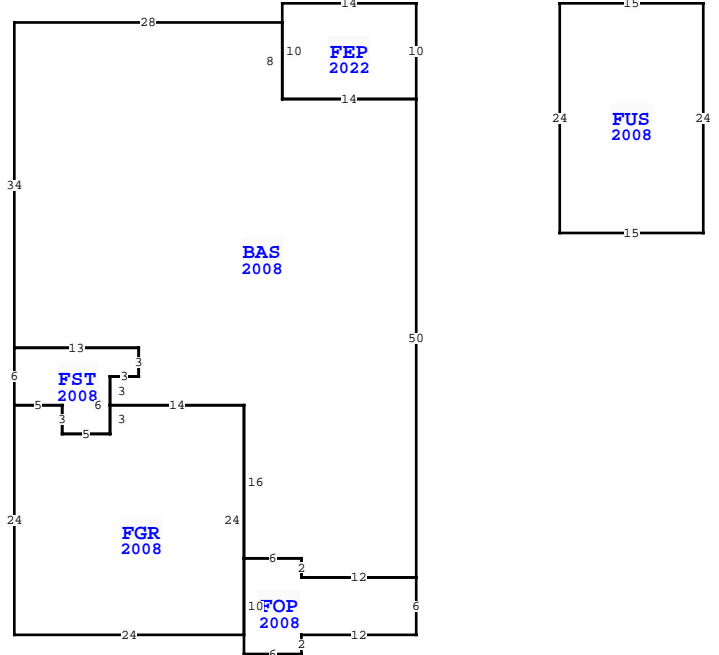

| Quality | | | | | |
|------------------|------------------|-------------|------|--------------|----------------------|
| DOR CODE | 03 AVERAGE | | | | |
| MAP NUM | 5 MKT AREA 10 | | | | |
| NEIGHBORHOOD/LOC | 000 1.00/ | | | | |
| AREA TYPE | TOTAL GROSS AREA | PCT OF BASE | YEAR | TOT ADJ AREA | SUBAREA MARKET VALUE |
| BAS | 1,811 | 100 | 2008 | 1,811 | 160,456 |
| FEP | 140 | 80 | 2022 | 112 | 9,923 |
| FGR | 561 | 50 | 2008 | 280 | 24,808 |
| FOP | 132 | 30 | 2008 | 40 | 3,544 |
| FST | 84 | 55 | 2008 | 46 | 4,076 |
| FUS | 360 | 100 | 2008 | 360 | 31,896 |
| TOTALS | 3,088 | | | 2,649 | 234,703 |

| WAKULLA COUNTY PROPERTY | | | |
|---|---------------|--------------|-------------|
| VALUATION SUMMARY | | | PAGE 1 of 1 |
| VALUATION BY | | STANDARD | |
| Tax Group: 3 | | Tax Dist: | |
| BUILDING MARKET VALUE | | 234,703 | |
| TOTAL MARKET OB/XF VALUE | | 16,410 | |
| TOTAL LAND VALUE - MARKET | | 15,600 | |
| TOTAL MARKET VALUE | | 266,713 | |
| SOH/AGL Deduction | | 96,038 | |
| ASSESSED VALUE | | 170,675 | |
| TOTAL EXEMPTION VALUE | | HX HB 50,000 | |
| BASE TAXABLE VALUE | | 120,675 | |
| TOTAL JUST VALUE | | 266,713 | |
| NCON VALUE | | 0 | |
| INCOME VALUE | | 0 | |
| PREVIOUS YEAR MKT VALUE | | 270,754 | |
| 5YR CK MM CHG FSP2008 TO FEP2022 PU XFOB X2 | | | |
| INCR EYB 2008-2010 HVAC-CC 6-2022 | | | |
| 5 YR CHK NO CHANGE | | | |
| 5 YR PRCL CK. COR DIM XFOB LN 5. PU XFOB LN 6 | | | |
| PERMIT NUM | DESCRIPTION | AMT | ISSUED |
| OB22-000322 | HVAC-CC | 0 | 05/16/2022 |
| 19000534 | MECH | 0 | 11/01/2019 |
| 15000514 | WINDOWS/DOORS | 0 | 06/09/2015 |
| 2007753 | SFD-CO | 0 | 05/21/2007 |

| SALES DATA | | | | | | |
|------------------------------|-----------|-----------|-----|-----|--------|------------|
| OFF RECORD Number | DATE | TYPE INST | Q U | V I | RSN CD | SALE PRICE |
| 0876/0284 | 3/27/2012 | WD | U | V | 12 | 100 |
| GRANTOR: RAKER BARBARA J | | | | | | |
| GRANTEE: RAKER BARBARA J TRU | | | | | | |
| 0706/0570 | 4/18/2007 | WD | Q | V | 01 | 100 |
| GRANTOR: RAKER ALLENE M | | | | | | |
| GRANTEE: RAKER BARBARA J | | | | | | |

| EXTRA FEATURES | | | | | | | | | | | | | | | |
|----------------|------------|-------------|---------|--------|----------|----|-------|----------------|-----------|---------|-------------|---|--------|-----------------|-------|
| L N | OB/XF CODE | DESCRIPTION | BLD CAP | L W | UNITS | UT | Adj R | ADJ UNIT PRICE | ORIG COND | YEAR ON | YEAR ACTUAL | Q | % COND | OB/XF MKT VALUE | NOTES |
| 1 | 0210 | CONCRETE D | 0 100 | 347 12 | 4,164.00 | SF | 6.00 | 6.00 | 100 | 2008 | 2008 | 3 | 34 | 8,495 | |
| 2 | 0211 | CONCRETE W | 0 100 | 36 4 | 144.00 | SF | 6.00 | 6.00 | 100 | 2008 | 2008 | 3 | 34 | 294 | |
| 3 | 0210 | CONCRETE D | 0 100 | 39 32 | 1,248.00 | SF | 6.00 | 6.00 | 100 | 2008 | 2008 | 3 | 34 | 2,546 | |
| 4 | 0700 | PORT BLDG | 0 100 | 24 12 | 288.00 | SF | 8.00 | 8.00 | 100 | 2009 | 2009 | 3 | 72 | 1,659 | |
| 5 | 0955 | PRIVACY FE | 0 100 | 0 0 | 328.00 | LF | 15.00 | 15.00 | 100 | 2011 | 2011 | 3 | 65 | 3,198 | |
| 6 | 0955 | PRIVACY FE | 0 100 | 0 0 | 16.00 | LF | 15.00 | 15.00 | 100 | 2017 | 2017 | 3 | 91 | 218 | |
| 7 | 0625 | PORT WD UT | 0 100 | 12 8 | 96.00 | SF | 0.00 | 0.00 | 100 | 2018 | 2018 | 3 | 80 | 0 | |
| 8 | 0055 | PORTABLE C | 0 100 | 24 12 | 288.00 | SF | 0.00 | 0.00 | 100 | 2021 | 2021 | 3 | 93 | 0 | |

| TOTAL OB/XF | | | | | | | | | | | | | | | | | | | | | | | |
|-------------|----------|-----|----------------------|-----|-----|----------|-------|-------|-------------|-----------|-----------|--------|---------|------------|----------------|------------|-----------------------------|------|---------|------|-----|----|--------|
| L N | USE CODE | CLS | LAND USE DESCRIPTION | CAP | R D | LOC ZONE | FRONT | DEPTH | TOT LND UTS | UNIT TYPE | DPTH FACT | % COND | TOT ADJ | UNIT PRICE | ADJ UNIT PRICE | LAND VALUE | OTHER ADJUSTMENTS AND NOTES | YEAR | DENSITY | DECL | FRZ | YR | CONSRV |
| 1 | 000100 | C | SFR | 100 | | | 0.00 | 0.00 | 2.08 | AC | 1.00 | 1.00 | 1.00 | 7,500.00 | 7,500.00 | 15,600 | | | | | | | |

| BUILDING NOTES | | | | | | | | | | | | |
|---|--|--|--|--|--|--|--|--|--|--|--|--|
| FEP=[YR=2022] W14 S10 E14 BAS=[YR=2008] W14 N8 W28 S34 | | | | | | | | | | | | |
| FST=[YR=2008] S6 E5 S3 E5 N6 E3 N3 W13\$ E13 S3 W3 S3 E14 | | | | | | | | | | | | |
| FGR=[YR=2008] W14 S3 W5 N3 W5 S24 E24 N24\$ S16 FOP=[YR=2008] S10 E6 N2 E12 N6 W12 N2 W6\$ E6 S2 E12 N50\$ N10\$ PTR= E15 | | | | | | | | | | | | |
| FUS=[YR=2008] S24 E15 N24 W15\$ W15\$. | | | | | | | | | | | | |

| LAND DESCRIPTION | | | | | | | | | | | | | | | | | | | | | | | |
|------------------|----------|-----|----------------------|-----|-----|----------|-------|-------|-------------|-----------|-----------|--------|---------|------------|----------------|------------|-----------------------------|------|---------|------|-----|----|--------|
| L N | USE CODE | CLS | LAND USE DESCRIPTION | CAP | R D | LOC ZONE | FRONT | DEPTH | TOT LND UTS | UNIT TYPE | DPTH FACT | % COND | TOT ADJ | UNIT PRICE | ADJ UNIT PRICE | LAND VALUE | OTHER ADJUSTMENTS AND NOTES | YEAR | DENSITY | DECL | FRZ | YR | CONSRV |
| 1 | 000100 | C | SFR | 100 | | | 0.00 | 0.00 | 2.08 | AC | 1.00 | 1.00 | 1.00 | 7,500.00 | 7,500.00 | 15,600 | | | | | | | |