

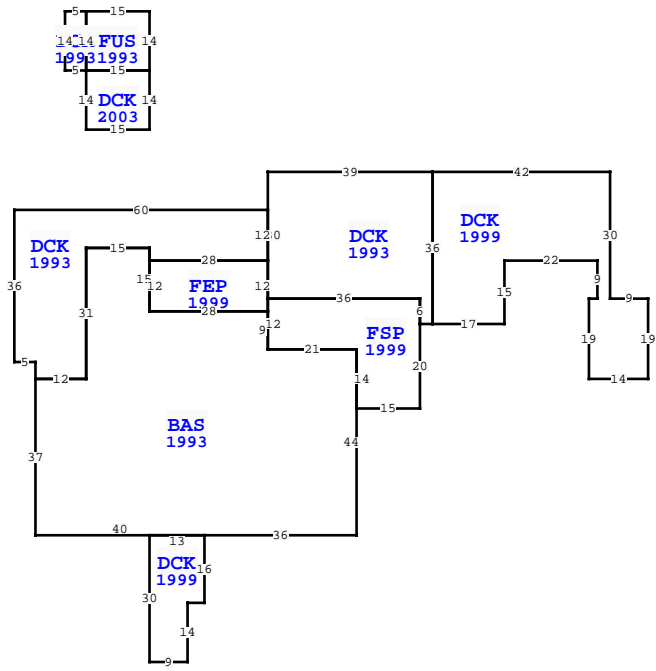

| ELEMENT | | CD | CONSTRUCTION | |
|------------------|------------------|---------------|--------------|--------------|
| Foundation | 02 | CONCR | SLAB | 100 |
| Frame | 02 | WOOD | FRAME | 100 |
| Exterior Wall | 12 | CEDAR/CYPR | 100 | |
| Roof Structur | 08 | IRREGULAR | 100 | |
| Roof Cover | 03 | COMP | SHNGL | 100 |
| Interior Wall | 05 | DRYWALL | 100 | |
| Interior Floor | 11 | CLAY TILE | 100 | |
| Heating Type | 04 | AIR DUCTED | 100 | |
| Air Condition | 03 | CENTRAL | 100 | |
| Bedrooms | | 7 | 100 | |
| Bathrooms | | 4 | 100 | |
| Story Height | | 0 | 100 | |
| Stories | 1.5 | 1.5 | 100 | |
| Units | | 0 | 100 | |
| Quality | 03 | AVERAGE | | |
| DOR CODE | 5000 | IMPRVD AG RES | | |
| MAP NUM | 5 | MKT AREA | 08 | |
| NEIGHBORHOOD/LOC | 000 | 1.00/ | | |
| AREA TYPE | TOTAL GROSS AREA | PCT OF BASE | YEAR | TOT ADJ AREA |
| BAS | 3,872 | 100 | 1993 | 3,872 |
| DCK | 70 | 10 | 1993 | 7 |
| DCK | 1,131 | 10 | 1993 | 113 |
| DCK | 1,188 | 10 | 1993 | 119 |
| DCK | 334 | 10 | 1999 | 33 |
| DCK | 1,430 | 10 | 1999 | 143 |
| DCK | 210 | 10 | 2003 | 21 |
| DCK | 336 | 80 | 1999 | 269 |
| FSP | 642 | 55 | 1999 | 353 |
| FUS | 210 | 100 | 1993 | 210 |
| TOTALS | 9,423 | | | 5,140 |

| MARKET ADJUSTMENTS | | | | | | | | | | | |
|--|-----|-----------|-------------|----------------|----------------|------|------|------|------|-------|--------|
| TYPE | MDL | EFF. AREA | TOT ADJ PTS | EFF. BASE RATE | REPL. COST NEW | AYB | EYB | ECON | FNCT | NORM | % COND |
| 0100 | 01 | 5,140 | 128.0000 | 121.60 | 625,024 | 1930 | 1983 | 0 | 0 | 40.00 | 60.00 |
| 1 SINGLE FAM 100% - 2024 Heated Area: 4351 HX Base Yr 2024 | | | | | | | | | | | |



| WAKULLA COUNTY PROPERTY | | | |
|--|-------------------|-----------|--------------------|
| VALUATION BY | | STANDARD | |
| Tax Group: 3 | Tax Dist: | | |
| BUILDING MARKET VALUE | 375,014 | | |
| TOTAL MARKET OB/XF VALUE | 21,073 | | |
| TOTAL LAND VALUE - MARKET | 654,826 | | |
| TOTAL MARKET VALUE | 824,643 | | |
| SOH/AGL Deduction | 0 | | |
| ASSESSED VALUE | 824,643 | | |
| TOTAL EXEMPTION VALUE | HX HB 50,000 | | |
| BASE TAXABLE VALUE | 774,643 | | |
| TOTAL JUST VALUE | 1,050,913 | | |
| NCON VALUE | 3,018 | | |
| INCOME VALUE | | | |
| PREVIOUS YEAR MKT VALUE | 799,666 | | |
| INCR EYB 1981-1983 HVAC OB23-431 CC 8/21/2023 | | | |
| CORRECTED OR BOOKS IN LEGAL | | | |
| MM 5YR CK 9/15/23; PU XFOBS | | | |
| & 02041-009 & 02041-010 | | | |
| PERMIT NUM | DESCRIPTION | AMT | ISSUED |
| OB24-000160 | HVAC CHANGE OUT-C | | 03/15/2024 |
| OBN23-00064 | RE-ROOF/SHINGLES | | 12/20/2023 |
| OB23-000431 | HVAC CHANGE OUT-C | | 08/18/2023 |
| 024960 | RENV | 0 | 04/13/1999 |
| 024024 | BLDG | 0 | 08/28/1998 |
| SALES DATA | | | |
| OFF RECORD Number | DATE | TYPE INST | Q U / V I / RSN CD |
| 1356/0715 | 4/22/2024 | QC U | I 11 |
| GRANTOR: LUMMEL LYNNE Y | | | |
| GRANTEE: LEE JOHN | | | |
| 1355/0191 | 4/11/2024 | QC U | I 11 |
| GRANTOR: LUMMEL LYNNE Y | | | |
| GRANTEE: LUMMEL LYNNE Y | | | |
| BUILDING NOTES | | | |
| BUILDING DIMENSIONS | | | |
| DCK=[YR=1999] W42 S36 DCK=[YR=1993] N36 W39 PTR= W28 N10 | | | |
| DCK=[YR=2003] N14 W15 FUS=[YR=1993] E15 N14 W15 S14\$ | | | |
| DCK=[YR=1993] N14 W5 S14 E5\$ S14 E15\$ S10 E28\$ S30 E36 S6 | | | |
| FSP=[YR=1999] N6 W36 S12 E21 BAS=[YR=1993] W21 N9 W28 | | | |
| FEP=[YR=1999] E28 N12 W28 S12\$ N15 W15 S31 W12 DCK=[YR=1993] E12 N31 E15 S3 E28 N12 W60 S36 E5 S4\$ S37 E40 DCK=[YR=1999] W13 S30 E9 N14 E4 N16 \$ E36 N44\$ S14 E15 N20\$ E3\$ E17 N15 E22 S9 W2 S19 E14 N19 W9 N30\$. | | | |

| EXTRA FEATURES | | | | | | | | | | | |
|----------------|------------|-------------|-----|-----|----|----|----------|----|----------|----------------|-----------|
| L N | OB/XF CODE | DESCRIPTION | BLD | CAP | L | W | UNITS | UT | Adj R | ADJ UNIT PRICE | ORIG COND |
| 1 | 0001 | BLOCK UTIL | 0 | 100 | 18 | 24 | 432.00 | SF | 16.00 | 16.00 | 100 |
| 2 | 0940 | OPEN SHED | 0 | 100 | 22 | 56 | 1,232.00 | SF | 4.00 | 4.00 | 100 |
| 3 | 0210 | CONCRETE D | 0 | 100 | 0 | 0 | 180.00 | SF | 6.00 | 6.00 | 100 |
| 4 | 0330 | BOAT SHED | 0 | 100 | 30 | 20 | 600.00 | SF | 15.00 | 15.00 | 100 |
| 5 | 0955 | PRIVACY FE | 0 | 100 | 0 | 0 | 24.00 | LF | 15.00 | 15.00 | 100 |
| 6 | 0140 | FIRE PLACE | 0 | 100 | 0 | 0 | 1.00 | UT | 1,900.00 | 1,900.00 | 100 |
| 7 | 0350 | BOATDOCK A | 0 | 100 | 20 | 11 | 220.00 | SF | 24.00 | 24.00 | 100 |
| 8 | 0375 | WOOD WALK | 0 | 100 | 40 | 5 | 200.00 | SF | 15.00 | 15.00 | 100 |
| 9 | 0211 | CONCRETE W | 0 | 100 | 36 | 27 | 972.00 | SF | 6.00 | 6.00 | 100 |
| 10 | 0211 | CONCRETE W | 0 | 100 | 16 | 8 | 128.00 | SF | 6.00 | 6.00 | 100 |

| TOTAL OB/XF | | | | | | | | | | | |
|------------------------------|----------------|------------|-----------------------------|------------|---------|----------|-------|-------|-------------|-----------|-----------|
| BLD DATE | 03/13/2018 | MMJTT | LGL DATE | | | | | | | | |
| XF DATE | 03/13/2018 | MMJTT | LAND DATE | 03/13/2018 | | | | | | | |
| INC DATE | | | AG DATE | | | | | | | | |
| 1 FRANKLIN DR, CRAWFORDVILLE | | | | | | | | | | | |
| L N | USE CODE | CLS | LAND USE DESCRIPTION | CAP | R D | LOC ZONE | FRONT | DEPTH | TOT LND UTS | UNIT TYPE | DPTH FACT |
| 1 | 000133 | C | SFR LAKE | 100 | | | 0.00 | 0.00 | 1.00 | AC | 1.00 |
| 2 | 000100 | C | SFR | 100 | | | 0.00 | 0.00 | 6.00 | LT | 1.00 |
| 3 | 000100 | C | SFR | 100 | | | 0.00 | 0.00 | 5.00 | LT | 1.00 |
| 4 | 005970 | A | TIMBER MIX 1 | 0 | | | 0.00 | 0.00 | 48.40 | AC | 1.00 |
| 5 | 009500 | C | SUBMERGED | 100 | | | 0.00 | 0.00 | 48.26 | AC | 1.00 |
| TOTAL ADJ 7,740 | | | | | | | | | | | |
| UNIT PRICE | ADJ UNIT PRICE | LAND VALUE | OTHER ADJUSTMENTS AND NOTES | YEAR | DENSITY | DECL | FRZ | YR | CONSRV | | |
| 100,000.00 | 100,000.00 | 100,000 | | | | | | | | | |
| 50,000.00 | 50,000.00 | 300,000 | | | | | | | | | |
| 2,000.00 | 1,600.00 | 8,000 | | | | | | | | | |
| 325.00 | 325.00 | 15,730 | | | | | | | | | |
| 100.00 | 100.00 | 4,826 | | | | | | | | | |

