

ELEMENT	CD	CONSTRUCTION
Foundation	04	PILE WOOD 100
Frame	02	WOOD FRAME 100
Exterior Wall	30	VINYL 100
Roof Structur	03	GABLE/HIP 100
Roof Cover	12	MODULAR MT 100
Interior Wall	05	DRYWALL 100
Interior Floor	08	SHT VINYL 50
Interior Floor	14	CARPET 50
Heating Type	04	AIR DUCTED 100
Air Condition	03	CENTRAL 100
Bedrooms		3 100
Bathrooms		2 100
Story Height		0 100
Stories	1.	1. 100
Units		0 100

MARKET ADJUSTMENTS												
TYPE	MDL	EFF. AREA	TOT ADJ PTS	EFF. BASE RATE	REPL. COST NEW	AYB	EYB	ECON	FNCT	NORM	% COND	
0100	01	1,977	123.0000	116.85	231,012	1995	1995		0	0	28.00	72.00
1 SINGLE FAM 100% - 0 Heated Area: 1456 HX Base Yr												

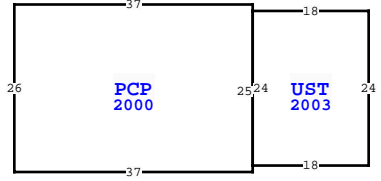
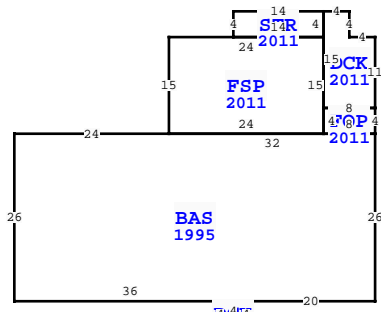

Quality	03	AVERAGE			
DOR CODE	0100	SINGLE FAMILY			
MAP NUM	4	MKT AREA 04			
NEIGHBORHOOD/LOC	000	1.00/			
AREA TYPE	TOTAL GROSS AREA	PCT OF BASE	YEAR	TOT ADJ AREA	SUBAREA MARKET VALUE
BAS	1,456	100	1995	1,456	122,496
DCK	12	10	1995	1	84
DCK	16	10	1995	2	168
DCK	104	10	2011	10	842
FOP	32	30	2011	10	842
FSP	360	55	2011	198	16,658
PCP	962	10	2000	96	8,077
STR	12	10	1995	1	84
STR	28	10	1995	3	253
STR	56	10	2011	6	505
TOTALS	3,470			1,977	166,329

** This building has 11 Sub-Areas
 37 CHATTAHOOCHEE ST, PANACEA

BLD DATE	11/09/2018	MMSS	LGL DATE	
XF DATE	11/09/2018	MMSS	LAND DATE	11/09/2018 MMSS
INC DATE			AG DATE	

WAKULLA COUNTY PROPERTY			
VALUATION SUMMARY			
VALUATION BY	STANDARD		
Tax Group: 3	Tax Dist:		
BUILDING MARKET VALUE	166,329		
TOTAL MARKET OB/XF VALUE	20,509		
TOTAL LAND VALUE - MARKET	6,825		
TOTAL MARKET VALUE	193,663		
SOH/AGL Deduction	56,746		
ASSESSED VALUE	136,917		
TOTAL EXEMPTION VALUE	HX HB	50,000	
BASE TAXABLE VALUE	86,917		
TOTAL JUST VALUE	193,663		
NCON VALUE	0		
INCOME VALUE			
PREVIOUS YEAR MKT VALUE	194,960		
MM 5YR CK - PU XFOB			
5 YR PRCL CK, PU XFOB LN 9			
5 YR PRCL CH, N/C			
XFOB LN 4-8			
PERMIT NUM	DESCRIPTION	AMT	ISSUED
20000446	SIDING	0	09/24/2020
20000690	ELECT-CO	0	07/27/2020
2014606	POOL/SPA	0	07/16/2014
2011340	DECK-CO	0	05/24/2011
2008751	REROOF (MTL)	0	09/03/2008
023395	SHED	0	03/25/1998

SALES DATA						
OFF RECORD Number	DATE	TYPE INST	Q / U	V / I	RSN CD	SALE PRICE
0264/0715	11/08/1995	WD	Q	V		6,500
GRANTOR: PANACEA COASTAL						
GRANTEE: LARRY & YVONNE BOWE						

EXTRA FEATURES																
L N	OB/XF CODE	DESCRIPTION	BLD CAP	L	W	UNITS	UT	Adj R	ADJ UNIT PRICE	ORIG COND	YEAR ON	YEAR ACTUAL	Q	% COND	OB/XF MKT VALUE	NOTES
1	0330	BOAT SHED	0 100	26	14	364.00	SF	15.00	15.00	100	1998	1998	3	20	1,092	
2	0211	CONCRETE W	0 100	12	4	48.00	SF	6.00	6.00	100	2000	2000	3	20	58	
3	0955	PRIVACY FE	0 100	0	0	70.00	LF	15.00	15.00	100	2006	2006	3	30	315	
4	0130	FIRE PLACE	0 100	0	0	1.00	UT	1,300.00	1,300.00	100	1995	1995	3	52	676	
5	0955	PRIVACY FE	0 100	0	0	50.00	LF	15.00	15.00	100	2011	2011	3	65	488	
6	0211	CONCRETE W	0 100	11	4	44.00	SF	6.00	6.00	100	2014	2014	3	62	164	
7	0209	CONCRETE P	0 100	0	0	430.00	SF	8.00	8.00	100	2014	2014	3	62	2,133	
8	0225	POOL, FIBER	0 100	29	14	406.00	SF	50.00	50.00	100	2014	2014	3	62	12,586	
9	0700	PORT BLDG	0 100	12	8	96.00	SF	8.00	8.00	100	2015	2015	3	84	645	
10	0213	CONCRETE P	0 100	0	0	392.00	SF	6.00	6.00	100	2020	2020	3	100	2,352	

BUILDING NOTES													

BUILDING DIMENSIONS													
DCK=[YR=2011] W4 N4 W4 STR=[YR=2011] W14 S4 E14 N4\$ S15 E8													
FOP=[YR=2011] W8 S4 E8 BAS=[YR=1995] W32 FSP=[YR=2011] E24													
N15 W24 S15\$ W24 S26 PTR=S30 PCP=[YR=2000] S26 E37 N25													
UST=[YR=2003] S24 E18 N24 W18\$ N1 W37\$ N30\$ E36													
DCK=[YR=1995] W4 S4 E4 STR=[YR=1995] W4 S7 E4 DCK=[YR=1995]													
W4 S3 STR=[YR=1995] N3 W4 S3 E4\$ E4 N3\$ N7 \$ N4\$ E20 N26\$ N4\$ N11\$.													

LAND DESCRIPTION														TOTAL OB/XF										
L N	USE CODE	CLS	LAND USE DESCRIPTION	CAP	R D	LOC ZONE	FRONT	DEPTH	TOT LND UTS	UNIT TYPE	D T	DPTH FACT	% COND	TOT ADJ	UNIT PRICE	ADJ UNIT PRICE	LAND VALUE	OTHER ADJUSTMENTS AND NOTES	YEAR	DENSITY	DECL	FRZ	YR	CONSRV
1	000100	C	SFR	100			0.00	0.00	0.91	AC		1.00	1.00	1.00	7,500.00	7,500.00	6,825							