

| BUILDING CHARACTERISTICS | |
|--------------------------|---|
| ELEMENT | CD CONSTRUCTION |
| Foundation | 01 WOOD FRAME 100 |
| Frame | 02 WOOD FRAME 100 |
| Exterior Wall | 01 MINIMUM 80 |
| Exterior Wall | 08 WD ON PLY 20 |
| Roof Structur | 01 FLAT 100 |
| Roof Cover | 01 MINIMUM 100 |
| Interior Wall | 05 DRYWALL 100 |
| Interior Floo | 08 SHT VINYL 50 |
| Interior Floo | 14 CARPET 50 |
| Heating Type | 02 CONVECTION 100 |
| Air Condition | 02 WINDOW 100 |
| Bedrooms | 3 100 |
| Bathrooms | 2 100 |
| Stories | 1. 1. 100 |
| Class | 00 N/A 100 |
| Units | 0 100 |
| Quality | 02 BELOW AVERAGE |
| DOR CODE | 5000 IMPRVD AG RES |
| MAP NUM | 1 MKT AREA 09 |
| NEIGHBORHOOD/LOC | 000 1.00/ |
| AREA TYPE | TOTAL GROSS AREA PCT OF BASE YEAR TOT ADJ AREA SUBAREA MARKET VALUE |
| BAS | 720 100 1998 720 12,790 |
| BAS | 352 100 1999 352 6,253 |
| CAN | 108 30 1999 32 568 |
| DCK | 16 10 1999 2 36 |
| UOP | 90 25 1999 22 391 |
| TOTALS | 1,286 1,128 20,038 |

| MARKET ADJUSTMENTS | | | | | | | | | | | |
|-----------------------------------|------------|-----------|-------------|----------------|----------------|------|------|------|------|-------|--------|
| TYPE | MDL | EFF. AREA | TOT ADJ PTS | EFF. BASE RATE | REPL. COST NEW | AYB | EYB | ECON | FNCT | NORM | % COND |
| 1 | MOBILE HOM | 100% | - 2001 | 44.41 | 50,094 | 1975 | 1985 | 0 | 0 | 60.00 | 40.00 |
| Heated Area: 1072 HX Base Yr 2001 | | | | | | | | | | | |

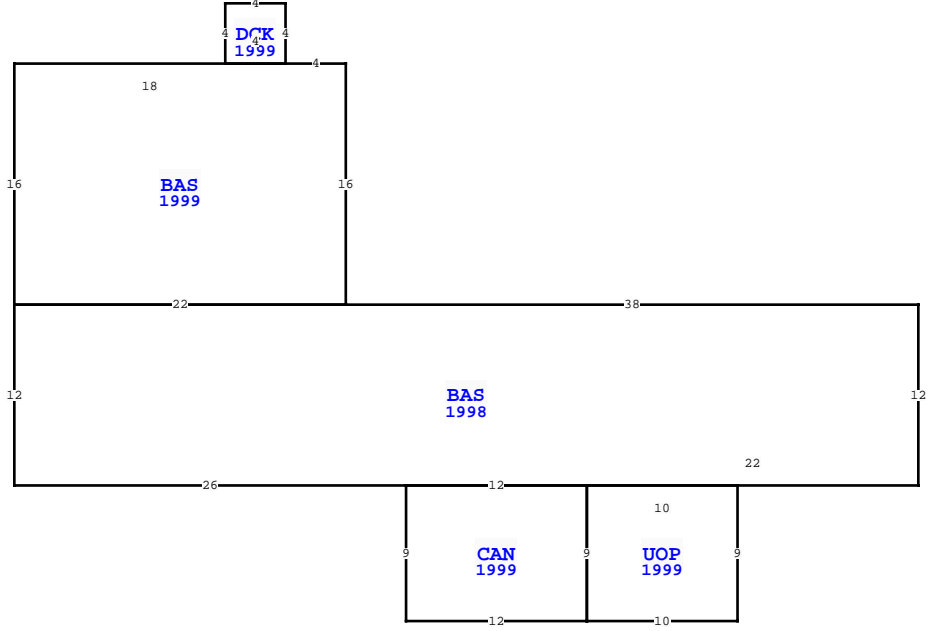

| WAKULLA COUNTY PROPERTY | | | |
|---------------------------|--------------|-------------|--|
| VALUATION SUMMARY | | PAGE 1 of 1 | |
| VALUATION BY | STANDARD | | |
| Tax Group: 3 | Tax Dist: | | |
| BUILDING MARKET VALUE | 20,038 | | |
| TOTAL MARKET OB/XF VALUE | 2,974 | | |
| TOTAL LAND VALUE - MARKET | 95,850 | | |
| TOTAL MARKET VALUE | 41,516 | | |
| SOH/AGL Deduction | 27,616 | | |
| ASSESSED VALUE | 13,900 | | |
| TOTAL EXEMPTION VALUE | HX HB 13,900 | | |
| BASE TAXABLE VALUE | 0 | | |
| TOTAL JUST VALUE | 118,862 | | |
| NCON VALUE | 0 | | |
| INCOME VALUE | 0 | | |
| PREVIOUS YEAR MKT VALUE | 34,069 | | |

| PERMIT NUM | DESCRIPTION | AMT | ISSUED |
|------------|-------------|-----|------------|
| 023653 | SW MH | 0 | 05/29/1998 |

| SALES DATA | | | | | | |
|--------------------------|-----------|-----------|-----|-----|--------|------------|
| OFF RECORD Number | DATE | TYPE INST | Q U | V I | RSN CD | SALE PRICE |
| 0403/0711 | 4/02/2001 | WD U | I | | | 27,000 |
| GRANTOR: DOWELL JOSEPH E | | | | | | |
| GRANTEE: DOWELL JOSEPH E | | | | | | |
| 0257/0334 | 7/06/1995 | CD Q | V | | | 26,900 |
| GRANTOR: | | | | | | |
| GRANTEE: | | | | | | |

| EXTRA FEATURES | | | | | | | | | | | | | | | | |
|----------------|------------|-------------|---------|----|----|--------|----|-------|----------------|-----------|---------|-------------|---|--------|-----------------|-------|
| L N | OB/XF CODE | DESCRIPTION | BLD CAP | L | W | UNITS | UT | Adj R | ADJ UNIT PRICE | ORIG COND | YEAR ON | YEAR ACTUAL | Q | % COND | OB/XF MKT VALUE | NOTES |
| 1 | 0625 | PORT WD UT | 0 100 | 12 | 20 | 240.00 | SF | 6.00 | 6.00 | 100 | 1998 | 1998 | 3 | 20 | 288 | |
| 2 | 0940 | OPEN SHED | 0 100 | 11 | 12 | 132.00 | SF | 4.00 | 4.00 | 100 | 1999 | 1999 | 3 | 20 | 106 | |
| 3 | 0940 | OPEN SHED | 0 100 | 10 | 19 | 190.00 | SF | 4.00 | 4.00 | 100 | 1999 | 1999 | 3 | 20 | 152 | |
| 4 | 0940 | OPEN SHED | 0 100 | 23 | 25 | 575.00 | SF | 4.00 | 4.00 | 100 | 1999 | 1999 | 3 | 20 | 460 | |
| 5 | 0625 | PORT WD UT | 0 100 | 10 | 12 | 120.00 | SF | 6.00 | 6.00 | 100 | 1999 | 1999 | 3 | 20 | 144 | |
| 6 | 0050 | CARPORT UN | 0 100 | 11 | 20 | 220.00 | SF | 9.00 | 9.00 | 100 | 2015 | 2015 | 3 | 84 | 1,663 | |
| 7 | 0940 | OPEN SHED | 0 100 | 6 | 10 | 60.00 | SF | 4.00 | 4.00 | 100 | 2015 | 2015 | 3 | 67 | 161 | |
| TOTALS | | | | | | | | | | | | | | | 2,974 | |

| LAND DESCRIPTION | | | | | | | | | | | | | | | | | | | | | | | | |
|------------------|----------|-----|----------------------|-----|-----|----------|-------|-------|-------------|-----------|-----|----------|--------|---------|------------|----------------|------------|-----------------------------|------|---------|------|-----|----|--------|
| L N | USE CODE | CLS | LAND USE DESCRIPTION | CAP | R D | LOC ZONE | FRONT | DEPTH | TOT LND UTS | UNIT TYPE | D T | DPH FACT | % COND | TOT ADJ | UNIT PRICE | ADJ UNIT PRICE | LAND VALUE | OTHER ADJUSTMENTS AND NOTES | YEAR | DENSITY | DECL | FRZ | YR | CONSRV |
| 1 | 000210 | C | MH RURAL | 100 | | | 0.00 | 0.00 | 1.00 | AC | | 1.00 | 1.00 | 1.00 | 15,000.00 | 15,000.00 | 15,000 | | | | | | | |
| 2 | 005970 | A | TIMBER MIX 1 | 0 | | | 0.00 | 0.00 | 10.78 | AC | | 1.00 | 1.00 | 1.00 | 325.00 | 325.00 | 3,504 | | | | | | | |