

BUILDING CHARACTERISTICS		CONSTRUCTION	
ELEMENT	CD		
Foundation	01	WOOD FRAME	100
Frame	02	WOOD FRAME	100
Exterior Wall	30	VINYL	100
Roof Structur	03	GABLE/HIP	100
Roof Cover	13	GALVALUM	100
Interior Wall	05	DRYWALL	100
Interior Floo	08	SHT VINYL	50
Interior Floo	14	CARPET	50
Heating Type	04	AIR DUCTED	100
Air Condition	03	CENTRAL	100
Bedrooms		4	100
Bathrooms		2	100
Stories	1.	1.	100
Class	00	N/A	100
Units		0	100
Quality	03	AVERAGE	
DOR CODE	0200	MOBILE HOME	
MAP NUM	2	MKT AREA	11
NEIGHBORHOOD/LOC	4097.00	1.00/	
AREA TYPE	TOTAL GROSS AREA	PCT OF BASE	YEAR
BAS	1,976	100	2005
DCK	480	10	2005
DCK	80	10	2006
TOTALS	2,536		

MARKET ADJUSTMENTS											
TYPE	MDL	EFF. AREA	TOT ADJ PTS	EFF. BASE RATE	REPL. COST NEW	AYB	EYB	ECON	FNCT	NORM	% COND
0200	02	2,032	111.5000	78.05	158,598	2005	2005	0	0	36.00	64.00
2 MOBILE HOM 100% - 2021 Heated Area: 1976 HX Base Yr 2021											

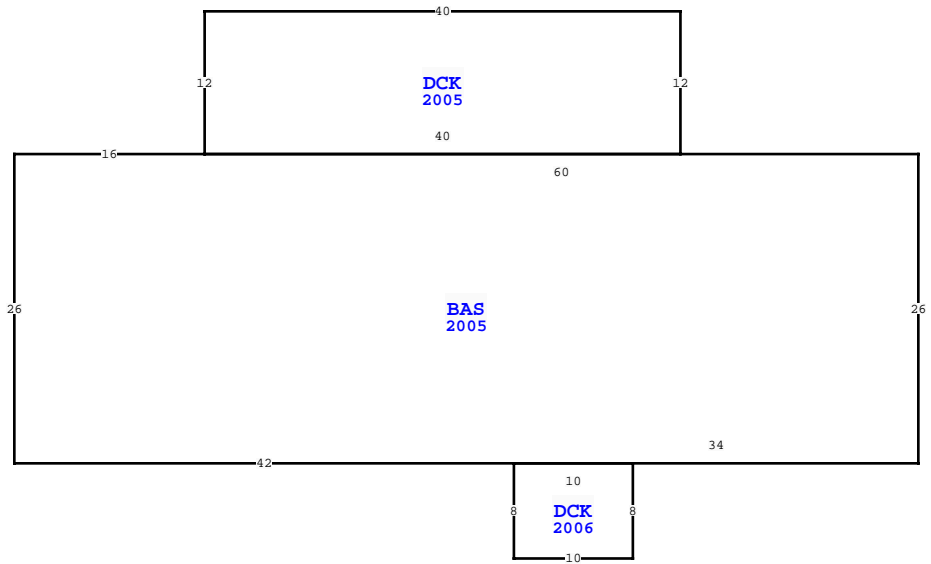

WAKULLA COUNTY PROPERTY			
VALUATION SUMMARY			PAGE 1 of 1
VALUATION BY		STANDARD	
Tax Group: 3	Tax Dist:		
BUILDING MARKET VALUE			101,503
TOTAL MARKET OB/XF VALUE			1,216
TOTAL LAND VALUE - MARKET			24,465
TOTAL MARKET VALUE			127,184
SOH/AGL Deduction			27,044
ASSESSED VALUE			100,140
TOTAL EXEMPTION VALUE	HX HB	50,000	
BASE TAXABLE VALUE			50,140
TOTAL JUST VALUE			127,184
NCON VALUE			0
INCOME VALUE			
PREVIOUS YEAR MKT VALUE			97,223
ADD HX FOR 2021-CORBIN			
5 YR PRCL CH, DEL AP70, CHG RCVR & BUSE			
NEED TO BE FIXED			
NEEDS REPAIR, PART OF INT OF MH GUTTED AND			
PERMIT NUM	DESCRIPTION	AMT	ISSUED
19001055	REPAIRS-CO	0	07/19/2019
19000103	SAFE INSP	0	01/23/2019
2011560	RE-ROOF	0	08/11/2011
2005825	A/C	0	06/16/2005
2005816	MH	0	06/14/2005

SALES DATA						
OFF RECORD Number	DATE	TYPE INST	Q U	V I	RSN CD	SALE PRICE
1178/0308	11/09/2020	WD	Q	I	01	147,500
GRANTOR: WOOFER MELANIE BROWN						
GRANTEE: CORBIN WILLIAM CHAS						
1128/0221	10/17/2019	WD	Q	I	01	50,000
GRANTOR: WILLIAMS JOHN BUSTER						
GRANTEE: WOOFER MELANIE BRO						

EXTRA FEATURES																	
L N	OB/XF CODE	DESCRIPTION	BLD CAP	L W	UNITS	UT	Adj R	ADJ UNIT PRICE	ORIG COND	YEAR ON	YEAR ACTUAL	Q	% COND	OB/XF MKT VALUE	NOTES		
1	0940	OPEN SHED	0	100	0	0		4.00	100	1980	1980	3	20	384			
2	0130	FIRE PLACE	0	100	0	0		1,300.00	100	2005	2005	3	64	832			
TOTALS												2,536			2,032	101,503	

LAND DESCRIPTION												TOTAL OB/XF												
L N	USE CODE	CLS	LAND USE DESCRIPTION	CAP	R D	LOC ZONE	FRONT	DEPTH	TOT LND UTS	UNIT TYPE	D T	DPH FACT	% COND	TOT ADJ	UNIT PRICE	ADJ UNIT PRICE	LAND VALUE	OTHER ADJUSTMENTS AND NOTES	YEAR	DENSITY	DECL	FRZ	YR	CONSRV
1	000201	C	MH				0.00	0.00	2.33	AC		1.00	1.00	1.00	10,500.00	10,500.00	24,465							