

RIVER SINK SUBD  
 BLOCK A LOT 11  
 OR 35 P 692 & OR 49 P 692

BRIM MARTHA H  
 206 PIXIE CIRCLE  
 CRAWFORDVILLE, FL 32327

**2024**

29-2S-01W-051-04129-000

| ELEMENT        | CD | CONSTRUCTION   |
|----------------|----|----------------|
| Foundation     | 01 | WOOD FRAME 100 |
| Frame          | 02 | WOOD FRAME 100 |
| Exterior Wall  | 30 | VINYL 100      |
| Roof Structur  | 03 | GABLE/HIP 100  |
| Roof Cover     | 12 | MODULAR MT 100 |
| Interior Wall  | 04 | PLYWOOD 100    |
| Interior Floor | 08 | SHT VINYL 50   |
| Interior Floor | 14 | CARPET 50      |
| Heating Type   | 04 | AIR DUCTED 100 |
| Air Condition  | 03 | CENTRAL 100    |
| Bedrooms       |    | 3 100          |
| Bathrooms      |    | 2 100          |
| Stories        | 1. | 1. 100         |
| Class          | 00 | N/A 100        |
| Units          |    | 0 100          |

| MARKET ADJUSTMENTS                               |     |           |             |                |                |      |      |      |      |       |        |  |  |
|--|-----|-----------|-------------|----------------|----------------|------|------|------|------|-------|--------|--|--|
| TYPE   | MDL | EFF. AREA | TOT ADJ PTS | EFF. BASE RATE | REPL. COST NEW | AYB  | EYB  | ECON | FNCT | NORM  | % COND |  |  |
| 0200   | 02  | 1,697     | 112.5000    | 90.56          | 153,680        | 1986 | 1991 | 0    | 0    | 52.00 | 48.00  |  |  |
| 1 MOBILE HOM 0% - 0 Heated Area: 1440 HX Base Yr |     |           |             |                |                |      |      |      |      |       |        |  |  |

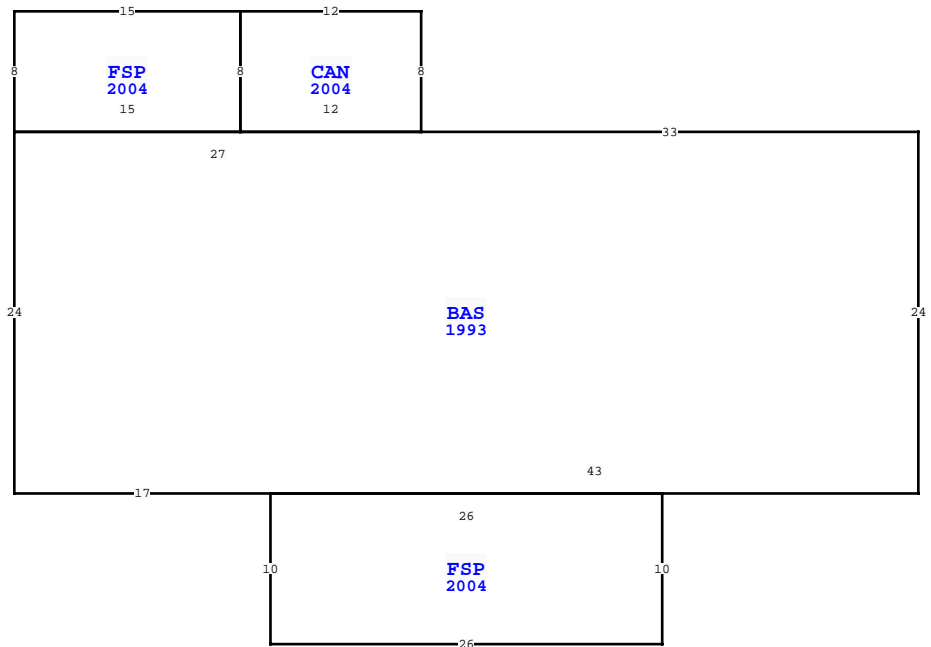

| Quality          | 03               | AVERAGE     |      |              |                      |
|------------------|------------------|-------------|------|--------------|----------------------|
| DOR CODE         | 0200             | MOBILE HOME |      |              |                      |
| MAP NUM          | 2                | MKT AREA 11 |      |              |                      |
| NEIGHBORHOOD/LOC | 51.00            | 1.15/       |      |              |                      |
| AREA TYPE        | TOTAL GROSS AREA | PCT OF BASE | YEAR | TOT ADJ AREA | SUBAREA MARKET VALUE |
| BAS              | 1,440            | 100         | 1993 | 1,440        | 62,595               |
| CAN              | 96               | 30          | 2004 | 29           | 1,260                |
| FSP              | 120              | 60          | 2004 | 72           | 3,130                |
| FSP              | 260              | 60          | 2004 | 156          | 6,781                |
| TOTALS           | 1,916            |             |      | 1,697        | 73,766               |

|                              |            |       |           |                  |  |  |  |  |  |  |  |  |  |
|------------------------------|------------|-------|-----------|------------------|--|--|--|--|--|--|--|--|--|
| EXTRA FEATURES               |            |       |           |                  |  |  |  |  |  |  |  |  |  |
| 206 PIXIE CIR, CRAWFORDVILLE |            |       |           |                  |  |  |  |  |  |  |  |  |  |
| BLD DATE                     | 11/15/2017 | RTJ/T | LGL DATE  |                  |  |  |  |  |  |  |  |  |  |
| XF DATE                      | 11/15/2017 | RTJ/T | LAND DATE | 11/15/2017 RTJ/T |  |  |  |  |  |  |  |  |  |
| INC DATE                     |            |       | AG DATE   |                  |  |  |  |  |  |  |  |  |  |

| L N | OB/XF CODE | DESCRIPTION | BLD | CAP | L  | W  | UNITS    | UT | Adj R | ADJ UNIT PRICE | ORIG COND | YEAR ON | YEAR ACTUAL | Q | % COND | OB/XF MKT VALUE | NOTES |
|-----|------------|-------------|-----|-----|----|----|----------|----|-------|----------------|-----------|---------|-------------|---|--------|-----------------|-------|
| 1   | 0620       | WOOD UTL B  | 0   | 0   | 8  | 8  | 64.00    | SF | 6.00  | 6.00           | 100       | 1989    | 1989        | 3 | 20     | 77              |       |
| 2   | 0950       | METAL SHED  | 0   | 0   | 20 | 11 | 220.00   | SF | 8.00  | 8.00           | 10        | 1989    | 1989        | 3 | 10     | 176             |       |
| 3   | 0050       | CARPORT UN  | 0   | 0   | 20 | 30 | 600.00   | SF | 9.00  | 9.00           | 100       | 1993    | 1993        | 3 | 50     | 2,700           |       |
| 4   | 0170       | GARAGE UNF  | 0   | 0   | 30 | 42 | 1,260.00 | SF | 25.00 | 25.00          | 100       | 2003    | 2003        | 3 | 60     | 18,900          |       |
| 5   | 0375       | WOOD WALK   | 0   | 0   | 22 | 3  | 66.00    | SF | 15.00 | 15.00          | 100       | 2004    | 2004        | 3 | 23     | 228             |       |
| 6   | 0700       | PORT BLDG   | 0   | 0   | 8  | 10 | 80.00    | SF | 8.00  | 8.00           | 100       | 1990    | 1990        | 3 | 47     | 301             |       |
| 7   | 0080       | 4' CHAINLI  | 0   | 0   | 0  | 0  | 300.00   | LF | 13.00 | 13.00          | 100       | 2019    | 2019        | 3 | 85     | 3,315           |       |

| LAND DESCRIPTION |          |     |                      |     |     |          |        |        |             |           |     |          |        |         |            |                |            | TOTAL OB/XF                 |      |         |      |     |    |        |  |  |  |
|------------------|----------|-----|----------------------|-----|-----|----------|--------|--------|-------------|-----------|-----|----------|--------|---------|------------|----------------|------------|-----------------------------|------|---------|------|-----|----|--------|--|--|--|
| L N              | USE CODE | CLS | LAND USE DESCRIPTION | CAP | R D | LOC ZONE | FRONT  | DEPTH  | TOT LND UTS | UNIT TYPE | D T | DPH FACT | % COND | TOT ADJ | UNIT PRICE | ADJ UNIT PRICE | LAND VALUE | OTHER ADJUSTMENTS AND NOTES | YEAR | DENSITY | DECL | FRZ | YR | CONSRV |  |  |  |
| 1                | 000201   | C   | MH                   | 0   |     |          | 136.00 | 124.00 | 1.00        | LT        |     | 1.00     | 1.00   | 1.00    | 20,000.00  | 20,000.00      | 20,000     |                             |      |         |      |     |    |        |  |  |  |

| WAKULLA COUNTY PROPERTY                       |             |     |             |
|---|-------------|-----|-------------|
| VALUATION SUMMARY                             |             |     | PAGE 1 of 1 |
| VALUATION BY                                  |             |     | STANDARD    |
| Tax Group: 3                                  | Tax Dist:   |     |             |
| BUILDING MARKET VALUE                         |             |     | 73,766      |
| TOTAL MARKET OB/XF VALUE                      |             |     | 25,697      |
| TOTAL LAND VALUE - MARKET                     |             |     | 20,000      |
| TOTAL MARKET VALUE                            |             |     | 119,463     |
| SOH/AGL Deduction                             |             |     | 21,101      |
| ASSESSED VALUE                                |             |     | 98,362      |
| TOTAL EXEMPTION VALUE                         |             |     | 0           |
| BASE TAXABLE VALUE                            |             |     | 98,362      |
| TOTAL JUST VALUE                              |             |     | 119,463     |
| NCON VALUE                                    |             |     | 0           |
| INCOME VALUE                                  |             |     |             |
| PREVIOUS YEAR MKT VALUE                       |             |     | 91,076      |
| 5YR CK JS PU XFOB                             |             |     |             |
| HX REMOVAL LETTER SENT                        |             |     |             |
| ONS HEIR WILL NEED TO FILE.                   |             |     |             |
| HUSBAND PRECEDED HER IN DEATH. REMOVE EXEMPTI |             |     |             |
| PERMIT NUM                                    | DESCRIPTION | AMT | ISSUED      |
| 15000390                                      | SFD-CO      | 0   | 05/27/2015  |
| 2007168                                       | ELEC UPGDE  | 0   | 02/05/2007  |

| SALES DATA                    |            |           |     |     |        |            |
|-------------------------------|------------|-----------|-----|-----|--------|------------|
| OFF RECORD Number             | DATE       | TYPE INST | Q U | V I | RSN CD | SALE PRICE |
| 0271/0416                     | 3/12/1996  | WD U      | U   | I   |        | 4,300      |
| GRANTOR: BRIM MARTHA H & JOHN |            |           |     |     |        |            |
| GRANTEE:                      |            |           |     |     |        |            |
| 0157/0787                     | 10/03/1989 | ID U      | V   |     |        | 100        |
| GRANTOR:                      |            |           |     |     |        |            |
| GRANTEE:                      |            |           |     |     |        |            |

| BUILDING NOTES |  |  |  |  |  |  |  |  |  |
|----------------|--|--|--|--|--|--|--|--|--|
|                |  |  |  |  |  |  |  |  |  |

| BUILDING DIMENSIONS   |  |  |  |  |  |  |  |  |  |
|---|--|--|--|--|--|--|--|--|--|
| BAS=[YR=1993] W33 CAN=[YR=2004] N8 W12 FSP=[YR=2004] W15 S8 E15 N8\$ S8 E12 \$ W27 S24 E17 FSP=[YR=2004] S10 E26 N10 W26\$ E43 N24\$. |  |  |  |  |  |  |  |  |  |