

SUMMER WIND SUB
BLK A LOT 11
OR 100 P 687 & OR 102 P 979

MYERS EDWIN III/MYERS KATHERINE C
27 SUMMERWIND CIR S
CRAWFORDVILLE, FL 32327

2024

32-2S-01E-173-04983-A11



| BUILDING CHARACTERISTICS | |
|--------------------------|-------------------|
| ELEMENT | CD |
| Foundation | 00 N/A 100 |
| Frame | 02 WOOD FRAME 100 |
| Exterior Wall | 30 VINYL 100 |
| Roof Structur | 03 GABLE/HIP 100 |
| Roof Cover | 12 MODULAR MT 100 |
| Interior Wall | 04 PLYWOOD 100 |
| Interior Floor | 08 SHT VINYL 50 |
| Interior Floor | 14 CARPET 50 |
| Heating Type | 04 AIR DUCTED 100 |
| Air Condition | 03 CENTRAL 100 |
| Bedrooms | 3 100 |
| Bathrooms | 2 100 |
| Stories | 1. 1. 100 |
| Class | 00 N/A 100 |
| Units | 0 100 |

| MARKET ADJUSTMENTS | | | | | | | | | | | | |
|--|-----|-----------|-------------|----------------|----------------|------|------|------|------|------|--------|-------|
| TYPE | MDL | EFF. AREA | TOT ADJ PTS | EFF. BASE RATE | REPL. COST NEW | AYB | EYB | ECON | FNCT | NORM | % COND | |
| 0200 | 02 | 1,264 | 110.5000 | 77.35 | 97,770 | 1994 | 1994 | 0 | 0 | 0 | 49.00 | 51.00 |
| 1 MOBILE HOM 100% - 2019 Heated Area: 1152 HX Base Yr 2019 | | | | | | | | | | | | |

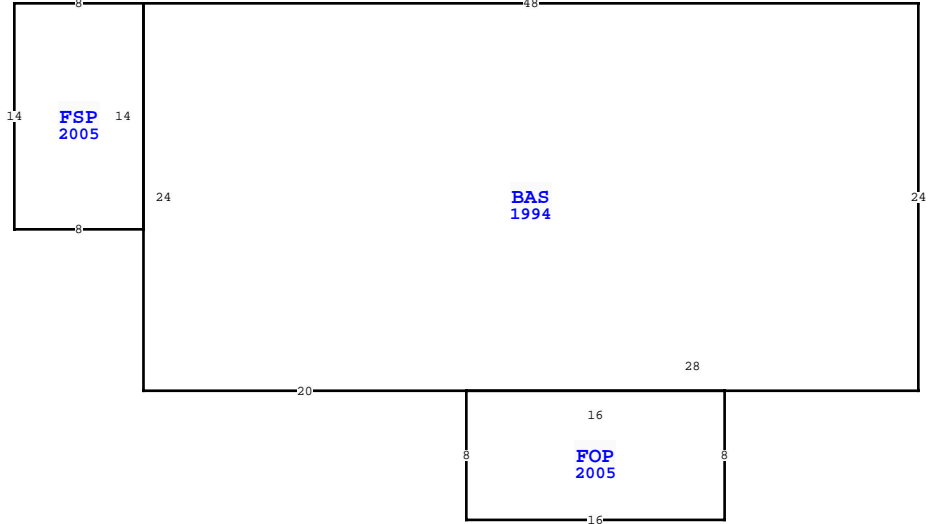

| Quality | | 03 AVERAGE | | | |
|------------------|------------------|------------------|------|--------------|----------------------|
| DOR CODE | | 0200 MOBILE HOME | | | |
| MAP NUM | | 1 MKT AREA 09 | | | |
| NEIGHBORHOOD/LOC | | 173.00 1.00/ | | | |
| AREA TYPE | TOTAL GROSS AREA | PCT OF BASE | YEAR | TOT ADJ AREA | SUBAREA MARKET VALUE |
| BAS | 1,152 | 100 | 1994 | 1,152 | 45,445 |
| FOP | 128 | 35 | 2005 | 45 | 1,775 |
| FSP | 112 | 60 | 2005 | 67 | 2,643 |
| TOTALS | 1,392 | | | 1,264 | 49,863 |

27 S SUMMERWIND CIR, CRAWFORDVILLE

| | | | | |
|----------|------------|------|-----------|-----------------|
| BLD DATE | 06/04/2021 | LRFR | LGL DATE | |
| XF DATE | 06/04/2021 | LRFR | LAND DATE | 06/04/2021 LRFR |
| INC DATE | | | AG DATE | |

| EXTRA FEATURES | | | | | | | | | | | | | | | | |
|----------------|------------|-------------|---------|-----|----|--------|----|-------|----------------|-----------|---------|-------------|---|--------|-----------------|-------|
| L N | OB/XF CODE | DESCRIPTION | BLD CAP | L | W | UNITS | UT | Adj R | ADJ UNIT PRICE | ORIG COND | YEAR ON | YEAR ACTUAL | Q | % COND | OB/XF MKT VALUE | NOTES |
| 1 | 0080 | 4' CHAINLI | 0 | 100 | 0 | 200.00 | LF | 13.00 | 13.00 | 100 | 1994 | 1994 | 3 | 20 | 520 | |
| 2 | 0055 | PORTABLE C | 0 | 100 | 20 | 240.00 | SF | 3.00 | 3.00 | 100 | 1995 | 1995 | 3 | 20 | 144 | |
| 3 | 0625 | PORT WD UT | 0 | 100 | 6 | 48.00 | SF | 6.00 | 6.00 | 100 | 1995 | 1995 | 3 | 20 | 58 | |

| LAND DESCRIPTION | | | | | | | | | | | | | | | TOTAL OB/XF | | | | | | | | | |
|------------------|----------|-----|----------------------|-----|-----|----------|-------|-------|-------------|-----------|-----|----------|--------|---------|-------------|----------------|------------|-----------------------------|------|---------|------|-----|----|--------|
| L N | USE CODE | CLS | LAND USE DESCRIPTION | CAP | R D | LOC ZONE | FRONT | DEPTH | TOT LND UTS | UNIT TYPE | D T | DPH FACT | % COND | TOT ADJ | UNIT PRICE | ADJ UNIT PRICE | LAND VALUE | OTHER ADJUSTMENTS AND NOTES | YEAR | DENSITY | DECL | FRZ | YR | CONSRV |
| 1 | 000201 | C | MH | 100 | | | 0.00 | 0.00 | 1.00 | LT | | 1.00 | 1.00 | 1.00 | 50,000.00 | 50,000.00 | 50,000 | | | | | | | |

| WAKULLA COUNTY PROPERTY | | | |
|---------------------------------------|-------------|--------------|-------------|
| VALUATION SUMMARY | | | PAGE 1 of 1 |
| VALUATION BY | | STANDARD | |
| Tax Group: 3 | | Tax Dist: | |
| BUILDING MARKET VALUE | | 49,863 | |
| TOTAL MARKET OB/XF VALUE | | 722 | |
| TOTAL LAND VALUE - MARKET | | 50,000 | |
| TOTAL MARKET VALUE | | 100,585 | |
| SOH/AGL Deduction | | 31,522 | |
| ASSESSED VALUE | | 69,063 | |
| TOTAL EXEMPTION VALUE | | HX HB 44,063 | |
| BASE TAXABLE VALUE | | 25,000 | |
| TOTAL JUST VALUE | | 100,585 | |
| NCON VALUE | | 0 | |
| INCOME VALUE | | 0 | |
| PREVIOUS YEAR MKT VALUE | | 80,377 | |
| 5 YR PRCL CH N/C-LR | | | |
| COA PER NCOA TRIM REPORT | | | |
| ADD HX FOR 2019-MYERS | | | |
| CORRECTED SALES DATE ON OR 1096 P 316 | | | |
| PERMIT NUM | DESCRIPTION | AMT | ISSUED |
| 2012566 | RE-ROOF | 0 | 08/23/2012 |
| 2005348 | PORCH | 0 | 03/17/2005 |
| 027829 | N/A | 0 | 05/24/2001 |
| 019015 | N/A | 0 | 10/28/1994 |
| 18968 | N/A | 0 | 10/13/1994 |

| SALES DATA | | | | | | |
|--------------------------------|------------|-----------|-----|-----|--------|------------|
| OFF RECORD Number | DATE | TYPE INST | Q U | V I | RSN CD | SALE PRICE |
| 1096/0316 | 12/28/2018 | WD Q | Q | I | 01 | 95,000 |
| GRANTOR: HARRISON JANET DALTON | | | | | | |
| GRANTEE: MYERS EDWIN III AND | | | | | | |
| 0354/0692 | 6/01/1999 | WD U | U | I | | 100 |
| GRANTOR: HARRISON JANET DALTON | | | | | | |
| GRANTEE: | | | | | | |

| BUILDING NOTES |
|----------------|
| |

| BUILDING DIMENSIONS |
|---|
| BAS=[YR=1994] W48 FSP=[YR=2005] W8 S14 E8 N14\$ S24 E20 FOP=[YR=2005] S8 E16 N8 W16\$ E28 N24\$. |