

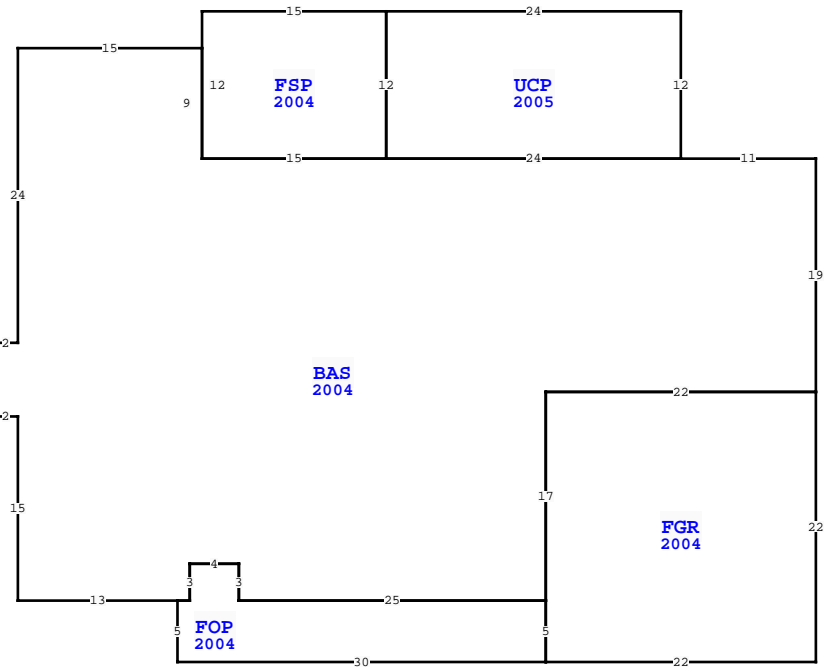

| BUILDING CHARACTERISTICS | | CONSTRUCTION | |
|--------------------------|------------------|---------------|------|
| ELEMENT | CD | | |
| Foundation | 02 | CONCR SLAB | 100 |
| Frame | 02 | WOOD FRAME | 100 |
| Exterior Wall | 05 | HARDIE BRD | 70 |
| Exterior Wall | 19 | COMMON BRK | 30 |
| Roof Structur | 03 | GABLE/HIP | 100 |
| Roof Cover | 03 | COMP SHNGL | 100 |
| Interior Wall | 05 | DRYWALL | 100 |
| Interior Floo | 11 | CLAY TILE | 50 |
| Interior Floo | 14 | CARPET | 50 |
| Heating Type | 04 | AIR DUCTED | 100 |
| Air Condition | 03 | CENTRAL | 100 |
| Bedrooms | | 3 | 100 |
| Bathrooms | | 2 | 100 |
| Story Height | | 0 | 100 |
| Stories | 1. | 1. | 100 |
| Units | | 0 | 100 |
| Quality | 03 | AVERAGE | |
| DOR CODE | 0100 | SINGLE FAMILY | |
| MAP NUM | 1 | MKT AREA | 09 |
| NEIGHBORHOOD/LOC | 000 | 1.00/ | |
| AREA TYPE | TOTAL GROSS AREA | PCT OF BASE | YEAR |
| BAS | 2,101 | 100 | 2004 |
| FGR | 484 | 50 | 2004 |
| FOP | 162 | 30 | 2004 |
| FSP | 180 | 55 | 2004 |
| UCP | 288 | 20 | 2005 |
| TOTALS | 3,215 | | |

| MARKET ADJUSTMENTS | | | | | | | | | | | | | |
|--|-----|-----------|-------------|----------------|----------------|------|------|------|------|-------|--------|--|--|
| TYPE | MDL | EFF. AREA | TOT ADJ PTS | EFF. BASE RATE | REPL. COST NEW | AYB | EYB | ECON | FNCT | NORM | % COND | | |
| 0100 | 01 | 2,549 | 120.1000 | 114.10 | 290,841 | 2004 | 2008 | 0 | 0 | 15.00 | 85.00 | | |
| 1 SINGLE FAM 100% - 2005 Heated Area: 2101 HX Base Yr 2005 | | | | | | | | | | | | | |



| WAKULLA COUNTY PROPERTY | | | |
|--|--------------|--------|-------------|
| VALUATION SUMMARY | | | PAGE 1 of 1 |
| VALUATION BY | | | STANDARD |
| Tax Group: 3 | Tax Dist: | | |
| BUILDING MARKET VALUE | | | 247,215 |
| TOTAL MARKET OB/XF VALUE | | | 2,898 |
| TOTAL LAND VALUE - MARKET | | | 18,000 |
| TOTAL MARKET VALUE | | | 268,113 |
| SOH/AGL Deduction | | | 85,155 |
| ASSESSED VALUE | | | 182,958 |
| TOTAL EXEMPTION VALUE | HX HB | 50,000 | |
| BASE TAXABLE VALUE | | | 132,958 |
| TOTAL JUST VALUE | | | 268,113 |
| NCON VALUE | | | 0 |
| INCOME VALUE | | | |
| PREVIOUS YEAR MKT VALUE | | | 259,726 |
| INCR EYB 2004-2008 RE-ROOF OB23-202 CC 6/13/2023 | | | |
| 5 YR PRCL CH N/C-LR | | | |
| 5 YR PRCL CH, PU CORR TRAV | | | |
| LN 2-3, NEW TRAV, PU FNDN & FRME | | | |
| PERMIT NUM | DESCRIPTION | AMT | ISSUED |
| OB23-000202 | RE-ROOF - CC | 0 | 04/26/2023 |
| 31891 | SFR | 0 | 05/28/2004 |

| SALES DATA | | | | | | |
|--------------------------------|------------|-----------|-------|-------|--------|------------|
| OFF RECORD Number | DATE | TYPE INST | Q / U | V / I | RSN CD | SALE PRICE |
| 0537/0759 | 5/07/2004 | WD Q | Q | V | | 30,000 |
| GRANTOR: WAKULLA FOREST GENERA | | | | | | |
| GRANTEE: SAMLAL | | | | | | |
| 0516/0387 | 12/10/2003 | WD Q | Q | V | | 29,900 |
| GRANTOR: WFGP | | | | | | |
| GRANTEE: WAKULLA BUILDERS LL | | | | | | |

| EXTRA FEATURES | | | | | | | | | | | | | | | | |
|----------------|------------|-------------|---------|-----|----|----------|----|-------|----------------|-----------|---------|-------------|---|--------|-----------------|-------|
| L N | OB/XF CODE | DESCRIPTION | BLD CAP | L | W | UNITS | UT | Adj R | ADJ UNIT PRICE | ORIG COND | YEAR ON | YEAR ACTUAL | Q | % COND | OB/XF MKT VALUE | NOTES |
| 1 | 0210 | CONCRETE D | 0 | 100 | 0 | 1,584.00 | SF | 6.00 | 6.00 | 100 | 2004 | 2004 | 3 | 23 | 2,186 | |
| 2 | 0211 | CONCRETE W | 0 | 100 | 62 | 186.00 | SF | 6.00 | 6.00 | 100 | 2005 | 2005 | 3 | 24 | 268 | |
| 3 | 0955 | PRIVACY FE | 0 | 100 | 0 | 148.00 | LF | 15.00 | 15.00 | 100 | 2005 | 2005 | 3 | 20 | 444 | |
| TOTALS | | | | | | | | | | | | | | 2,898 | | |

| BUILDING NOTES | | | | | | | | | | | | | |
|---|--|--|--|--|--|--|--|--|--|--|--|--|--|
| BAS=[YR=2004] W11 UCP=[YR=2005] N12 W24 S12 E24\$ W24 | | | | | | | | | | | | | |
| FSP=[YR=2004] N12 W15 S12 E15\$ W15 N9 W15 S24 W2 S6 E2 S15 | | | | | | | | | | | | | |
| E13 FOP=[YR=2004] S5 E30 N5 W25 N3 W4 S3 W1\$ E1 N3 E4 S3 E25 | | | | | | | | | | | | | |
| FGR=[YR=2004] S5 E22 N22 W22 S17 \$ N17 E22 N19\$. | | | | | | | | | | | | | |

| LAND DESCRIPTION | | | | | | | | | | | | | | TOTAL OB/XF | | | | | | | | | | |
|------------------|----------|-----|----------------------|-----|-----|----------|--------|--------|-------------|-----------|-----|-----------|--------|-------------|------------|----------------|------------|-----------------------------|------|---------|------|-----|----|--------|
| L N | USE CODE | CLS | LAND USE DESCRIPTION | CAP | R D | LOC ZONE | FRONT | DEPTH | TOT LND UTS | UNIT TYPE | D T | DPHT FACT | % COND | TOT ADJ | UNIT PRICE | ADJ UNIT PRICE | LAND VALUE | OTHER ADJUSTMENTS AND NOTES | YEAR | DENSITY | DECL | FRZ | YR | CONSRV |
| 1 | 000100 | C | SFR | 100 | | | 254.00 | 315.00 | 1.00 | LT | | 1.00 | 1.00 | 1.00 | 18,000.00 | 18,000.00 | 18,000 | | | | | | | |