

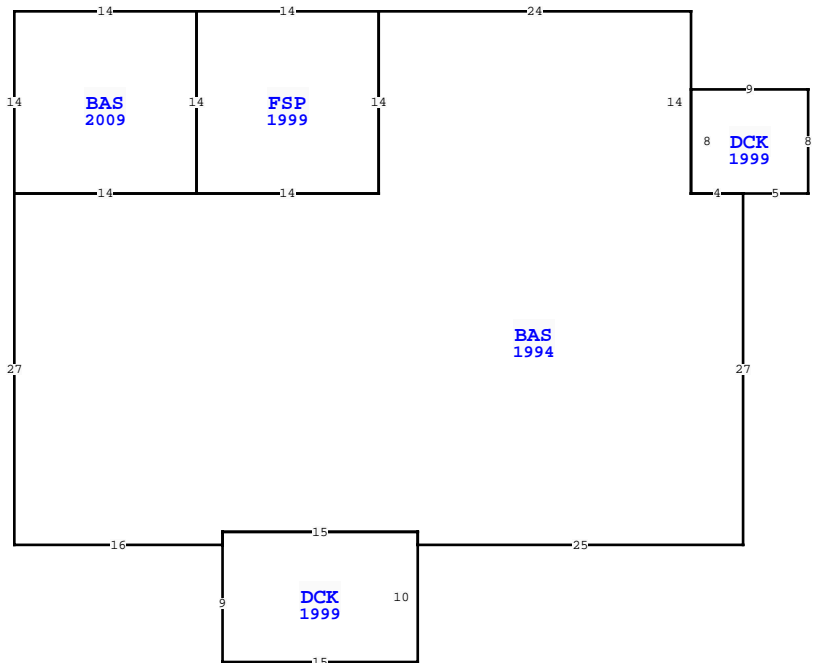

BUILDING CHARACTERISTICS		
ELEMENT	CD	CONSTRUCTION
Foundation	01	WOOD FRAME 100
Frame	02	WOOD FRAME 100
Exterior Wall	30	VINYL 100
Roof Structur	03	GABLE/HIP 100
Roof Cover	03	COMP SHNGL 100
Interior Wall	04	PLYWOOD 100
Interior Floo	08	SHT VINYL 50
Interior Floo	14	CARPET 50
Heating Type	04	AIR DUCTED 100
Air Condition	03	CENTRAL 100
Bedrooms		3 100
Bathrooms		2 100
Stories	1.	1. 100
Class	00	N/A 100
Units		0 100

MARKET ADJUSTMENTS														
TYPE	MDL	EFF. AREA	TOT ADJ PTS	EFF. BASE RATE	REPL. COST NEW	AYB	EYB	ECON	FNCT	NORM	% COND			
0200	02	2,169	96.7500	67.72	146,885	1994	1994	0	0	0	49.00	51.00		
1 MOBILE HOM 100% - 2010 Heated Area: 2029 HX Base Yr 2010														



Quality	08	FAIR			
DOR CODE	0200	MOBILE HOME			
MAP NUM	1	MKT AREA 09			
NEIGHBORHOOD/LOC	000	1.00/			
AREA TYPE	TOTAL GROSS AREA	PCT OF BASE	YEAR	TOT ADJ AREA	SUBAREA MARKET VALUE
BAS	1,833	100	1994	1,833	63,307
BAS	196	100	2009	196	6,769
DCK	72	10	1999	7	242
DCK	150	10	1999	15	518
FSP	196	60	1999	118	4,075
TOTALS	2,447			2,169	74,911

WAKULLA COUNTY PROPERTY			
VALUATION SUMMARY			PAGE 1 of 1
VALUATION BY			STANDARD
Tax Group: 3			Tax Dist:
BUILDING MARKET VALUE			74,911
TOTAL MARKET OB/XF VALUE			6,743
TOTAL LAND VALUE - MARKET			21,300
TOTAL MARKET VALUE			102,954
SOH/AGL Deduction			52,116
ASSESSED VALUE			50,838
TOTAL EXEMPTION VALUE	HX HB		25,838
BASE TAXABLE VALUE			25,000
TOTAL JUST VALUE			102,954
NCON VALUE			0
INCOME VALUE			
PREVIOUS YEAR MKT VALUE			83,259
5 yr prcl ck, locked gate,2-16-24			
5YR PRCL CK NC			
CODE XFOB LN 2&4, PU XFOB LN 5-9			
CHG QUAL, CHG CODE & DIMENS XFOB LN 1&3, CHG			
PERMIT NUM	DESCRIPTION	AMT	ISSUED
18953	N/A	0	10/07/1994

SALES DATA						
OFF RECORD Number	DATE	TYPE INST	Q / U	V / I	RSN CD	SALE PRICE
0799/0030	7/06/2009	WD Q	Q	I	01	114,400
GRANTOR: SWEET BETTY A						
GRANTEE: SPIVEY KAREN L & CH						
0333/0880	9/11/1998	WD U	I			100
GRANTOR:						
GRANTEE:						

EXTRA FEATURES																
L N	OB/XF CODE	DESCRIPTION	BLD CAP	L	W	UNITS	UT	Adj R	ADJ UNIT PRICE	ORIG COND	YEAR ON	YEAR ACTUAL	Q	% COND	OB/XF MKT VALUE	NOTES
1	0700	PORT BLDG	0	100	8	10			8.00	100	1998	1998	3	55	352	
2	0700	PORT BLDG	0	100	12	12			8.00	100	1998	1998	3	55	634	
3	0700	PORT BLDG	0	100	10	24			8.00	100	1998	1998	3	55	1,056	
4	0700	PORT BLDG	0	100	12	24			8.00	100	1998	1998	3	55	1,267	
5	0130	FIRE PLACE	0	100	0	0			1,300.00	100	1994	1994	3	51	663	
6	0055	PORTABLE C	0	100	18	20			3.00	100	1998	1998	3	20	216	
7	0060	DECK WOOD	0	100	0	0			5.00	100	2000	2000	3	20	321	
8	0250	ASPHALT AV	0	100	0	0			5,092.00	100	2000	2000	3	20	2,037	
9	0625	PORT WD UT	0	100	7	12			6.00	100	2009	2009	3	39	197	
TOTALS														6,743		

LAND DESCRIPTION																								
L N	USE CODE	CLS	LAND USE DESCRIPTION	CAP	R D	LOC ZONE	FRONT	DEPTH	TOT LND UTS	UNIT TYPE	D T	DPH FACT	% COND	TOT ADJ	UNIT PRICE	ADJ UNIT PRICE	LAND VALUE	OTHER ADJUSTMENTS AND NOTES	YEAR	DENSITY	DECL	FRZ	YR	CONSRV
1	000201	C	MH	100			0.00	0.00	2.84	AC		1.00	1.00	1.00	7,500.00	7,500.00	21,300							

BUILDING NOTES													
BUILDING DIMENSIONS													
BAS=[YR=1994] W24 FSP=[YR=1999] W14 S14 E14 N14\$ S14 W14 BAS=[YR=2009] N14 W14 S14 E14\$ W14 S27 E16 DCK=[YR=1999] S9 E15 N10 W15 S1\$ N1 E15 S1 E25 N27 DCK=[YR=1999] E5 N8 W9 S8 E4\$ W4 N14\$.													