

| BUILDING CHARACTERISTICS |                  |                |      |              |                      |
|--------------------------|------------------|----------------|------|--------------|----------------------|
| ELEMENT                  | CD               | CONSTRUCTION   |      |              |                      |
| Foundation               | 01               | WOOD FRAME 100 |      |              |                      |
| Frame                    | 02               | WOOD FRAME 100 |      |              |                      |
| Exterior Wall            | 30               | VINYL 100      |      |              |                      |
| Roof Structur            | 03               | GABLE/HIP 100  |      |              |                      |
| Roof Cover               | 13               | GALVALUM 100   |      |              |                      |
| Interior Wall            | 05               | DRYWALL 100    |      |              |                      |
| Interior Floo            | 10               | LAMINATED 50   |      |              |                      |
| Interior Floo            | 11               | CLAY TILE 50   |      |              |                      |
| Heating Type             | 04               | AIR DUCTED 100 |      |              |                      |
| Air Condition            | 03               | CENTRAL 100    |      |              |                      |
| Bedrooms                 |                  | 3 100          |      |              |                      |
| Bathrooms                |                  | 2 100          |      |              |                      |
| Stories                  | 1.               | 1. 100         |      |              |                      |
| Class                    | 00               | N/A 100        |      |              |                      |
| Units                    |                  | 0 100          |      |              |                      |
| Quality                  | 08               | FAIR           |      |              |                      |
| DOR CODE                 | 0200             | MOBILE HOME    |      |              |                      |
| MAP NUM                  | 1                | MKT AREA 09    |      |              |                      |
| NEIGHBORHOOD/LOC         | 189.00           | 1.00/          |      |              |                      |
| AREA TYPE                | TOTAL GROSS AREA | PCT OF BASE    | YEAR | TOT ADJ AREA | SUBAREA MARKET VALUE |
| BAS                      | 1,568            | 100            | 1993 | 1,568        | 51,723               |
| DCK                      | 192              | 10             | 1993 | 19           | 627                  |
| DCK                      | 288              | 10             | 1993 | 29           | 957                  |
| TOTALS                   | 2,048            |                |      | 1,616        | 53,307               |

| MARKET ADJUSTMENTS                               |     |           |             |                |                |      |      |      |      |       |        |
|--|-----|-----------|-------------|----------------|----------------|------|------|------|------|-------|--------|
| TYPE   | MDL | EFF. AREA | TOT ADJ PTS | EFF. BASE RATE | REPL. COST NEW | AYB  | EYB  | ECON | FNCT | NORM  | % COND |
| 0200   | 02  | 1,616     | 107.1000    | 74.97          | 121,152        | 1987 | 1987 | 0    | 0    | 56.00 | 44.00  |
| 1 MOBILE HOM 0% - 0 Heated Area: 1568 HX Base Yr |     |           |             |                |                |      |      |      |      |       |        |

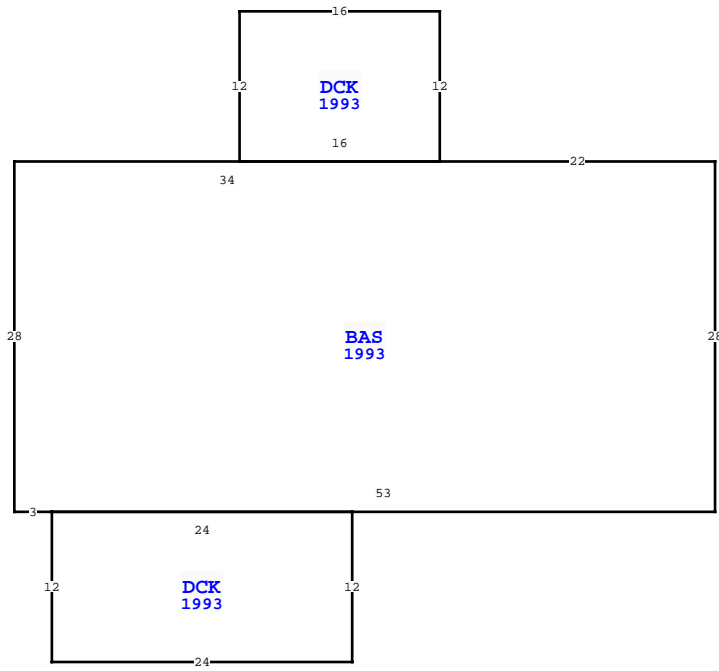

| WAKULLA COUNTY PROPERTY                       |             |     |             |
|---|-------------|-----|-------------|
| VALUATION SUMMARY                             |             |     | PAGE 1 of 1 |
| VALUATION BY                                  |             |     | STANDARD    |
| Tax Group: 3                                  | Tax Dist:   |     |             |
| BUILDING MARKET VALUE                         |             |     | 53,307      |
| TOTAL MARKET OB/XF VALUE                      |             |     | 114         |
| TOTAL LAND VALUE - MARKET                     |             |     | 20,000      |
| TOTAL MARKET VALUE                            |             |     | 73,421      |
| SOH/AGL Deduction                             |             |     | 5,714       |
| ASSESSED VALUE                                |             |     | 67,707      |
| TOTAL EXEMPTION VALUE                         |             |     | 0           |
| BASE TAXABLE VALUE                            |             |     | 67,707      |
| TOTAL JUST VALUE                              |             |     | 73,421      |
| NCON VALUE                                    |             |     | 0           |
| INCOME VALUE                                  |             |     |             |
| PREVIOUS YEAR MKT VALUE                       |             |     | 61,552      |
| CHG INTW, FLOORING DEL XFOB 0625,0940 PU 0940 |             |     |             |
| XFOB LN 2, DEL XFOB LN 3                      |             |     |             |
| 5 YR PRCL CH, PU FNDN, CHG QUAL, RCVR, PU     |             |     |             |
| HX IS OK                                      |             |     |             |
| PERMIT NUM                                    | DESCRIPTION | AMT | ISSUED      |
| 20051193                                      | REROOF      | 0   | 08/08/2005  |
| 025342  | VINYL       | 0   | 06/22/1999  |

| SALES DATA                     |           |           |       |       |        |            |
|--------------------------------|-----------|-----------|-------|-------|--------|------------|
| OFF RECORD Number              | DATE      | TYPE INST | Q / U | V / I | RSN CD | SALE PRICE |
| 1171/0770                      | 9/29/2020 | WD Q      | Q     | I     | 01     | 37,000     |
| GRANTOR: COOL CATS AND KITTENS |           |           |       |       |        |            |
| GRANTEE: CALDERON JAVIER       |           |           |       |       |        |            |
| 1169/0722                      | 9/15/2020 | QC U      | U     | I     | 11     | 20,400     |
| GRANTOR: DEUTSCHE BANK NATIONA |           |           |       |       |        |            |
| GRANTEE: COOL CATS AND KITTE   |           |           |       |       |        |            |

| EXTRA FEATURES |            |             |         |     |       |    |       |                |           |         |             |   |        |                 |       |
|----------------|------------|-------------|---------|-----|-------|----|-------|----------------|-----------|---------|-------------|---|--------|-----------------|-------|
| L N            | OB/XF CODE | DESCRIPTION | BLD CAP | L W | UNITS | UT | Adj R | ADJ UNIT PRICE | ORIG COND | YEAR ON | YEAR ACTUAL | Q | % COND | OB/XF MKT VALUE | NOTES |
| 1              | 0940       | OPEN SHED   | 0       | 0   | 4     | 8  |       | 32.00 SF 4.00  | 100       | 2020    | 2020        | 3 | 89     | 114             |       |

| BLD DATE |  | 07/07/2021 | FRJS | LGL DATE  | 07/07/2021 | FRJS |
|----------|--|------------|------|-----------|------------|------|
| XF DATE  |  | 07/07/2021 | FRJS | LAND DATE | 07/07/2021 | FRJS |
| INC DATE |  |            |      | AG DATE   |            |      |

| BUILDING NOTES  |  |
|---|--|
| BAS=[YR=1993] W22 DCK=[YR=1993] N12 W16 S12 E16\$ W34 S28 E3 DCK=[YR=1993] S12 E24 N12 W24\$ E53 N28\$. |  |

| LAND DESCRIPTION |          | TOTAL OB/XF |                      |     |     |          |       |       |             |           |     |          |        |         |            |                |            |                             |      |         |      |     |    |        |
|------------------|----------|-------------|----------------------|-----|-----|----------|-------|-------|-------------|-----------|-----|----------|--------|---------|------------|----------------|------------|-----------------------------|------|---------|------|-----|----|--------|
| L N              | USE CODE | CLS         | LAND USE DESCRIPTION | CAP | R D | LOC ZONE | FRONT | DEPTH | TOT LND UTS | UNIT TYPE | D T | DPH FACT | % COND | TOT ADJ | UNIT PRICE | ADJ UNIT PRICE | LAND VALUE | OTHER ADJUSTMENTS AND NOTES | YEAR | DENSITY | DECL | FRZ | YR | CONSRV |
| 1                | 000201   | C           | MH                   | 0   |     |          | 0.00  | 0.00  | 1.00        | LT        |     | 1.00     | 1.00   | 1.00    | 10,000.00  | 10,000.00      | 10,000     |                             |      |         |      |     |    |        |
| 2                | 000000   | C           | VAC RES              | 0   |     |          | 0.00  | 0.00  | 1.00        | LT        |     | 1.00     | 1.00   | 1.00    | 10,000.00  | 10,000.00      | 10,000     |                             |      |         |      |     |    |        |