

| BUILDING CHARACTERISTICS | | |
|--------------------------|----|----------------|
| ELEMENT | CD | CONSTRUCTION |
| Foundation | 01 | WOOD FRAME 100 |
| Frame | 02 | WOOD FRAME 100 |
| Exterior Wall | 30 | VINYL 100 |
| Roof Structur | 03 | GABLE/HIP 100 |
| Roof Cover | 03 | COMP SHNGL 100 |
| Interior Wall | 05 | DRYWALL 100 |
| Interior Floo | 08 | SHT VINYL 50 |
| Interior Floo | 14 | CARPET 50 |
| Heating Type | 04 | AIR DUCTED 100 |
| Air Condition | 03 | CENTRAL 100 |
| Bedrooms | | 3 100 |
| Bathrooms | | 2 100 |
| Stories | 1. | 1. 100 |
| Class | 00 | N/A 100 |
| Units | | 0 100 |

| MARKET ADJUSTMENTS | | | | | | | | | | | | |
|--------------------|-----|-----------|-------------|----------------|----------------|------|------|------|------|-------|--------|--|
| TYPE | MDL | EFF. AREA | TOT ADJ PTS | EFF. BASE RATE | REPL. COST NEW | AYB | EYB | ECON | FNCT | NORM | % COND | |
| 0200 | 02 | 2,105 | 107.5000 | 75.25 | 158,401 | 2007 | 2007 | 0 | 0 | 32.00 | 68.00 | |

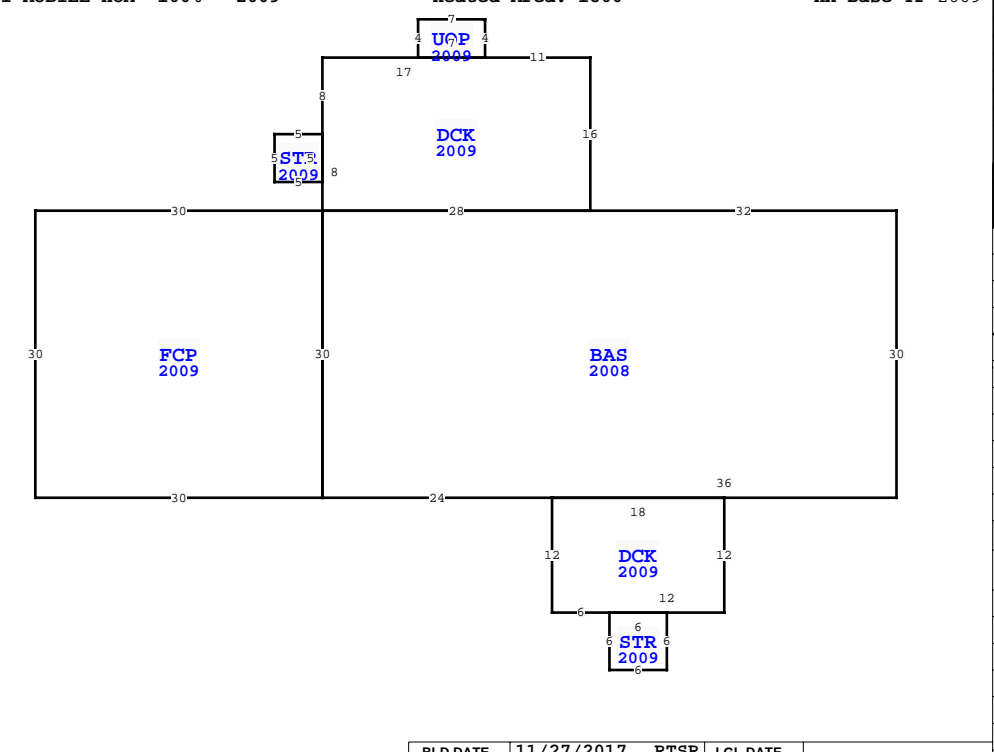

| WAKULLA COUNTY PROPERTY | | | |
|---------------------------|--|--------------|-------------|
| VALUATION SUMMARY | | | PAGE 1 of 1 |
| VALUATION BY | | STANDARD | |
| Tax Group: 3 | | Tax Dist: | |
| BUILDING MARKET VALUE | | 107,713 | |
| TOTAL MARKET OB/XF VALUE | | 31,119 | |
| TOTAL LAND VALUE - MARKET | | 50,000 | |
| TOTAL MARKET VALUE | | 188,832 | |
| SOH/AGL Deduction | | 71,968 | |
| ASSESSED VALUE | | 116,864 | |
| TOTAL EXEMPTION VALUE | | HX HB 50,000 | |
| BASE TAXABLE VALUE | | 66,864 | |
| TOTAL JUST VALUE | | 188,832 | |
| NCON VALUE | | 0 | |
| INCOME VALUE | | | |
| PREVIOUS YEAR MKT VALUE | | 165,188 | |

JS 5YR CK; GOOG EARTH; PU XFOB POLE BARN
 LOT 28 COMBINED INTO THIS PRCL FROM 04209-D28
 5 YR PRCL CH, PU XFOB LN 4-7
 5 YR PRCL CH, PU XFOB LN 3, PU NEW TRAV

| PERMIT NUM | DESCRIPTION | AMT | ISSUED |
|------------|-------------|-----|------------|
| 17000111 | REROOF-CO | 0 | 11/01/2017 |
| 200868 | A/C | 0 | 01/28/2008 |
| 200857 | MH-CO | 0 | 01/24/2008 |

| SALES DATA | | | | | | |
|-------------------|-----------|-----------|-------|-------|--------|------------|
| OFF RECORD Number | DATE | TYPE INST | Q / U | V / I | RSN CD | SALE PRICE |
| 0714/0037 | 6/08/2007 | WD | Q | V | 03 | 37,500 |

GRANTOR: LORENZO DARIO & FRANCO
 GRANTEE: CHESTNUT ERIC B.

| BUILDING NOTES | |
|----------------|--|
| | |

| BUILDING DIMENSIONS | |
|---|--|
| BAS=[YR=2008] W32 DCK=[YR=2009] N16 W11 UOP=[YR=2009] N4 W7 S4 E7\$ W17 S8 STR=[YR=2009] W5 S5 E5 N5\$ S8 E28\$ W28 FCP=[YR=2009] W30 S30 E30 N30\$ S30 E24 DCK=[YR=2009] S12 E6 STR=[YR=2009] S6 E6 N6 W6\$ E12 N12 W18\$ E36 N30\$. | |

| QUALITY | CD | CONSTRUCTION | | | |
|------------------|------------------|--------------|------|--------------|----------------------|
| 03 | | AVERAGE | | | |
| DOR CODE | 0200 | MOBILE HOME | | | |
| MAP NUM | 2 | MKT AREA 11 | | | |
| NEIGHBORHOOD/LOC | 000 | 1.00/ | | | |
| AREA TYPE | TOTAL GROSS AREA | PCT OF BASE | YEAR | TOT ADJ AREA | SUBAREA MARKET VALUE |
| BAS | 1,800 | 100 | 2008 | 1,800 | 92,106 |
| DCK | 216 | 10 | 2009 | 22 | 1,126 |
| DCK | 448 | 10 | 2009 | 45 | 2,302 |
| FCP | 900 | 25 | 2009 | 225 | 11,513 |
| STR | 25 | 10 | 2009 | 2 | 103 |
| STR | 36 | 10 | 2009 | 4 | 205 |
| UOP | 28 | 25 | 2009 | 7 | 358 |
| TOTALS | 3,453 | | | 2,105 | 107,713 |

| EXTRA FEATURES | | | | | | | | | | | | | | | | |
|----------------|------------|-------------|---------|----|----|----------|----|-------|----------------|-----------|---------|-------------|---|--------|-----------------|-------|
| L N | OB/XF CODE | DESCRIPTION | BLD CAP | L | W | UNITS | UT | Adj R | ADJ UNIT PRICE | ORIG COND | YEAR ON | YEAR ACTUAL | Q | % COND | OB/XF MKT VALUE | NOTES |
| 1 | 0700 | PORT BLDG | 0 100 | 16 | 10 | 160.00 | SF | 8.00 | 8.00 | 100 | 2007 | 2007 | 3 | 68 | 870 | |
| 2 | 0700 | PORT BLDG | 0 100 | 12 | 12 | 144.00 | SF | 8.00 | 8.00 | 100 | 2007 | 2007 | 3 | 68 | 783 | |
| 3 | 0211 | CONCRETE W | 0 100 | 5 | 8 | 40.00 | SF | 6.00 | 6.00 | 100 | 2009 | 2009 | 3 | 39 | 94 | |
| 4 | 0055 | PORTABLE C | 0 100 | 35 | 18 | 630.00 | SF | 3.00 | 3.00 | 100 | 2013 | 2013 | 3 | 57 | 1,077 | |
| 5 | 0630 | METAL UTL | 0 100 | 28 | 24 | 672.00 | SF | 8.00 | 8.00 | 100 | 2014 | 2014 | 3 | 62 | 3,333 | |
| 6 | 0950 | METAL SHED | 0 100 | 20 | 10 | 200.00 | SF | 8.00 | 8.00 | 100 | 2014 | 2014 | 3 | 62 | 992 | |
| 7 | 0955 | PRIVACY FE | 0 100 | 0 | 0 | 200.00 | LF | 15.00 | 15.00 | 100 | 2014 | 2014 | 3 | 79 | 2,370 | |
| 8 | 0025 | BARN, POLE | 0 100 | 60 | 40 | 2,400.00 | SF | 12.50 | 12.50 | 100 | 2016 | 2016 | 3 | 72 | 21,600 | |

| LAND DESCRIPTION | | | | | | | | | | | | | | | | | | | | | | | | |
|--------------------|----------|-----|----------------------|-----|-----|----------|-------|-------|-------------|-----------|-----|-----------|--------|---------|------------|----------------|------------|-----------------------------|------|---------|------|-----|----|--------|
| TOTAL OB/XF 31,119 | | | | | | | | | | | | | | | | | | | | | | | | |
| L N | USE CODE | CLS | LAND USE DESCRIPTION | CAP | R D | LOC ZONE | FRONT | DEPTH | TOT LND UTS | UNIT TYPE | D T | DPTH FACT | % COND | TOT ADJ | UNIT PRICE | ADJ UNIT PRICE | LAND VALUE | OTHER ADJUSTMENTS AND NOTES | YEAR | DENSITY | DECL | FRZ | YR | CONSRV |
| 1 | 000100 | C | SFR | 100 | | | 0.00 | 0.00 | 2.00 | LT | | 1.00 | 1.00 | 1.00 | 25,000.00 | 25,000.00 | 50,000 | | | | | | | |