

| ELEMENT | | BUILDING CHARACTERISTICS | |
|------------------|------------------|--------------------------|------|
| ELEMENT | CD | CONSTRUCTION | |
| Foundation | 03 | CONCR STEM 100 | |
| Frame | 02 | WOOD FRAME 100 | |
| Exterior Wall | 06 | BD/BATTEN 100 | |
| Roof Structur | 03 | GABLE/HIP 100 | |
| Roof Cover | 03 | COMP SHNGL 100 | |
| Interior Wall | 05 | DRYWALL 70 | |
| Interior Wall | 06 | CUST PANEL 30 | |
| Interior Floo | 14 | CARPET 70 | |
| Interior Floo | 09 | PINE WOOD 30 | |
| Heating Type | 04 | AIR DUCTED 100 | |
| Air Condition | 03 | CENTRAL 100 | |
| Bedrooms | | 3 100 | |
| Bathrooms | | 2 100 | |
| Story Height | | 0 100 | |
| Stories | 1. | 1. 100 | |
| Units | | 0 100 | |
| Quality | 03 | AVERAGE | |
| DOR CODE | 0100 | SINGLE FAMILY | |
| MAP NUM | 4 | MKT AREA | 03 |
| NEIGHBORHOOD/LOC | 116.00 | 1.00/ | |
| AREA TYPE | TOTAL GROSS AREA | PCT OF BASE | YEAR |
| BAS | 1,980 | 100 | 1993 |
| FEP | 260 | 80 | 1993 |
| FOP | 224 | 30 | 2010 |
| FOP | 224 | 30 | 2010 |
| TOTALS | 2,688 | | |

| MARKET ADJUSTMENTS | | | | | | | | | | | | | |
|------------------------------|------------|-----------|-------------|----------------|----------------|------|------|------|------|-------|--------|--|--|
| TYPE | MDL | EFF. AREA | TOT ADJ PTS | EFF. BASE RATE | REPL. COST NEW | AYB | EYB | ECON | FNCT | NORM | % COND | | |
| 1 | SINGLE FAM | 100% - 0 | | | 248,593 | 1989 | 1989 | 0 | 0 | 34.00 | 66.00 | | |
| Heated Area: 2188 HX Base Yr | | | | | | | | | | | | | |

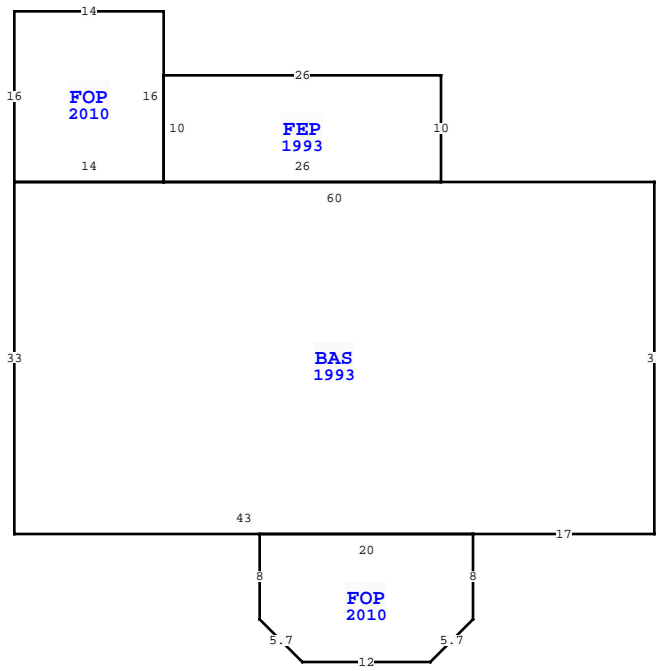

| WAKULLA COUNTY PROPERTY | | | |
|---|-------------|-----|-------------|
| VALUATION SUMMARY | | | PAGE 1 of 1 |
| VALUATION BY | | | STANDARD |
| Tax Group: 3 | Tax Dist: | | |
| BUILDING MARKET VALUE | | | 164,071 |
| TOTAL MARKET OB/XF VALUE | | | 5,203 |
| TOTAL LAND VALUE - MARKET | | | 7,600 |
| TOTAL MARKET VALUE | | | 176,874 |
| SOH/AGL Deduction | | | 60,633 |
| ASSESSED VALUE | | | 116,241 |
| TOTAL EXEMPTION VALUE | HX HB WX SX | | 105,000 |
| BASE TAXABLE VALUE | | | 11,241 |
| TOTAL JUST VALUE | | | 176,874 |
| NCON VALUE | | | 0 |
| INCOME VALUE | | | |
| PREVIOUS YEAR MKT VALUE | | | 179,479 |
| 2024 TRIM RTS - UTF | | | |
| 5 YR PRCL CH, CHG FLOR | | | |
| 5 YR PRCL CH, PU FNDN & FRME, PU CORR TRAV | | | |
| XFOB LN 1, CORRECT CODE & PU DIMENS XFOB LN 2 | | | |
| PERMIT NUM | DESCRIPTION | AMT | ISSUED |
| | | | |

| SALES DATA | | | | | | |
|------------------------------|-----------|-----------|-----|-----|--------|------------|
| OFF RECORD Number | DATE | TYPE INST | Q U | V I | RSN CD | SALE PRICE |
| 0939/0087 | 4/08/2014 | WD U | I | 11 | | 100 |
| GRANTOR: JONES LAURA C | | | | | | |
| GRANTEE: JONES LAURA C AS TR | | | | | | |
| 0138/0058 | 2/01/1988 | WD U | V | | | 7,500 |
| GRANTOR: | | | | | | |
| GRANTEE: | | | | | | |

| EXTRA FEATURES | | | | | | | | | | | | | | | | |
|----------------|------------|-------------|---------|-----|----|-------|----|-------|----------------|-----------|---------|-------------|---|--------|-----------------|-------|
| L N | OB/XF CODE | DESCRIPTION | BLD CAP | L | W | UNITS | UT | Adj R | ADJ UNIT PRICE | ORIG COND | YEAR ON | YEAR ACTUAL | Q | % COND | OB/XF MKT VALUE | NOTES |
| 1 | 0170 | GARAGE UNF | 0 | 100 | 16 | 24 | | | 25.00 | 100 | 1990 | 1990 | 3 | 47 | 4,512 | |
| 2 | 0050 | CARPORT UN | 0 | 100 | 16 | 10 | SF | 9.00 | 9.00 | 100 | 1991 | 1991 | 3 | 48 | 691 | |
| TOTALS | | | | | | | | | | | | | | 2,322 | 164,071 | |

| LAND DESCRIPTION | | | | | | | | | | | | | | TOTAL OB/XF | | | | | | | | | | |
|------------------|----------|-----|----------------------|-----|-----|----------|--------|--------|-------------|-----------|-----|----------|--------|-------------|------------|----------------|------------|-----------------------------|------|---------|------|-----|----|--------|
| L N | USE CODE | CLS | LAND USE DESCRIPTION | CAP | R D | LOC ZONE | FRONT | DEPTH | TOT LND UTS | UNIT TYPE | D T | DPH FACT | % COND | TOT ADJ | UNIT PRICE | ADJ UNIT PRICE | LAND VALUE | OTHER ADJUSTMENTS AND NOTES | YEAR | DENSITY | DECL | FRZ | YR | CONSRV |
| 1 | 000133 | C | SFR LAKE | 100 | | | 120.00 | 257.00 | 1.00 | LT | | 1.00 | 1.00 | 1.00 | 7,600.00 | 7,600.00 | 7,600 | | | | | | | |