

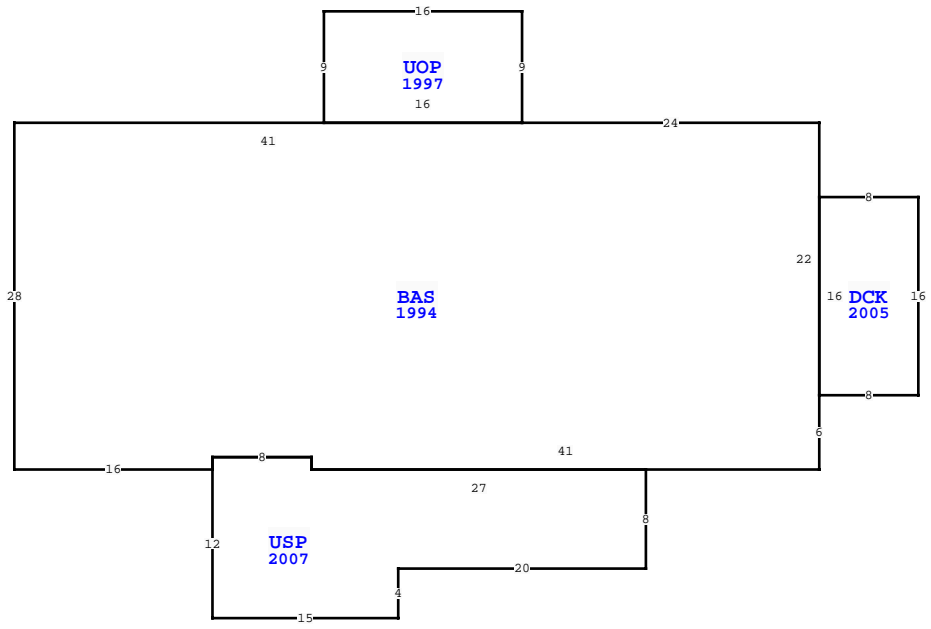

| ELEMENT          |                  | CD          |       | CONSTRUCTION |                      |
|------------------|------------------|-------------|-------|--------------|----------------------|
| Foundation       | 01               | WOOD        | FRAME | 100          |                      |
| Frame            | 02               | WOOD        | FRAME | 100          |                      |
| Exterior Wall    | 30               | VINYL       | 100   |              |                      |
| Roof Structur    | 03               | GABLE/HIP   | 100   |              |                      |
| Roof Cover       | 03               | COMP SHNGL  | 100   |              |                      |
| Interior Wall    | 05               | DRYWALL     | 100   |              |                      |
| Interior Floo    | 10               | LAMINATED   | 80    |              |                      |
| Interior Floo    | 08               | SHT VINYL   | 20    |              |                      |
| Heating Type     | 04               | AIR DUCTED  | 100   |              |                      |
| Air Condition    | 03               | CENTRAL     | 100   |              |                      |
| Bedrooms         |                  | 3           | 100   |              |                      |
| Bathrooms        |                  | 2           | 100   |              |                      |
| Stories          | 1.               | 1.          | 100   |              |                      |
| Class            | 00               | N/A         | 100   |              |                      |
| Units            |                  | 0           | 100   |              |                      |
| Quality          | 08               | FAIR        |       |              |                      |
| DOR CODE         | 0200             | MOBILE HOME |       |              |                      |
| MAP NUM          | 5                | MKT AREA    | 10    |              |                      |
| NEIGHBORHOOD/LOC | 000              | 1.00/       |       |              |                      |
| AREA TYPE        | TOTAL GROSS AREA | PCT OF BASE | YEAR  | TOT ADJ AREA | SUBAREA MARKET VALUE |
| BAS              | 1,812            | 100         | 1994  | 1,812        | 61,713               |
| DCK              | 128              | 10          | 2005  | 13           | 443                  |
| UOP              | 144              | 25          | 1997  | 36           | 1,226                |
| USP              | 348              | 50          | 2007  | 174          | 5,926                |
| TOTALS           | 2,432            |             |       | 2,035        | 69,307               |

| MARKET ADJUSTMENTS                                 |     |           |             |                |                |      |      |      |      |       |        |
|--|-----|-----------|-------------|----------------|----------------|------|------|------|------|-------|--------|
| TYPE   | MDL | EFF. AREA | TOT ADJ PTS | EFF. BASE RATE | REPL. COST NEW | AYB  | EYB  | ECON | FNCT | NORM  | % COND |
| 0200   | 02  | 2,035     | 95.4000     | 66.78          | 135,897        | 1994 | 1994 | 0    | 0    | 49.00 | 51.00  |
| 1 MOBILE HOM 100% - 0 Heated Area: 1812 HX Base Yr |     |           |             |                |                |      |      |      |      |       |        |



| WAKULLA COUNTY PROPERTY  |                   |                |                |
|--|-------------------|----------------|----------------|
| VALUATION SUMMARY  |                   | PAGE 1 of 2    |                |
| VALUATION BY   |                   | STANDARD       |                |
| Tax Group: 3   |                   | Tax Dist:      |                |
| BUILDING MARKET VALUE  |                   | 111,676        |                |
| TOTAL MARKET OB/XF VALUE   |                   | 29,627         |                |
| TOTAL LAND VALUE - MARKET  |                   | 19,125         |                |
| TOTAL MARKET VALUE   |                   | 160,428        |                |
| SOH/AGL Deduction  |                   | 62,853         |                |
| ASSESSED VALUE   |                   | 97,575         |                |
| TOTAL EXEMPTION VALUE  |                   | HX HB 50,000   |                |
| BASE TAXABLE VALUE   |                   | 47,575         |                |
| TOTAL JUST VALUE   |                   | 160,428        |                |
| NCON VALUE   |                   | 519            |                |
| INCOME VALUE   |                   |                |                |
| PREVIOUS YEAR MKT VALUE  |                   | 138,276        |                |
| 5 YR PRCL CH PU XFOBS, CH EYB FOR NEW POOL LINER   |                   |                |                |
| AND 08 @20%,CHG CODE XFOB LN 3, DEM XFOB LN 9  |                   |                |                |
| 5 YR PRCL CK, CHG INT TO 05, CHG FLOR TO 10  |                   |                |                |
| XFOB LN 7-9, CARD 2 @ 99 BOSTIC PELT   |                   |                |                |
| PERMIT NUM   | DESCRIPTION       | AMT            | ISSUED         |
| 2014411  | SCREEN RM/PORCH-C | 0              | 05/22/2014     |
| 2014322  | MOTHER-IN-LAW STE | 0              | 04/22/2014     |
| 2009325  | REROOF (SHINGLES) | 0              | 04/23/2009     |
| 20061947   | PORCH             | 0              | 12/06/2006     |
| 022357   | N/A               | 0              | 06/04/1997     |
| SALES DATA   |                   |                |                |
| OFF RECORD Number  | DATE              | TYPE INST      | Q / V / I / CD |
| 0229/0651  | 3/24/1994         | WD U           | V              |
| GRANTOR: JOSEPH SCHAFFER   |                   | SALE PRICE 100 |                |
| GRANTEE: KAREN GRANGER   |                   |                |                |
| BUILDING NOTES   |                   |                |                |
| BUILDING DIMENSIONS  |                   |                |                |
| BAS=[YR=1994] W24 UOP=[YR=1997] N9 W16 S9 E16\$ W41 S28 E16<br>USP=[YR=2007] S12 E15 N4 E20 N8 W27 N1 W8 S1 \$ N1 E8 S1 E41<br>N6 DCK=[YR=2005] E8 N16 W8 S16\$ N22\$. |                   |                |                |

| EXTRA FEATURES |            |             |         |     |    |       |    |       |                |           |         |             |      |        |                 |        |
|----------------|------------|-------------|---------|-----|----|-------|----|-------|----------------|-----------|---------|-------------|------|--------|-----------------|--------|
| L N            | OB/XF CODE | DESCRIPTION | BLD CAP | L   | W  | UNITS | UT | Adj R | ADJ UNIT PRICE | ORIG COND | YEAR ON | YEAR ACTUAL | Q    | % COND | OB/XF MKT VALUE | NOTES  |
| 1              | 0700       | PORT BLDG   | 0       | 100 | 6  | 8     |    |       | 48.00          | SF        | 8.00    | 2002        | 2002 | 3      | 59              | 227    |
| 2              | 0220       | POOL VINYL  | 0       | 100 | 36 | 17    |    |       | 612.00         | SF        | 60.00   | 2002        | 2002 | 3      | 67              | 24,602 |
| 3              | 0211       | CONCRETE W  | 0       | 100 | 0  | 0     |    |       | 496.00         | SF        | 6.00    | 2002        | 2002 | 3      | 20              | 595    |
| 4              | 0700       | PORT BLDG   | 0       | 100 | 30 | 12    |    |       | 360.00         | SF        | 8.00    | 2005        | 2005 | 3      | 64              | 1,843  |
| 5              | 0700       | PORT BLDG   | 0       | 100 | 16 | 10    |    |       | 160.00         | SF        | 8.00    | 2002        | 2002 | 3      | 59              | 755    |
| 6              | 0940       | OPEN SHED   | 0       | 100 | 24 | 12    |    |       | 288.00         | SF        | 4.00    | 2004        | 2004 | 3      | 23              | 265    |
| 7              | 0055       | PORTABLE C  | 0       | 100 | 20 | 18    |    |       | 360.00         | SF        | 3.00    | 2014        | 2014 | 3      | 62              | 670    |
| 8              | 0055       | PORTABLE C  | 0       | 100 | 20 | 18    |    |       | 360.00         | SF        | 3.00    | 2014        | 2014 | 3      | 62              | 670    |
| 10             | 0055       | PORTABLE C  | 0       | 100 | 20 | 18    |    |       | 360.00         | SF        | 0.00    | 2024        | 2020 |        | 100             | 0      |
| 11             | 0700       | PORT BLDG   | 0       | 100 | 30 | 12    |    |       | 360.00         | SF        | 0.00    | 2024        | 2019 |        | 98              | 0      |
| TOTALS         |            |             |         |     |    |       |    |       |                |           |         | 29,627      |      |        |                 |        |

| LAND DESCRIPTION |          |     |                      |     |     |          |       |       |             |           |     | TOTAL OB/XF |        |         |            |                |            |                             |      |         |      |     |    |        |
|------------------|----------|-----|----------------------|-----|-----|----------|-------|-------|-------------|-----------|-----|-------------|--------|---------|------------|----------------|------------|-----------------------------|------|---------|------|-----|----|--------|
| L N              | USE CODE | CLS | LAND USE DESCRIPTION | CAP | R D | LOC ZONE | FRONT | DEPTH | TOT LND UTS | UNIT TYPE | D T | DPHT FACT   | % COND | TOT ADJ | UNIT PRICE | ADJ UNIT PRICE | LAND VALUE | OTHER ADJUSTMENTS AND NOTES | YEAR | DENSITY | DECL | FRZ | YR | CONSRV |
| 1                | 000201   | C   | MH                   | 100 |     |          | 0.00  | 0.00  | 1.00        | AC        |     | 1.00        | 1.00   | 1.00    | 7,500.00   | 7,500.00       | 7,500      |                             |      |         |      |     |    |        |
| 2                | 000000   | C   | VAC RES              | 100 |     |          | 0.00  | 0.00  | 1.55        | AC        |     | 1.00        | 1.00   | 1.00    | 7,500.00   | 7,500.00       | 11,625     |                             |      |         |      |     |    |        |



| ELEMENT   |                  | BUILDING CHARACTERISTICS |      |              |                      |
|-----------|------------------|--------------------------|------|--------------|----------------------|
| CD        | CONSTRUCTION     |                          |      |              |                      |
| 01        | WOOD FRAME 100   |                          |      |              |                      |
| 02        | WOOD FRAME 100   |                          |      |              |                      |
| 30        | VINYL 100        |                          |      |              |                      |
| 03        | GABLE/HIP 100    |                          |      |              |                      |
| 05        | COMP SHNGL 100   |                          |      |              |                      |
| 03        | DRYWALL 100      |                          |      |              |                      |
| 08        | SHT VINYL 100    |                          |      |              |                      |
| 04        | AIR DUCTED 100   |                          |      |              |                      |
| 03        | CENTRAL 100      |                          |      |              |                      |
| 1.100     |                  |                          |      |              |                      |
| 0.100     |                  |                          |      |              |                      |
| 03        | AVERAGE          |                          |      |              |                      |
| 0200      | MOBILE HOME      |                          |      |              |                      |
| 5         | MKT AREA         | 10                       |      |              |                      |
| 000       |                  | 1.00/                    |      |              |                      |
| AREA TYPE | TOTAL GROSS AREA | PCT OF BASE              | YEAR | TOT ADJ AREA | SUBAREA MARKET VALUE |
| BAS       | 585              | 100                      | 2014 | 585          | 37,273               |
| FOP       | 200              | 35                       | 2014 | 70           | 4,460                |
| UOP       | 40               | 25                       | 2024 | 10           | 637                  |
| TOTALS    | 825              |                          |      | 665          | 42,369               |

| MARKET ADJUSTMENTS                                |     |           |             |                |                |      |      |      |      |       |        |  |  |
|---|-----|-----------|-------------|----------------|----------------|------|------|------|------|-------|--------|--|--|
| TYPE  | MDL | EFF. AREA | TOT ADJ PTS | EFF. BASE RATE | REPL. COST NEW | AYB  | EYB  | ECON | FNCT | NORM  | % COND |  |  |
| 0200  | 02  | 665       | 111.0000    | 77.70          | 51,670         | 2014 | 2014 | 0    | 0    | 18.00 | 82.00  |  |  |
| 2 MOBILE HOM 100% - 0 Heated Area: 585 HX Base Yr |     |           |             |                |                |      |      |      |      |       |        |  |  |

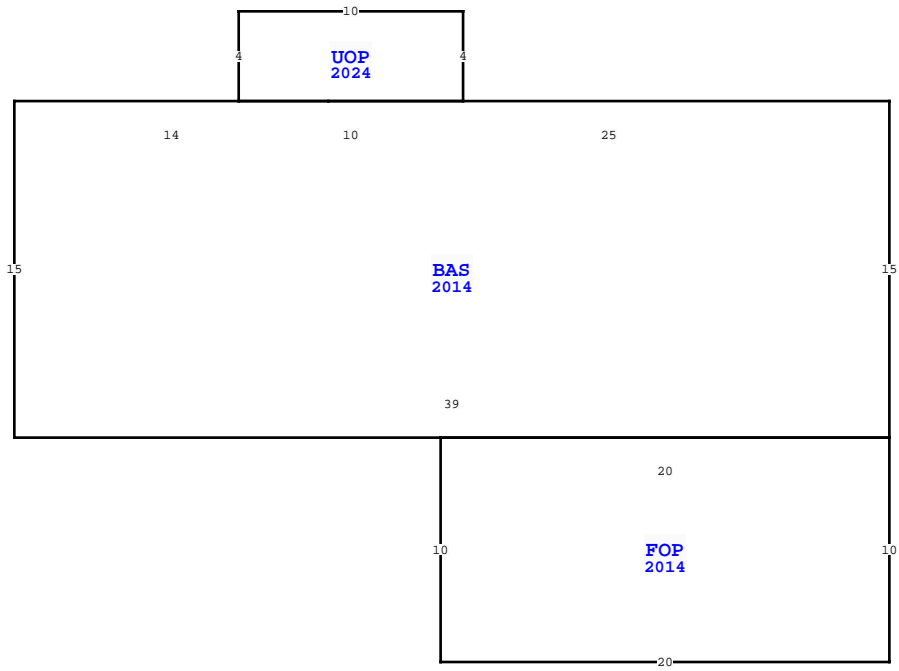

| WAKULLA COUNTY PROPERTY                       |             |           |             |
|---|-------------|-----------|-------------|
| VALUATION SUMMARY                             |             |           | PAGE 2 of 2 |
| VALUATION BY                                  |             | STANDARD  |             |
| Tax Group: 3                                  |             | Tax Dist: |             |
| BUILDING MARKET VALUE                         |             | 111,676   |             |
| TOTAL MARKET OB/XF VALUE                      |             | 29,627    |             |
| TOTAL LAND VALUE - MARKET                     |             | 19,125    |             |
| TOTAL MARKET VALUE                            |             | 160,428   |             |
| SOH/AGL Deduction                             |             | 62,853    |             |
| ASSESSED VALUE                                |             | 97,575    |             |
| TOTAL EXEMPTION VALUE                         |             | 50,000    |             |
| BASE TAXABLE VALUE                            |             | 47,575    |             |
| TOTAL JUST VALUE                              |             | 160,428   |             |
| NCON VALUE                                    |             | 519       |             |
| INCOME VALUE                                  |             |           |             |
| PREVIOUS YEAR MKT VALUE                       |             | 138,276   |             |
| IN-LAW SUITE CARD 2, CHG CODE XFOB LN 3, PU   |             |           |             |
| 5 YR PRCL CH, CHG QUAL CARD 1, PU DCA MOTHER- |             |           |             |
| IN-LAW/GUEST COTTAGE - 99 BOSTIC PELT RD      |             |           |             |
| LN 1, 5 & 6                                   |             |           |             |
| PERMIT NUM                                    | DESCRIPTION | AMT       | ISSUED      |
|   |             |           |             |

| SALES DATA              |           |           |     |     |        |            |
|-------------------------|-----------|-----------|-----|-----|--------|------------|
| OFF RECORD Number       | DATE      | TYPE INST | Q U | V I | RSN CD | SALE PRICE |
| 0229/0651               | 3/24/1994 | WD        | U   | V   |        | 100        |
| GRANTOR: JOSEPH SCHAFER |           |           |     |     |        |            |
| GRANTEE: KAREN GRANGER  |           |           |     |     |        |            |

| EXTRA FEATURES |            |             |         |     |    |       |    |       |                |           |         |             |   |        |                 |       |
|----------------|------------|-------------|---------|-----|----|-------|----|-------|----------------|-----------|---------|-------------|---|--------|-----------------|-------|
| L N            | OB/XF CODE | DESCRIPTION | BLD CAP | L   | W  | UNITS | UT | Adj R | ADJ UNIT PRICE | ORIG COND | YEAR ON | YEAR ACTUAL | Q | % COND | OB/XF MKT VALUE | NOTES |
| 12             | 0055       | PORTABLE C  | 0       | 100 | 20 | 10    |    |       | 0.00           | 100       | 2024    | 2016        |   | 100    | 0               |       |
| 13             | 0700       | PORT BLDG   | 0       | 100 | 6  | 6     |    |       | 0.00           | 100       | 2024    | 2021        |   | 98     | 0               |       |

| BUILDING NOTES |  |  |  |  |  |  |  |  |  |  |  |  |  |
|----------------|--|--|--|--|--|--|--|--|--|--|--|--|--|
|                |  |  |  |  |  |  |  |  |  |  |  |  |  |

| BUILDING DIMENSIONS                           |  |  |  |  |  |  |  |  |  |  |  |  |  |
|---|--|--|--|--|--|--|--|--|--|--|--|--|--|
| BAS=[YR=2014;ORIG=0,0] W25 W14 S15 E39 N15 \$ |  |  |  |  |  |  |  |  |  |  |  |  |  |
| FOP=[YR=2014;ORIG=0,15] W20 S10 E20 N10 \$    |  |  |  |  |  |  |  |  |  |  |  |  |  |
| UOP=[YR=2024;ORIG=-29,0] N4 E10 S4 W10 \$     |  |  |  |  |  |  |  |  |  |  |  |  |  |

| LAND DESCRIPTION |          |     |                      |     |     |          |       |       |             |           |     |          |        | TOTAL OB/XF |            |                |            |                             |      |         |      |     |    |        |
|------------------|----------|-----|----------------------|-----|-----|----------|-------|-------|-------------|-----------|-----|----------|--------|-------------|------------|----------------|------------|-----------------------------|------|---------|------|-----|----|--------|
| L N              | USE CODE | CLS | LAND USE DESCRIPTION | CAP | R D | LOC ZONE | FRONT | DEPTH | TOT LND UTS | UNIT TYPE | D T | DPH FACT | % COND | TOT ADJ     | UNIT PRICE | ADJ UNIT PRICE | LAND VALUE | OTHER ADJUSTMENTS AND NOTES | YEAR | DENSITY | DECL | FRZ | YR | CONSRV |
|                  |          |     |                      |     |     |          |       |       |             |           |     |          |        |             |            |                |            |                             |      |         |      |     |    |        |