

AUDUBON FOREST LOT 30
 OR 290 P 887
 OR 437 P 17 OR 448 P 851

BUTLER JIMMIE R/BUTLER JACQUELINE D
 221 DUNCAN DR
 CRAWFORDVILLE, FL 32327

2024

36-3S-02W-182-01763-030



| ELEMENT | | CD | CONSTRUCTION |
|------------------|------------------|---------------|--------------|
| Foundation | 02 | CONCR | SLAB 100 |
| Frame | 02 | WOOD | FRAME 100 |
| Exterior Wall | 05 | HARDIE BRD | 80 |
| Exterior Wall | 20 | FACE BRICK | 20 |
| Roof Structur | 03 | GABLE/HIP | 100 |
| Roof Cover | 03 | COMP SHNGL | 100 |
| Interior Wall | 05 | DRYWALL | 100 |
| Interior Floo | 14 | CARPET | 70 |
| Interior Floo | 08 | SHT VINYL | 30 |
| Heating Type | 04 | AIR DUCTED | 100 |
| Air Condition | 03 | CENTRAL | 100 |
| Bedrooms | | | 3 100 |
| Bathrooms | | | 2 100 |
| Story Height | | | 0 100 |
| Stories | 1. | | 1. 100 |
| Units | | | 0 100 |
| Quality | 03 | AVERAGE | |
| DOR CODE | 0100 | SINGLE FAMILY | |
| MAP NUM | 5 | MKT AREA | 10 |
| NEIGHBORHOOD/LOC | 182.00 | 1.10/ | |
| AREA TYPE | TOTAL GROSS AREA | PCT OF BASE | YEAR |
| BAS | 1,760 | 100 | 2002 |
| FGR | 440 | 50 | 2002 |
| FOP | 90 | 30 | 2002 |
| FSP | 114 | 55 | 2008 |
| FSP | 150 | 55 | 2008 |
| PTO | 10 | 5 | 2002 |
| PTO | 170 | 5 | 2008 |
| TOTALS | 2,734 | | |

| MARKET ADJUSTMENTS | | | | | | | | | | | |
|--------------------|------------|-----------|-------------|-------------------|----------------|-----|-----|------|------|-----------------|--------|
| TYPE | MDL | EFF. AREA | TOT ADJ PTS | EFF. BASE RATE | REPL. COST NEW | AYB | EYB | ECON | FNCT | NORM | % COND |
| 1 | SINGLE FAM | 100% | - 2006 | Heated Area: 1760 | | | | | | HX Base Yr 2006 | |

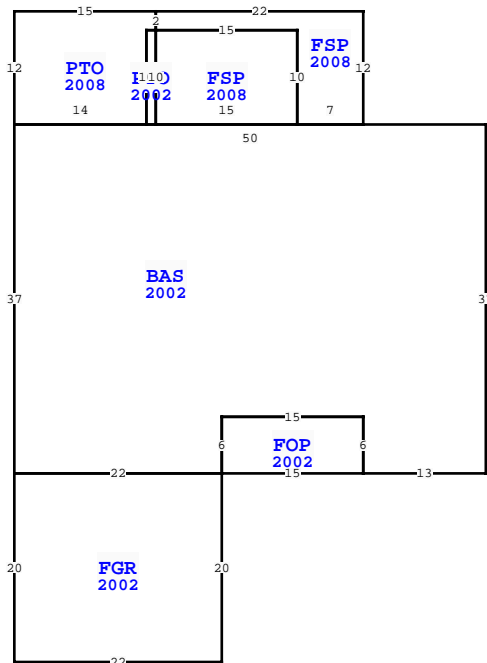

| WAKULLA COUNTY PROPERTY | | PAGE 1 of 1 | 3 |
|---------------------------|--------------|-------------|---|
| VALUATION BY | | STANDARD | |
| Tax Group: 3 | Tax Dist: | | |
| BUILDING MARKET VALUE | 202,208 | | |
| TOTAL MARKET OB/XF VALUE | 5,182 | | |
| TOTAL LAND VALUE - MARKET | 45,000 | | |
| TOTAL MARKET VALUE | 252,390 | | |
| SOH/AGL Deduction | 85,532 | | |
| ASSESSED VALUE | 166,858 | | |
| TOTAL EXEMPTION VALUE | HX HB 50,000 | | |
| BASE TAXABLE VALUE | 116,858 | | |
| TOTAL JUST VALUE | 252,390 | | |
| NCON VALUE | 0 | | |
| INCOME VALUE | 0 | | |
| PREVIOUS YEAR MKT VALUE | 255,825 | | |

| PERMIT NUM | DESCRIPTION | AMT | ISSUED |
|------------|----------------|-----|------------|
| 20000584 | RE-ROOF-CO | 0 | 12/18/2020 |
| 18000605 | HVAC CO | 0 | 06/01/2018 |
| 18000032 | DOORS | 0 | 01/25/2018 |
| 2008109 | ENCLSE SLAB-CO | 0 | 02/11/2008 |
| 28627 | SFD | 0 | 02/07/2002 |

| SALES DATA | | | | | | |
|-------------------|-----------|-----------|-------|-------|--------|------------|
| OFF RECORD Number | DATE | TYPE INST | Q / U | V / I | RSN CD | SALE PRICE |
| 1267/0150 | 5/25/2022 | LD | U | I | 30 | 100 |

| | | | | | |
|------------------------------|-----------------|----|---|---|---------|
| GRANTOR: BUTLER | GRANTEE: BUTLER | | | | |
| GRANTOR: BUTLER JIMMIE, JACQ | GRANTEE: BUTLER | | | | |
| 0604/0519 | 7/12/2005 | WD | Q | I | 197,000 |
| GRANTOR: ROGERS | GRANTEE: BUTLER | | | | |

| BUILDING NOTES | |
|--|--|
| | |
| BUILDING DIMENSIONS | |
| BAS=[YR=2002] W50 PTO=[YR=2008] E14 N10 E1 PTO=[YR=2002] W1 S10 E1 N10\$ FSP=[YR=2008] S10 E15 N10 W15\$ FSP=[YR=2008] E15 S10 E7 N12 W22 S2\$ N2 W15 S12\$ S37 E22 N6 E15 S6 POP=[YR=2002] N6 W15 S6 FGR=[YR=2002] W22 S20 E22 N20\$ E15\$ E13 N37\$. | |

| EXTRA FEATURES | | | | | | | | | | | | | | | | |
|----------------|------------|-------------|---------|----|----|----------|----|----------|----------------|-----------|---------|-------------|---|--------|-----------------|-------|
| L N | OB/XF CODE | DESCRIPTION | BLD CAP | L | W | UNITS | UT | Adj R | ADJ UNIT PRICE | ORIG COND | YEAR ON | YEAR ACTUAL | Q | % COND | OB/XF MKT VALUE | NOTES |
| 1 | 0210 | CONCRETE D | 0 100 | 94 | 14 | 1,316.00 | SF | 6.60 | 6.60 | 100 | 2002 | 2002 | 3 | 20 | 1,737 | |
| 2 | 0211 | CONCRETE W | 0 100 | 52 | 3 | 156.00 | SF | 6.60 | 6.60 | 100 | 2002 | 2002 | 3 | 20 | 206 | |
| 3 | 0955 | PRIVACY FE | 0 100 | 0 | 0 | 261.00 | LF | 16.50 | 16.50 | 100 | 2005 | 2005 | 3 | 20 | 861 | |
| 4 | 0955 | PRIVACY FE | 0 100 | 0 | 0 | 169.00 | LF | 16.50 | 16.50 | 100 | 2009 | 2009 | 3 | 55 | 1,534 | |
| 5 | 0130 | FIRE PLACE | 0 100 | 0 | 0 | 1.00 | UT | 1,430.00 | 1,430.00 | 100 | 2002 | 2002 | 3 | 59 | 844 | |

| LAND DESCRIPTION | | TOTAL OB/XF | | | | | | | | | | | | | | | | | | | | | | |
|------------------|----------|-------------|----------------------|-----|-----|----------|-------|-------|-------------|-----------|-----|-----------|--------|---------|------------|----------------|------------|-----------------------------|------|---------|------|-----|----|--------|
| L N | USE CODE | CLS | LAND USE DESCRIPTION | CAP | R D | LOC ZONE | FRONT | DEPTH | TOT LND UTS | UNIT TYPE | D T | DPTH FACT | % COND | TOT ADJ | UNIT PRICE | ADJ UNIT PRICE | LAND VALUE | OTHER ADJUSTMENTS AND NOTES | YEAR | DENSITY | DECL | FRZ | YR | CONSRV |
| 1 | 000100 | C | SFR | 100 | | | 0.00 | 0.00 | 1.00 | LT | | 1.00 | 1.00 | 1.00 | 45,000.00 | 45,000.00 | 45,000 | | | | | | | |